



43 Langstone Road, Portsmouth

Offers in Region of £330,000

 chinneckshaw



# 43 Langstone Road

## Portsmouth

Beautifully presented, this three bedroom house in Langstone Road is stunning. Within easy walking distance to many local amenities including local shops, schools and parks, it would make a great family home for those of you looking to move into the area. The house itself has recently been comprehensively updated and improved and offers no forward chain so is ready for a new family to move straight into.

The entrance hall feels light and airy and leads through to the Lounge which has a clean neutral décor together with good quality new carpets. The large bay window also dominates this room making it a nice place to relax in front of the TV!

Next you'll find our favourite part of the property...we love it! This open plan Kitchen Dining Room has been designed very well and with the double glazed French Doors open, brings the garden into this lovely part of the house. The kitchen itself is well executed with a range of wall and base cabinets and flows around the room providing plenty of storage and countertop with space for a cooker, fridge-freezer and dishwasher.

On the first floor are three bedrooms off a large landing. Two good sized double rooms and a further large single room to the rear. All the bedrooms are neutrally decorated and ready to move straight into. The bathroom has a modern white suite, with a shower over with contemporary tiling.

Outside is where this house really shines. It has a lovely garden with lawn and shrubs to one side plus a path leading to a double garage. In addition to this large space you have additional off road parking beyond the garage so no more driving around the streets looking for somewhere to park your car!





Ground Floor Building 1

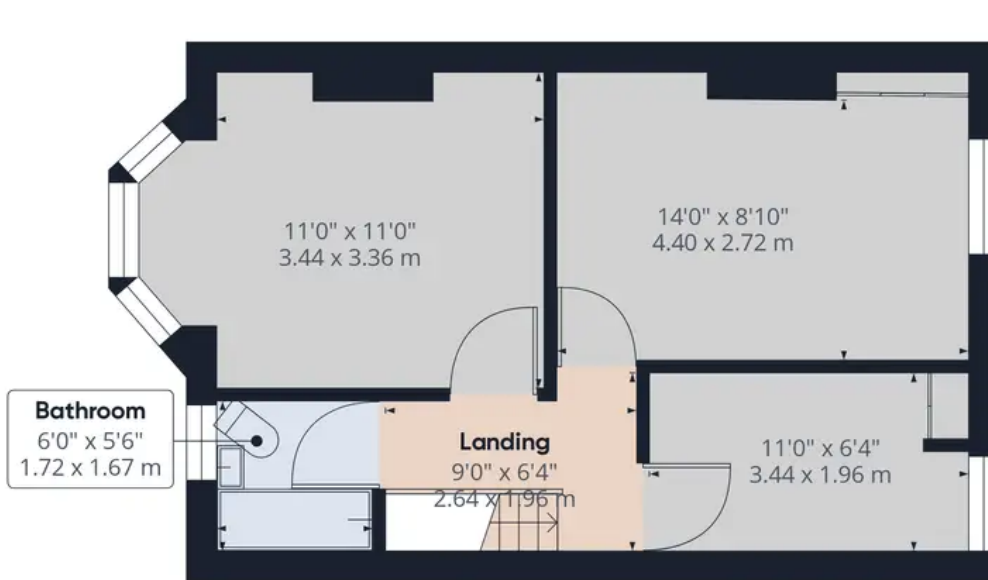

Floor 1 Building 1

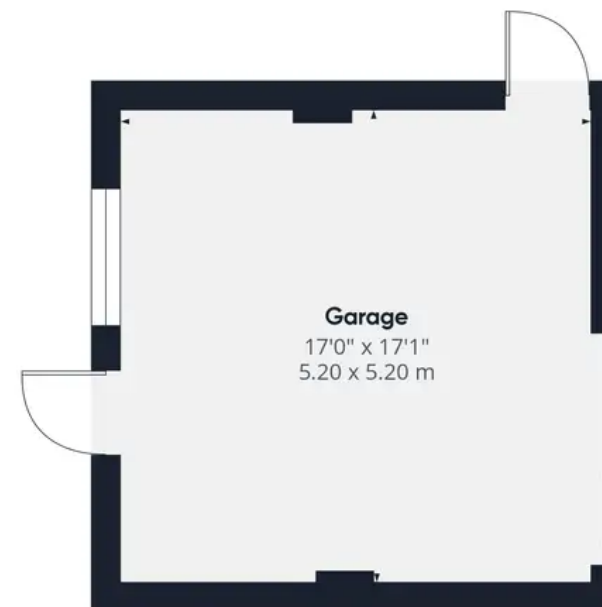

Ground Floor Building 2

Approximate total area<sup>(1)</sup>

1170.47 ft<sup>2</sup>

108.74 m<sup>2</sup>

(1) Excluding balconies and terraces

While every attempt has been made to ensure accuracy, all measurements are approximate, not to scale. This floor plan is for illustrative purposes only.

GIRAFFE360

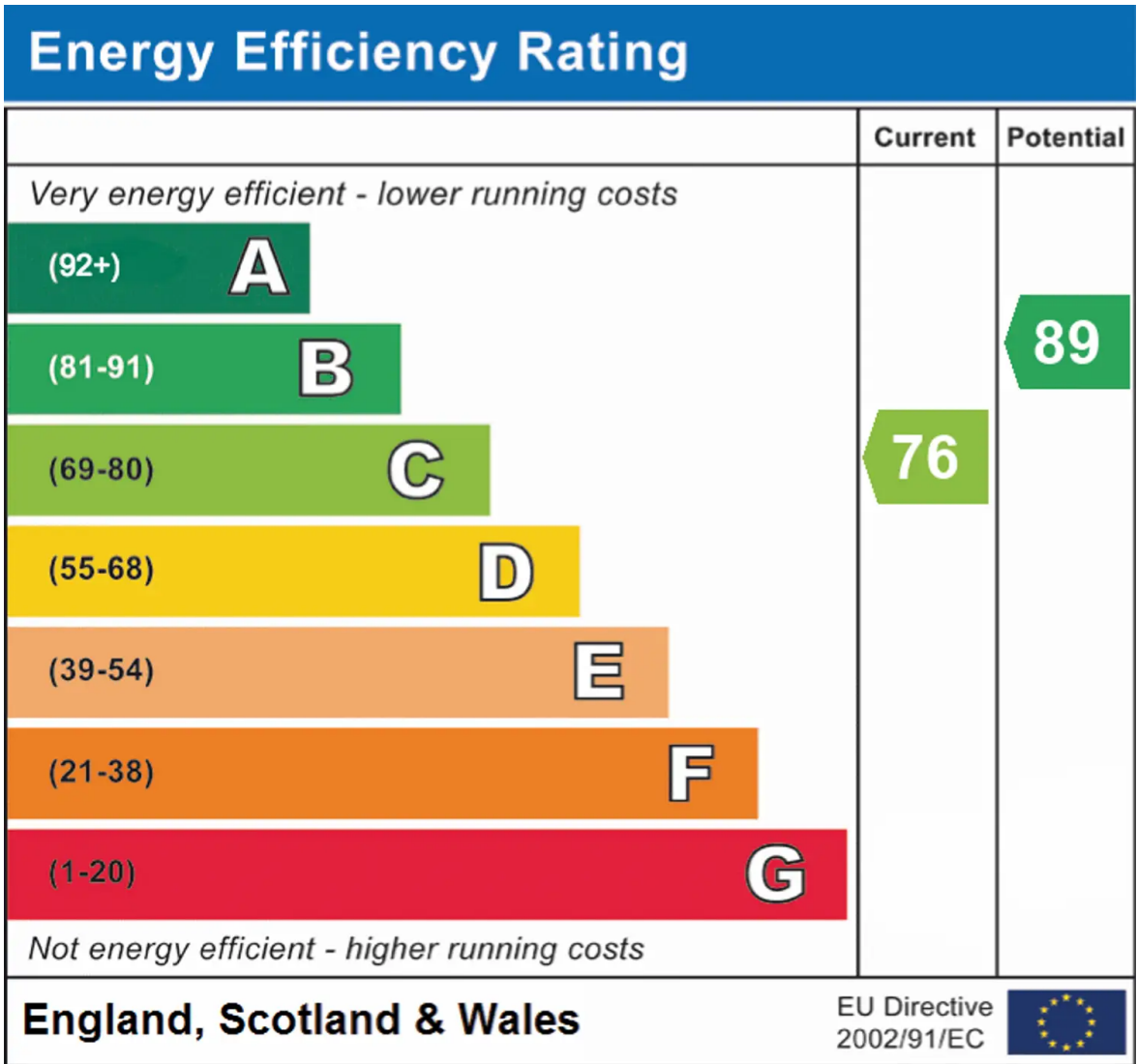

## Chinneck Shaw

Bridge House, Milton Road, Portsmouth – PO3 6AN

023 9282 6731

hello@chinneckshaw.co.uk

www.chinneckshaw.co.uk/

Chinneck Shaw, Bridge House, Milton Road, PO3 6AN Consumer Protection from Unfair Trading Regulations 2008: These details are for guidance only and complete accuracy cannot be guaranteed. If there is any point which is of particular importance, verification should be obtained. The do not constitute a contract or part of a contract. All measurements are approximate. No guarantee can be given with regard to planning permissions or fitness for purpose. No apparatus, equipment, fixture or fitting has been tested. Items shown in the photographs are NOT necessarily included. Interested Parties are advised to check availability and make an appointment to view before travelling to see a property.