

Berry Close, Wallsend, Tyne and Wear

Three bedroom Family House | Garage to Rear | Lounge open to Dining Room

Asking Price: £145,000



Berry Close, Wallsend, Tyne and Wear

DESCRIPTION

We are pleased to offer for sale this three bedroom family home situated on Berry Close in Wallsend.

The accommodation comprises; entrance hall with built in cupboard, lounge with window to front, open to dining room with patio doors to the rear, and kitchen.

To the first floor there is a landing with cupboard, three bedrooms, the main bedroom having built in wardrobes and a modern bathroom/WC.

Externally there is paved garden to the front and a low maintenance garden to the rear along with a single garage. Offered with immediate vacant possession.





Garage
Approx. 12.4 sq. metres (133.3 sq. feet)

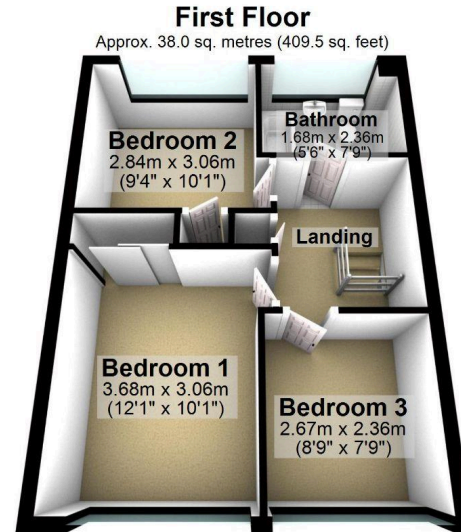
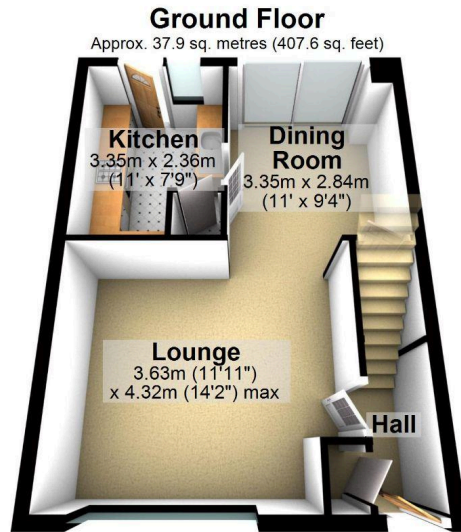

Total area: approx. 88.3 sq. metres (950.4 sq. feet)

Energy Performance Certificate

The energy efficiency rating is a measure of the overall efficacy of a home. The higher the rating the more energy efficient the home is and the lower the fuel bills will be.

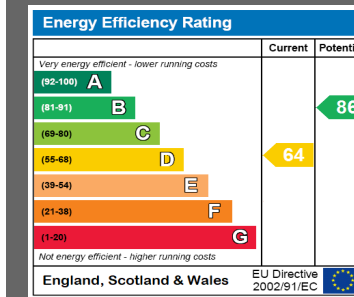

DISCLAIMER

These particulars are intended to give a fair and reliable description of the property but no responsibility for any inaccuracy or error can be accepted and do not constitute an offer or contract. We have not tested any services or appliances (including central heating if fitted) referred to in these particulars and the purchasers are advised to satisfy themselves as to the working order and condition. If a property is unoccupied at any time there may be reconnection charges for any switched off/disconnected or drained services or appliances - All measurements are approximate.

Do you have a property
to sell or let?

If you are thinking of selling your home or just curious to discover the value of your property, We would be pleased to provide free, no obligation sales and marketing advice.



01912576823



Fresh Property Centre, 63 Church Way, North Shields, Tyne and Wear, NE29 0AE



sales@fresh.property



OPENING HOURS

Mon-Fri 9:00-17:30/Sat 10:00-15:00