



mcfarlane  
property.com



2 Bedroom Apartment **£175,000**

6 Apollo House, Fire Fly Avenue, Swindon, SN2 2FT

mcfarlane  
property.com

## 2 Bedroom Apartment Swindon, Rodbourne, SN2

---

- TWO BEDROOMS
  - BEAUTIFULLY PRESENTED
  - ALLOCATED PARKING
  - SECOND FLOOR APARTMENT
  - DESIRABLE LOCATION
  - IDEAL FIRST TIME BUY OR INVESTMENT OPPORTUNITY
- 



A beautifully maintained second floor apartment in this desirable location close to local amenities and local transport links. Accommodation briefly comprises two double bedrooms (en-suite to master), fitted kitchen, sitting room with Juliette balcony, family bathroom and allocated parking. Offered in excellent order throughout this would make an ideal first time or investment purchase.



## Property description

McFarlane Sales & Lettings are pleased to welcome to market this beautifully maintained second floor apartment. Situated in a highly desirable location, this property offers convenient access to local amenities and excellent transport links. The accommodation includes two spacious double bedrooms, with an en-suite to the master bedroom, a modern fitted kitchen, a comfortable sitting room featuring a Juliette balcony, and a family bathroom. Additionally, the property comes with allocated parking. Presented in excellent condition throughout, this apartment is perfect for first-time buyers or as an investment opportunity.



## Second Floor

Approx. 58.3 sq. metres (627.4 sq. feet)

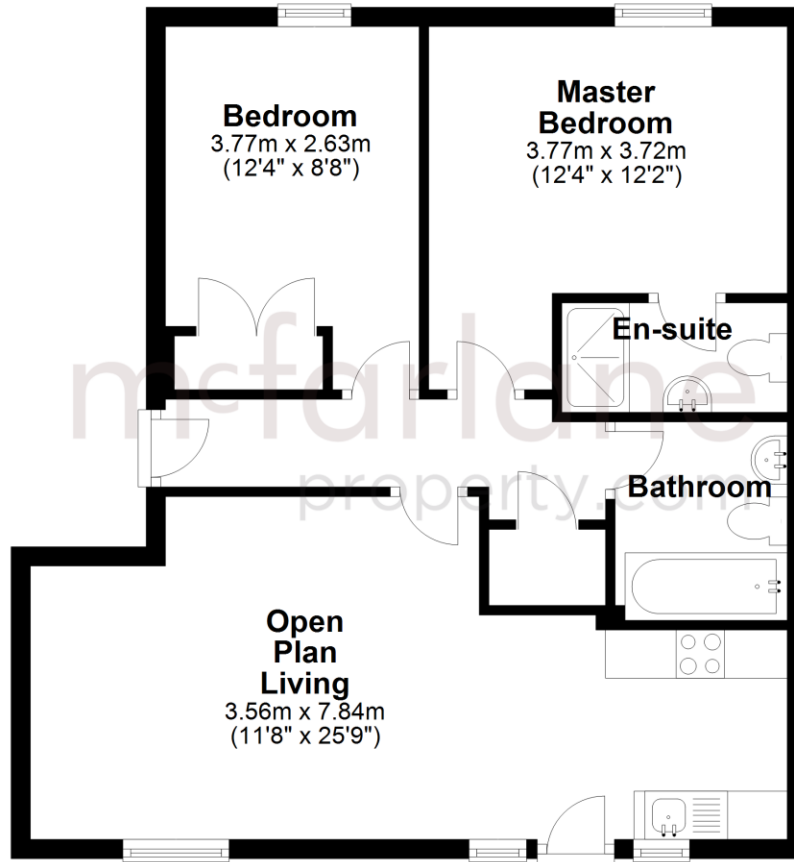

Total area: approx. 58.3 sq. metres (627.4 sq. feet)

We   
where you  
**LIVE**

Our team are friendly, experienced and are all local. They know it better than they do their own living rooms and can help you find what you're looking for because **we love where we live.**

We would be delighted to show you around this property.

**Because every home  
needs a personal touch.**

**If you would like to view this  
property then please get in touch.**

 01793 296880

 [oldtown@mcfarlaneproperty.com](mailto:oldtown@mcfarlaneproperty.com)

[mcfarlaneproperty.com](http://mcfarlaneproperty.com)

**mcfarlane**  
property.com

### **Cricklade.**

102 High Street  
Cricklade SN6 6AA

 01793 751044

### **Marlborough.**

106 High Street  
Marlborough SN8 1LT

 01672 514380

### **Old Town.**

28-30 Wood Street  
Swindon SN1 4AB

 01793 296880

### **Swindon.**

The Village Centre,  
Redhouse SN25 2FW

 01793 296600

Agents Note: Whilst every care has been taken to prepare these sales particulars, they are for guidance purposes only. All measurements are approximate are for general guidance purposes only and whilst every care has been taken to ensure their accuracy, they should not be relied upon and potential buyers are advised to recheck the measurements