





Seymours



Birchett Road
Farnborough, GU14 8RQ
£450,000

Arrange a viewing: 01276 534100

Property Details

-  3 bedrooms
-  1 baths
-  EPC Rating TBC
-  1306 sqft
-  Farnborough Main Station (1.1 miles)

- Semi Detached
- Driveway parking
- Cloakroom
- Modern Shower room
- Large mature enclosed rear garden
- Convenient for local shops and amenities
- Large workshop
- Council tax band C
- Closed chain above

This deceptively spacious three bedroom semi-detached family home offers a large living room, modern kitchen, downstairs cloakroom as well as a modern shower room. To the front of the property is a block paved driveway with parking for two cars and to the rear is a large mature garden. At the end of the garden is a large workshop which offers great space. The property is located down a quite close and is conveniently located for local shops & amenities.

[01276 534100](tel:01276534100) / james@seymours-blackwater.co.uk



Birchett Road

Approximate Gross Internal Area = 121.4 sq m / 1306 sq ft
(Including Storage)

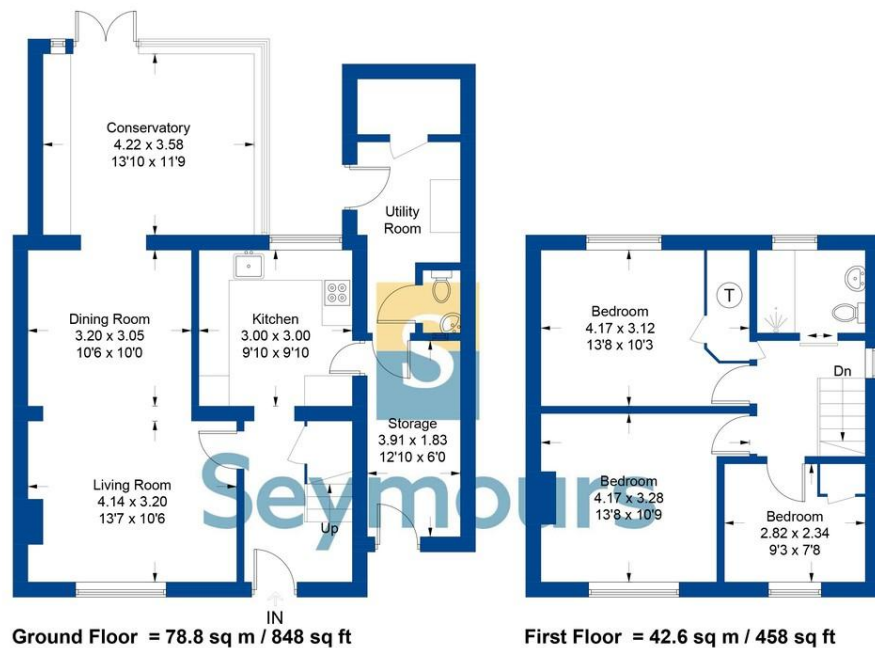

Illustration for identification purposes only, measurements are approximate, not to scale. FloorplansUsketch.com © 2024 (ID1105491)