



29 Sisley Avenue, Stapleford

Guide Price £240,000

 HORTONS

29 Sisley Avenue

Stapleford, Nottingham

Guide price £240,000 to £250,000. Hortons are delighted to bring to the market this extended two bedroom semi-detached bungalow located in the highly sought-after area of Stapleford presents a opportunity for those seeking a stylish and versatile living space paired with convenient access to amenities and commuter links. Set back from the road, the property boasts ample parking on the driveway for up to three cars, complemented by beautifully landscaped front and rear gardens. Charming and well-maintained, the home features a luxury four-piece bathroom suite and an extended layout that offers flexible living arrangements. The spacious dining kitchen overlooks the front garden, while two attic spaces hold great potential for conversion, subject to the necessary planning permissions. With great transport connections including bus links and walking distance to the town and tram station, this property offers a harmonious blend of comfort and convenience for its new owners.

Step outside to discover the delightful outdoor spaces this property has to offer. A charming patio area beckons for outdoor dining and gatherings, while a tiered garden with a step up to a grassed space leads to a further laid-to-bark area, all enclosed by secure fencing. This serene outdoor haven offers the perfect balance of practicality and tranquillity, ensuring that every corner of the property is utilised for both functional and leisurely purposes.

Location

Situated in this highly regarded residential suburb,



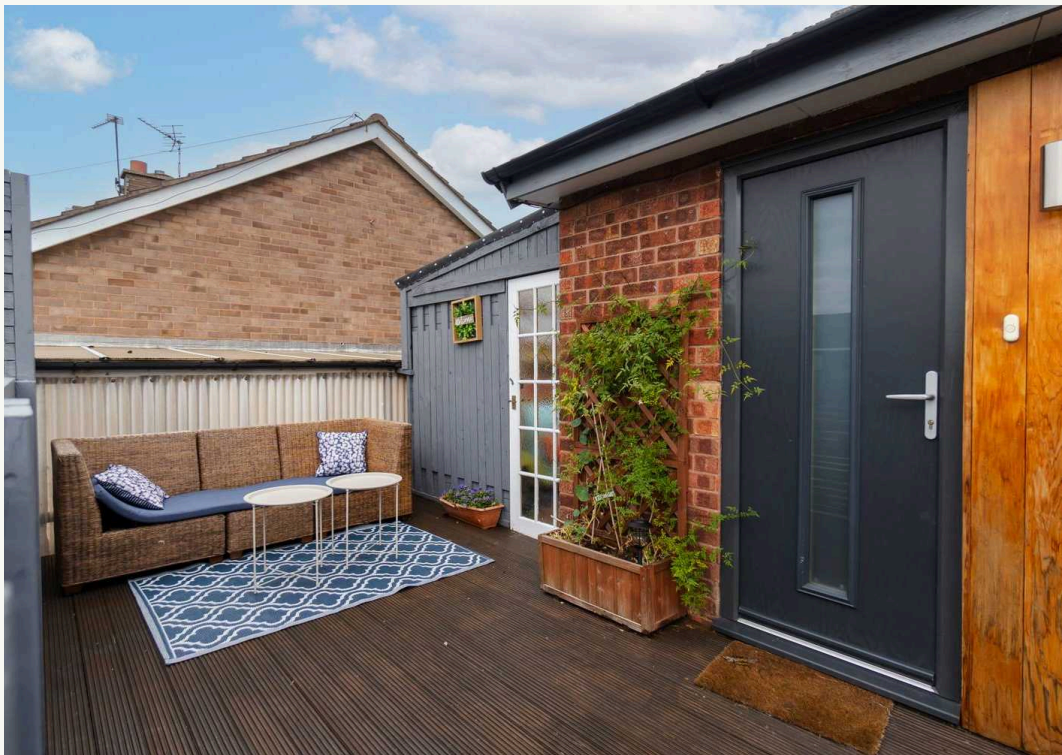







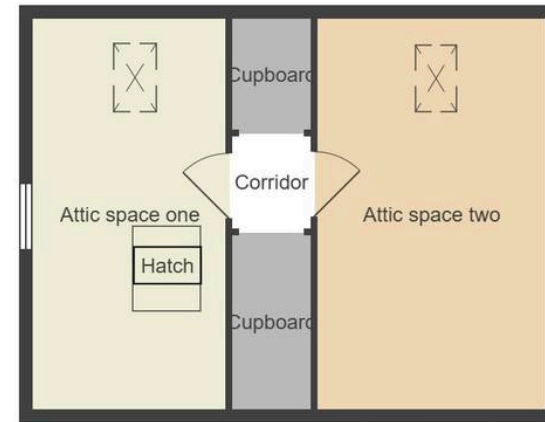

All measurements are approximate and for display purposes only.



Nicole Beales - Hortons

07561 100839 · nicole@hortons.co · hortons.co/partners/nicole-beales/