

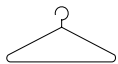

2 Floors



3 Bedrooms



Dressing Area



3 En suites

## WIXHAM THREE BEDROOM HOME

A three bedroom detached home with spacious lounge featuring a bay window and fantastic open plan kitchen / dining and family area with French doors leading to the rear garden. Upstairs, there are three generous double bedrooms, each of them with an en suite shower room and the master benefitting from a dressing area with fitted wardrobes included.

# WIXHAM THREE BEDROOM HOME

## ◇ DIMENSIONS

### First Floor:

#### Bedroom 1

4.02m x 2.85m  
13'2" x 9'4"

#### En Suite

#### Dressing Area

3.10m x 1.87m  
10'2" x 6'2"

#### Bedroom 2

2.92m x 3.68m  
9'7" x 12'1"

#### En Suite

#### Bedroom 3

2.74m x 3.44m  
9'0" x 11'4"

#### En Suite

(W) Wardrobes

### Ground Floor:

#### Lounge

3.95m x 4.15m  
12'11" x 13'7"

#### Kitchen / Dining / Family

7.20m x 4.25m  
23'8" x 13'11"

(S) Storage

(U) Utility

(C) Cloaks

◀ ▶ Measurement Points

△ External Access

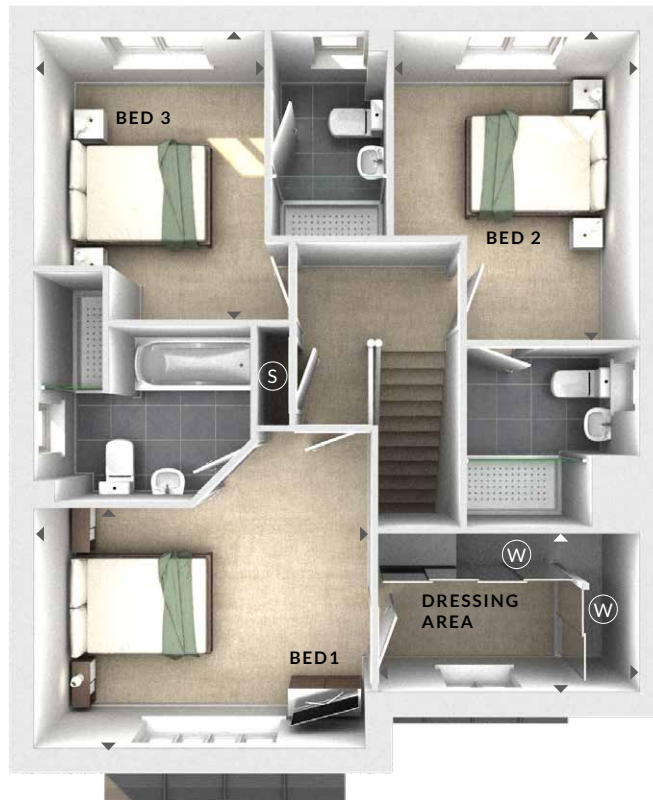

First Floor



Ground Floor

