





Hiltons Estates are pleased to present this modern and luxurious two bedroom apartment located in the heart of Hounslow. The apartment benefits from spacious open-plan lounge and designer kitchen with integrated cooker, fridge freezer, washing machine and dishwasher. This delightful apartment further benefits from two double rooms ideal for any homebuyer looking for a luxury property within a central location of Hounslow. Located within a sought-after area of Hounslow, it comes within walking distance to Mainline Station, shops, banks, amenities and public transport. Good transport links to Central London, Heathrow, M4, M25 and M40. Opportunity not to be missed.

Allocated parking

Within Walking distance of local amenities

Close to transport links

Two double rooms

Chain Free



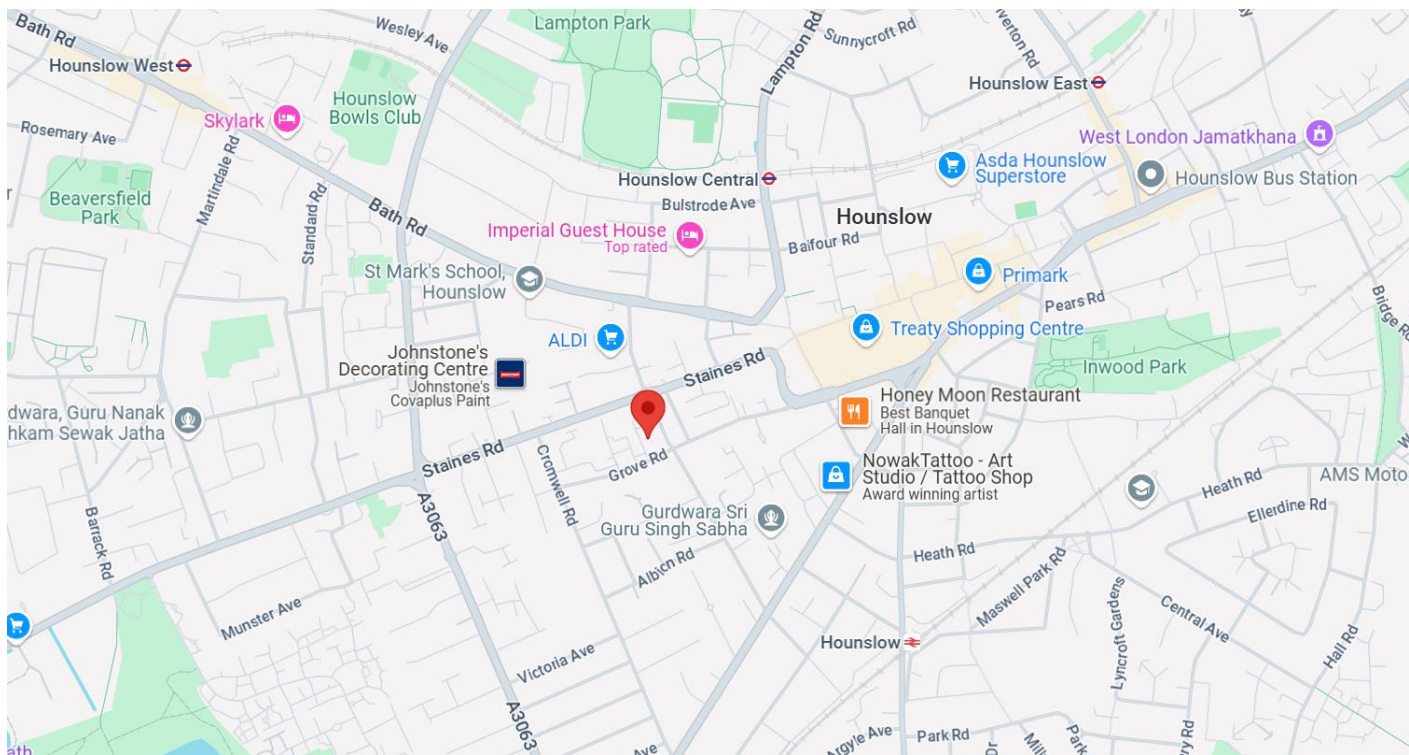

GROUND FLOOR
600 sq.ft. (55.8 sq.m.) approx.

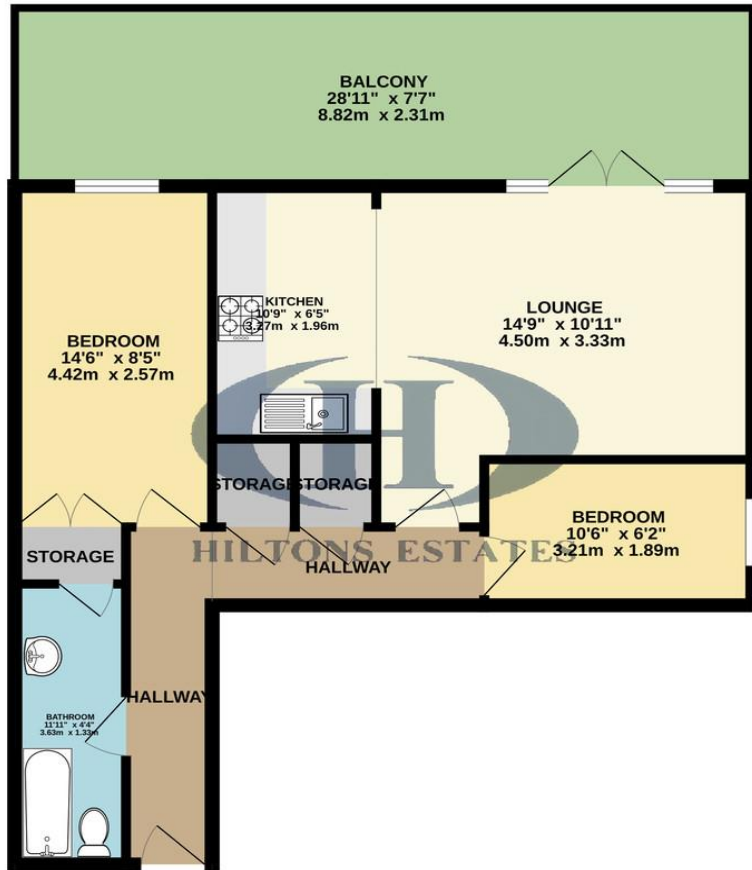

TOTAL FLOOR AREA : 600 sq.ft. (55.8 sq.m.) approx.

Whilst every attempt has been made to ensure the accuracy of the floorplan contained here, measurements of doors, windows, rooms and any other items are approximate and no responsibility is taken for any error, omission or mis-statement. This plan is for illustrative purposes only and should be used as such by any prospective purchaser. The services, systems and appliances shown have not been tested and no guarantee as to their operability or efficiency can be given.
Made with Metropix ©2024



Score	Energy rating	Current	Potential
92+	A		
81-91	B		
69-80	C	80 C	80 C
55-68	D		
39-54	E		
21-38	F		
1-20	G		

Hiltons Estates, 137 Western Road
Southall, UB2 5HN

www.hiltons-estates.com
email: harvin@hiltons-estates.com
0208 867 9555 / 07961 527301

Agents Note: Whilst every care has been taken to prepare these sales particulars, they are for guidance purposes only. All measurements are approximate are for general guidance purposes only and whilst every care has been taken to ensure their accuracy, they should not be relied upon and potential buyers are advised to recheck the measurements.