



17 Sagar Street, Ecclestone

PR7 5TA

£1,100 pcm





Delightful three bedroom detached property situated in the sought after village of Eccleston and close to all local amenities including shops and schools. Available to let immediately.

The property sits back from the road with a driveway for a number of cars and has access to the garage, which has power and light. Step into the vestibule with downstairs wc and from there into the spacious dining room with stairs leading to the first floor. Leading off is the lounge with feature fireplace and double doors leading into the bright conservatory. The kitchen comprises a range of wall and base units with contrasting work surfaces and includes gas hob and electric oven. There is a good size kitchen pantry which includes plumbing and space for a washing machine and a dryer.



To the first floor are two double bedrooms, the master with built in wardrobes and en-suite with shower enclosure, and the third bedroom which is a comfortable single. The family bathroom has a three piece suite with wash basin, wc, and panelled bath. Externally, the garden is low maintenance with patio area and planted borders with mature shrubs.

Fully double glazed with gas central heating, in the catchment area for outstanding schools, this really is a wonderful place to call home.

- Detached property
- Three bedrooms
- Garage

The property is available now and requires a deposit of £1269, including holding deposit of £250. The Zero Deposit Scheme is also available.

Council Tax Band: D

EPC Rating: D

- Detached property
- Three bedrooms
- Garage
- Spacious off road parking
- Available now
- Zero Deposit Scheme available



HOME  TRUTHS

Eccleston Branch
265 The Green, Eccleston, PR7 5TF
01257 451673

Coppull Branch
244 Spendmore Lane, Coppull, PR7 5DE
01257 794588

www.hometruthslancs.co.uk
office@hometruthslancs.co.uk



Ground Floor

Approx. 65.5 sq. metres (705.1 sq. feet)

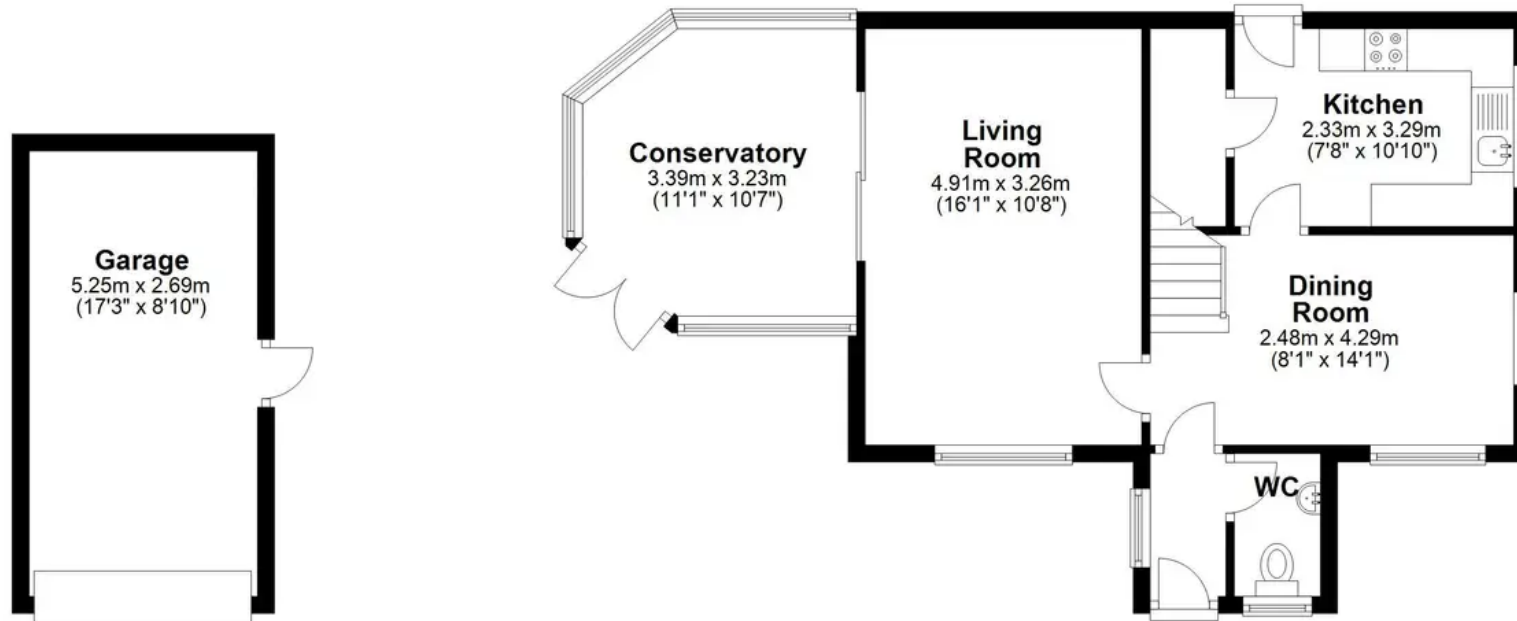

First Floor

Approx. 37.5 sq. metres (403.9 sq. feet)

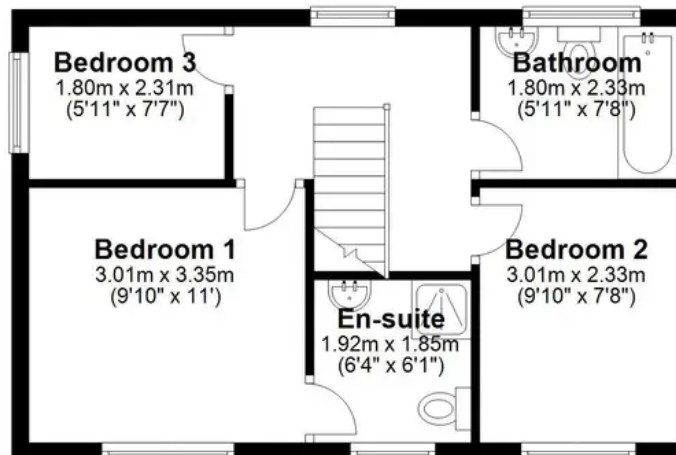

Total area: approx. 103.0 sq. metres (1108.9 sq. feet)

THIS FLOOR PLAN IS FOR ILLUSTRATION ONLY AND IS NOT A SCALE DRAWING
Plan produced using PlanUp.