



HARRISON
Sales &
Lettings
HARDEN

Bowling Green Court Hospital Road, Moreton-In-Marsh

Guide Price **£240,000**

Moreton-In-Marsh



A modernised, two bedroom first floor apartment located within a development for the over 55's and just a short walk from the town's amenities and enjoying countryside views to the rear.

The current owners have renovated the property to create modern and light living accommodation, with a spacious hallway, storage cupboard and airing cupboard, sitting room with double doors opening to a small balcony which enjoys stunning countryside views towards Batsford and the well maintained communal gardens below. There is a modern kitchen with built in electric cooker and hob, main bedroom with a built in wardrobe, second double bedroom currently used as a study/hobby room, modern fitted shower room with built in storage and a heated towel rail. The property is accessed via a communal entrance which has a recently upgraded stairlift to the first floor. Outside you have use of the communal gardens and off road parking. The property has electric heating.

Tenure: LEASEHOLD with 965 Years Remaining - We believe the lease is 999 years starting from May 1988.

Maintenance Charge: The current maintenance charge is approx. £307 pcm which briefly includes: an onsite resident manager during week days, maintenance of all communal grounds, building insurance, a guest suite available to book for friends and relatives for a small fee and a contribution to the sinking fund.

Moreton in Marsh is a north Cotswold town offering a railway station, library, post office, North Cotswold Hospital, sports facilities and swimming pool open to the public at the renowned Fire College, pubs, hotels and many specialist shops. Moreton in Marsh is also host of the largest street market in the Cotswolds which runs every Tuesday, is a stones throw away from Batsford Arboretum and Gardens and the Cotswold Falconry Centre, with the award winning Daylesford Organic Farm and Stores just around the corner. Moreton In Marsh also has its train station, with a direct line running regularly between Worcester and London Paddington.





20 Bowling Green Court, Moreton, GL56 0BX
Main House Approx. Gross Internal Area:- 65.10 sq.m. 701 sq.ft.
Total Approx. Gross Area:- 65.10 sq.m. 701 sq.ft.

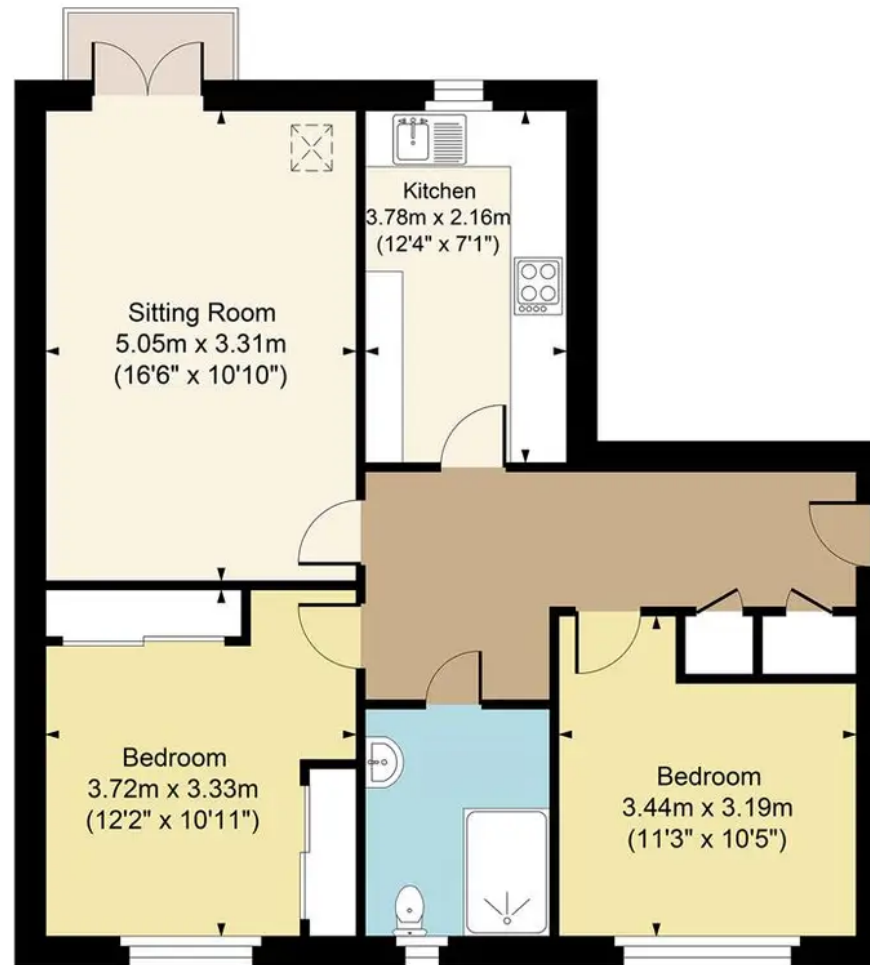

FOR ILLUSTRATIVE PURPOSES ONLY-NOT TO SCALE
The position & size of doors, windows, appliances and other features are approximate only.
□ X □ Denotes restricted head height
www.dmlphotography.co.uk

Bowling Green Court Hospital Road, Moreton-In-Marsh

Guide Price **£240,000**

Moreton-In-Marsh