





Stunning 2 Bedroom Ground Floor Apartment!

Niall McCabe & RE/MAX Property are overjoyed to introduce to the market this magnificent & well-appointed 2-bedroom, 1-bathroom ground floor apartment. The property boasts stunning interiors, spacious room sizes & is presented to the market in true 'Turn-Key' condition. Enjoying gorgeous finishes, sumptuous carpeting and a thoughtful layout you certainly feel like you've been welcomed home.

Wester Inch Village is a modern and newly developed area of Bathgate with its own primary school while also benefiting from all the amenities that the town of Bathgate has to offer. With a full range of shops, banks, financial service, doctor surgery, nursery / primary and secondary schools, bars, restaurants, swimming pool, leisure centre, bowling green, golf course and country parks. The area further benefits from being within a close proximity to M8 and Bathgate train station which has a timely and frequent service direct to Edinburgh and Glasgow making this an ideal location for commuting.

Council Tax Band C

Freehold Tenure

Factor Fee – £111 per month

These particulars are prepared on the basis of information provided by our clients. Every effort has been made to ensure that the information contained within the Schedule of Particulars is accurate. Nevertheless, the internal photographs contained within this Schedule/ Website may have been taken using a wide-angle lens. All sizes are recorded by electronic tape measurement to give an indicative, approximate size only. Floor plans are demonstrative only and not scale accurate. Moveable items or electric goods illustrated are not included within the sale unless specifically mentioned in writing. The photographs are not intended to accurately depict the extent of the property. We have not tested any service or appliance. This schedule is not intended to and does not form any contract. It is imperative that, where not already fitted, suitable smoke alarms are installed for the safety for the occupants of the property. These must be regularly tested and checked. Please note all the surveyors are independent of RE/MAX Property. If you have any doubt or concerns regarding any aspect of the condition of the property you are buying, please instruct your own independent specialist or surveyor to confirm the condition of the property – no warranty is given or implied

Entrance Hallway

Decorated in cool, calming tones, the entrance hallway perfectly sets the tone for the interiors to follow. There is beautiful flooring and modern doors, leading to all accommodation.

Lounge

13' 3" x 11' 6" (4.05m x 3.51m)

Characterised by a wonderful feature window, the Lounge/Diner is the ideal spot to unwind & entertain after a long day. The stylish decor & plush carpeting continues through into here and offers ample space for various furniture formations.

Kitchen

10' 0" x 8' 9" (3.04m x 2.66m)

This modern kitchen is a chef's dream! There are ample base & wall mounted units complete with integrated appliances, contrasting worktop & splashback design, the room also enjoys space for dining furniture and a rear facing window.

Bedroom 1

11' 6" x 8' 6" (3.51m x 2.59m)

The master bedroom is light, bright & airy. It has been finished in a contemporary palette, with contrasting flooring and boasts a front facing window.

Bedroom 2

10' 6" x 9' 0" (3.21m x 2.74m)

A further double bedroom located to the rear of the property with ample fitted storage, lovely laminate flooring & a fresh finish.

Family Bathroom

6' 7" x 6' 0" (2.00m x 1.84m)

The 3-piece family bathroom has been beautifully finished and offers a striking tile design, bathtub with overhead shower, W.C and wash hand basin.



GROUND FLOOR

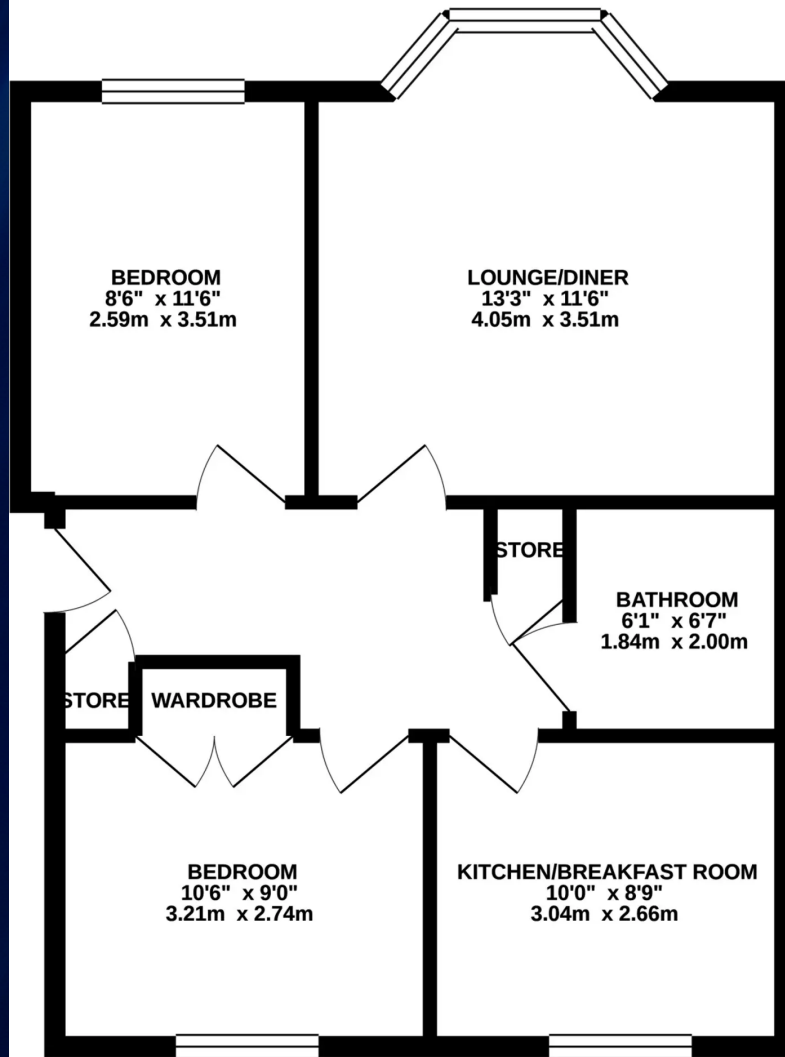

Whilst every attempt has been made to ensure the accuracy of the floorplan contained here, measurements of doors, windows, rooms and any other items are approximate and no responsibility is taken for any error, omission or mis-statement. This plan is for illustrative purposes only and should be used as such by any prospective purchaser. The services, systems and appliances shown have not been tested and no guarantee as to their operability or efficiency can be given.

Made with Metropix ©2021



RE/MAX Property

Remax Property, Remax House - EH54 6TS

07940 230896 • nmccabe@remax-scotland.net • www.remax-livingston.net



Sales particulars aim for accuracy but rely on seller-provided info. Measurements may have minor fluctuations. Items not tested, no warranty on condition. Photos may use wide angle lens. Floorplans are approximate, not to scale. Not a contractual document; buyers should conduct own inquiries.