



Block A Wilburn Basin

Salford



£260,000

Wilburn Basin

Salford

This contemporary, two bedroom apartment is located within walking distance of Manchester City Centre, on the popular Wilburn Basin development. Set within thoughtfully designed communal spaces, with communal gardens flowing round the bank of the River Irwell.

Council Tax band: C

Tenure: Leasehold

- Contemporary Two Bedroom Apartment with Breathtaking Views Over the City Skyline
- Located Within Walking Distance of Manchester City Centre, Castlefield and Spinningfields
- Benefits from a Communal Lift, Secure Intercom/Fob Entry and a Concierge
- Large Open Plan Living, Dining and Kitchen Area, with Patio Doors Leading to a Balcony
- Two Double Bedrooms, with a Sleek Ensuite Shower Room to the Main Bedroom
- Stylish Three-Piece Bathroom
- Added Benefit of a Utility Cupboard
- Within Easy Access of a Fine Array of Bars, Shops and Restaurants
- Close to Transport Links with Access Throughout Manchester
- Viewing is Highly Recommended!



HILLS



Entrance Hallway

Featuring ceiling spotlights. Fitted with laminate flooring.

Open plan living room/kitchen/diner

18' 7" x 12' 10" (5.66m x 3.92m)

Featuring ceiling spotlights, fitted units including integrated hob, oven, fridge freezer, dishwasher. Complete with patio doors. Fitted with laminate flooring.

Bedroom One

13' 3" x 11' 2" (4.05m x 3.40m)

Featuring ceiling light point, double glazed window, electric radiator. Fitted with carpet flooring.

Ensuite

6' 9" x 6' 1" (2.07m x 1.86m)

Featuring two piece suite including w/c, shower. Complete with an electric towel rail. Fitted with tiled walls and tiled flooring.

Bedroom Two

11' 1" x 9' 2" (3.37m x 2.79m)

Featuring ceiling light point, double glazed window, electric radiator. Fitted with carpet flooring.

Bathroom

6' 9" x 6' 3" (2.07m x 1.91m)

Featuring three piece suite including, w/c, hand wash basin, bath with a shower overhead. Complete with an electric hand towel rail. Fitted with tiled walls and tiled flooring.

Utility Cupboard

4' 7" x 4' 4" (1.39m x 1.32m)

Featuring ceiling light point. Space for washer. Fitted with laminate flooring.

External

To the front of the property is a concierge, mail boxes, communal lift, secured fob, intercom access. To the rear and front of the property is communal gardens.





HILLS



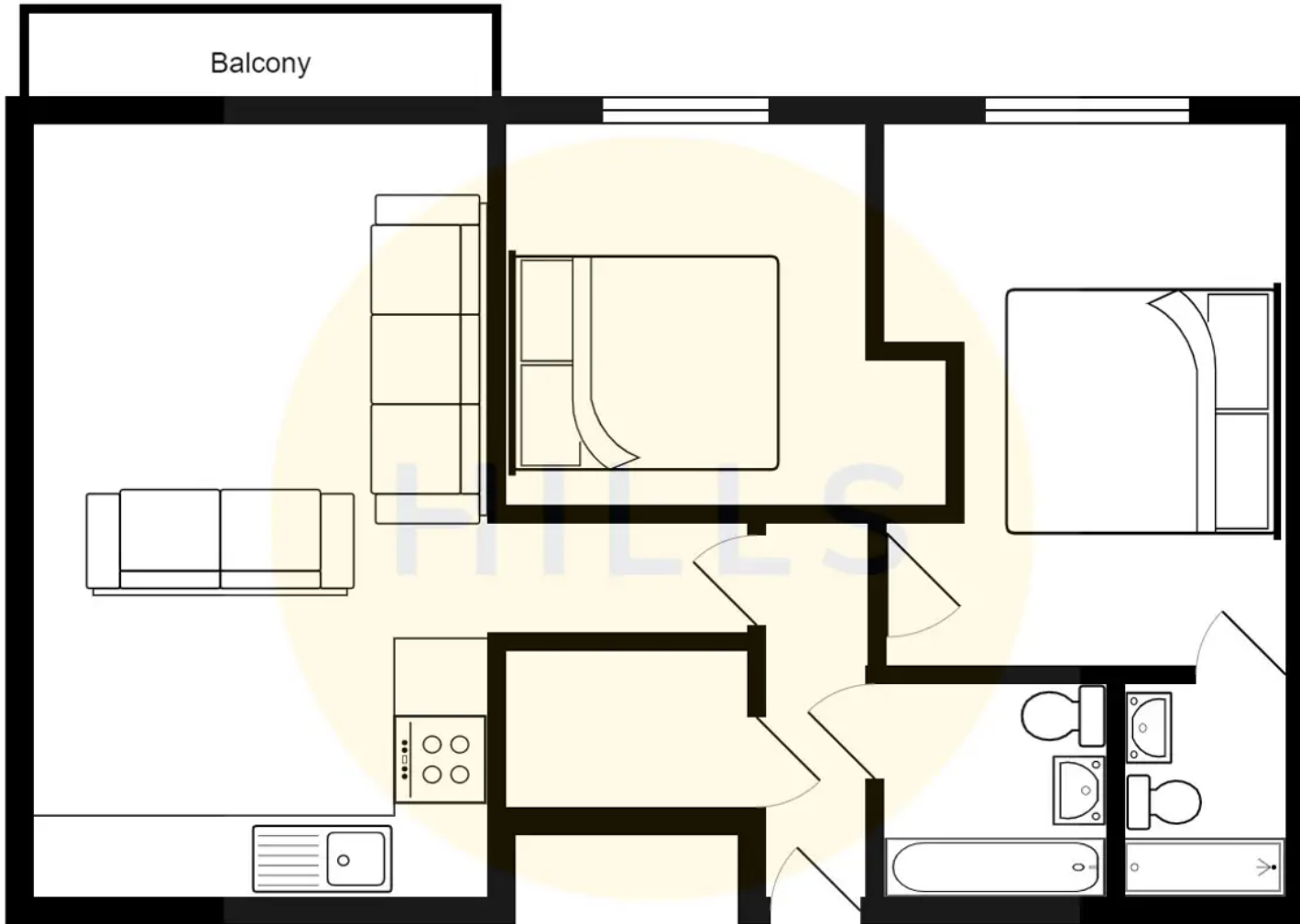



Hills | Salfords Estate Agent

Hills Residential, Sentinel House Albert Street – M30 0SS

0161 707 4900

sales@hills.agency

www.hills.agency/



THE PROPERTY MISDESCRIPTIONS ACT 1991 The Agent has not tested any apparatus, equipment, fixtures and fittings or services and so cannot verify that they are in working order or fit for the purpose. A Buyer is advised to obtain verification from their Solicitor or Surveyor. References to the Tenure of a Property are based on information supplied by the Seller. The Agent has not had sight of the title documents. A Buyer is advised to obtain verification from their Solicitor. You are advised to check the availability of this property before travelling any distance to view. Every effort and precaution has been made to ensure these particulars are correct and not misleading but their accuracy is not guaranteed nor do they form part of any contract. If there is any point which is of particular importance to you, please contact us and we will provide any information you require. This is advisable, particularly if you intend to travel some distance to view the property. The mention of any appliances and services within these details does not imply that they are in full and efficient working order. These particulars are in draft form awaiting Vendors confirmation of their accuracy. These details must therefore be taken as a guide only.