



# Tatham

**£335,000**

Beethams, Rantreefold Road, Tatham, LA2 8PS

Beethams presents a rare opportunity to purchase a traditional stone built farmhouse within the rolling countryside, now in need of updating to truly turn this house into a wonderful family home. Enjoying off road parking and a generous garden, this home boasts uninterrupted views over the valley to the Bowland Fells beyond.

With scope for reconfigurations and modernisations, the ground floor comprises a living room, kitchen, bathroom, pantry and workshop, whilst the first floor presents three good sized bedrooms. For those seeking a renovation project, this is certainly not one to miss!

## Quick Overview

- Traditional Semi-Detached Farmhouse
- Three Bedrooms & One Bathroom
- Idyllic Rural Location
- Great Renovation Project
- Off Street Parking
- Wonderful Views over the Bowland Fells
- Attached Workshop
- Generous Rear Garden
- Within the Forest of Bowland Natural Landscape
- Broadband Available



3



1



1



G



Broadband Available



Off Road Parking

Property Reference: KL3540





Living Room



Living Room



Kitchen



Bathroom

### Property Overview:

Welcome to Beethams, a charming traditional farmhouse with great potential for those seeking a country home, now ready for the new purchaser to make their own.

Step through the door into the porch, perfect for kicking off muddy boots and hanging coats. Firstly, you are lead into the living room; a generous space with dual aspect windows and fireplace with stairs leading to the first floor and access into the workshop. With great scope to transform into a garage (subject to consents), the workshop offers additional storage with light and power.

Follow into the kitchen, comprising base units and worktop, a sink with drainer and Rayburn oven, also offering great scope to transform into a generous kitchen dining room. Leading to the inner hall which has a door leading outside there is a handy pantry on the left which offers additional storage with shelving and worktops. The family bathroom is also found on the ground floor, again in need of modernisations and comprises a three piece suite with panelled bath and shower over, pedestal sink, W.C and airing cupboard that houses the water cylinder.

Follow the stairs to the first floor where you will find the three double bedrooms; each generously proportioned with ample space for additional furniture. Bedrooms one and three enjoy front aspect windows, whilst bedroom two boasts dual aspects, with bedroom three benefitting from a built in wardrobe.

Externally, the property benefits from off road parking for two cars and a large garden adjacent to the track. Laid to lawn and boasting uninterrupted views over the valley beyond, the garden presents an ideal space for family and friends to enjoy throughout the year where children and pets can play. The property also owns a 2m strip at the rear of the house.



**Accommodation with approximate dimensions:**

**Ground Floor**

**Living Room** 17' 10" x 10' 4" (5.44m x 3.15m)

**Kitchen** 18' 1" x 10' 0" (5.51m x 3.05m)

**First Floor**

**Bedroom One** 17' 10" x 11' 8" (5.44m x 3.56m)

**Bedroom Three** 13' 3" x 8' 10" (4.04m x 2.69m)

**Bedroom Two** 17' 11" x 10' 3" (5.46m x 3.12m)

**Parking:**

Parking for 2 cars.

**Services:**

Mains electricity and shared septic tank drainage. The property has a private water supply with UV filter, serving 2 properties. An electric pump pulls water up to the farmhouse and adjacent Beethams Barn - with costs for this split 2 ways.

**Council Tax:**

Lancaster City Council - Band D

**Tenure:**

Freehold. Vacant possession upon completion.

**Viewings:**

Strictly by appointment with Hackney & Leigh Kirkby Office.

**What3Words Location & Directions:**

///downhill.cutback.theory



Bedroom One



Bedroom Three



Bedroom Two



Garden

# Beethams, Tatham, Lancaster, LA2

Approximate Area = 1475 sq ft / 137 sq m

For identification only - Not to scale

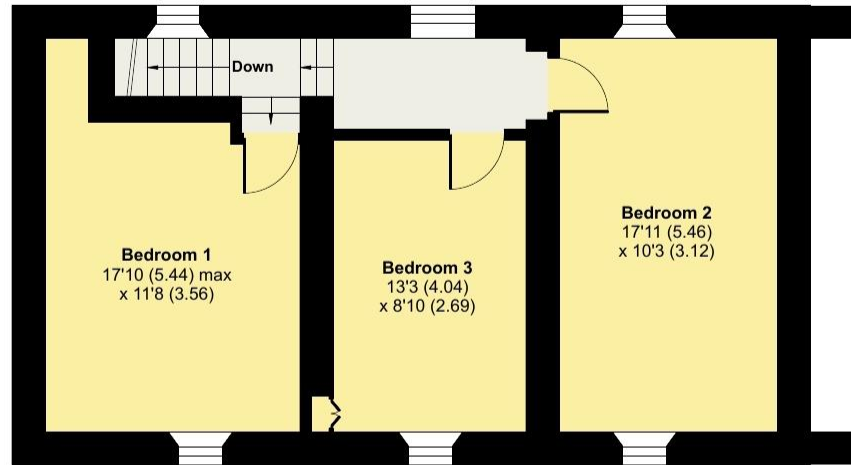

FIRST FLOOR



GROUND FLOOR



Floor plan produced in accordance with RICS Property Measurement Standards incorporating International Property Measurement Standards (IPMS2 Residential). © nchecon 2024. Produced for Hackney & Leigh. REF: 1160720

All permits to view and particulars are issued on the understanding that negotiations are conducted through the agency of Messrs. Hackney & Leigh Ltd. Properties for sale by private treaty are offered subject to contract. No responsibility can be accepted for any loss or expense incurred in viewing or in the event of a property being sold, let, or withdrawn. Please contact us to confirm availability prior to travel. These particulars have been prepared for the guidance of intending buyers. No guarantee of their accuracy is given, nor do they form part of a contract. \*Broadband speeds estimated and checked by <https://checker.ofcom.org.uk/en-gb/broadband-coverage> on 23/07/2024.

Request a Viewing Online or Call 015242 72111