



Rodney House

**bond**  
RECRUITMENT SPECIALISTS

www.bondpersonnel.com 01942 743 270

 **TaskMaster**  
Flexible, Permanent and Contract Staffing Solutions  
★ ★ ★  
INDUSTRIAL Tel: 01942 492198

Industrial Recruitment:   
Warehouse • Forklift • Production • Engineering

 **TaskMaster**  
Flexible, Permanent and Contract Staffing Solutions  
★ ★ ★  
www.tmrec.com

Permanent Recruitment:   
Finance • Technical • Clerical • Legal

 **TaskMaster**  
Flexible, Permanent and Contract Staffing Solutions  
★ ★ ★  
DRIVING Tel: 01942 492182

D I A S, Rodney House King Street  
Wigan

£950 pcm





## Rodney House King Street, Wigan

Top-floor office space in town centre available to let with 1043 sq.ft area. Ideal for businesses, featuring private kitchen area. Close to public transport and parking facilities. New lease opportunity for vibrant commercial presence. Viewings recommended.

- Town Centre Office To Let
- Top Floor Location
- 1043 Sq.Ft
- Private Kitchen Area
- Professional Environment
- Pay & Display Car Park Directly Opposite
- Walking Distance to Public Transport Links
- New Lease To Be Assigned
- Viewings Highly Recommended





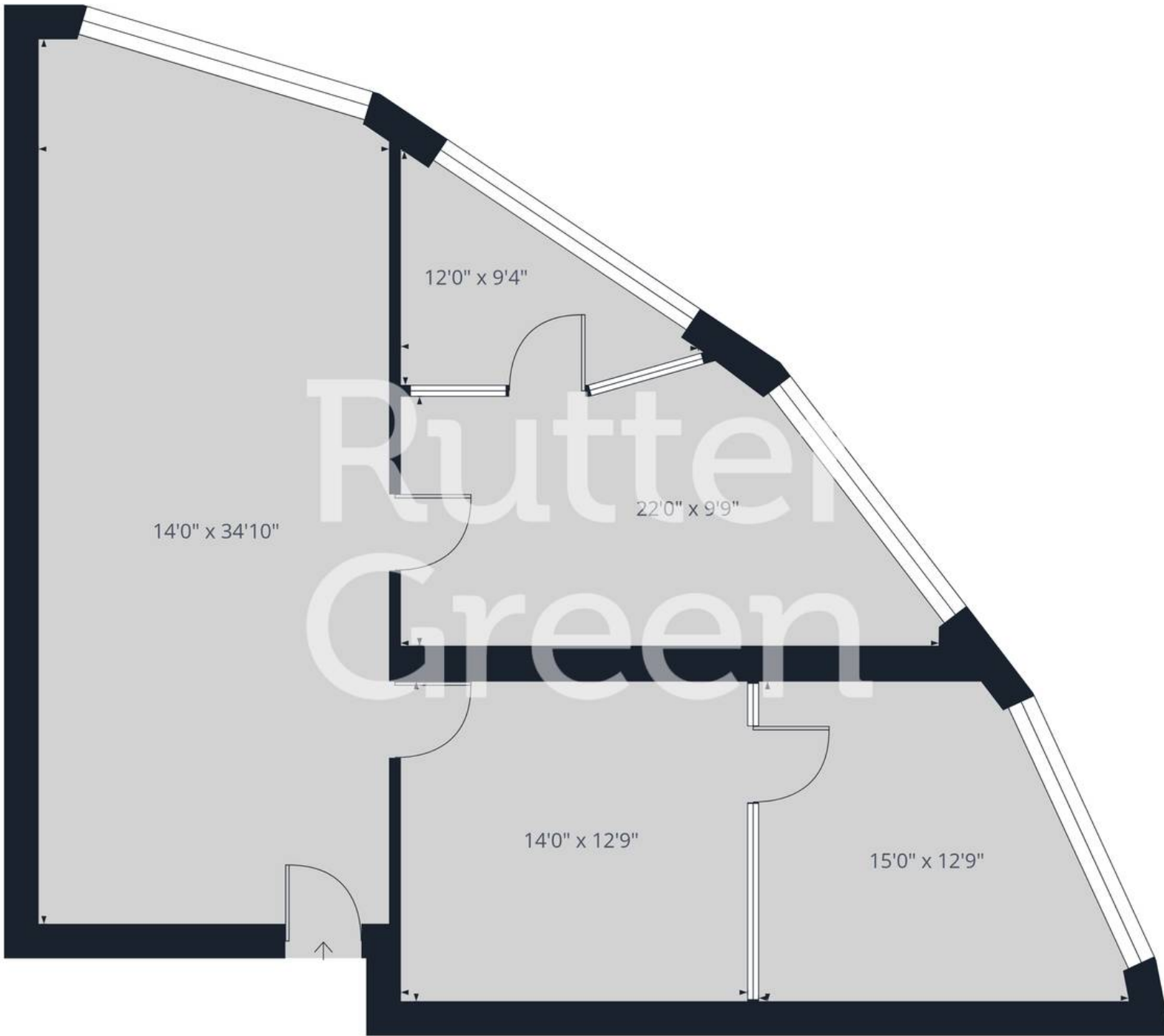

Approximate total area<sup>(1)</sup>  
1043.56 ft<sup>2</sup>

(1) Excluding balconies and terraces

While every attempt has been made to ensure accuracy, all measurements are approximate, not to scale. This floor plan is for illustrative purposes only.

GIRAFFE 360



## Rutter Green

Rutter Green Ltd, 104-108 Wallgate - WN3 4AB

01942 367915 • [hello@ruttergreen.co.uk](mailto:hello@ruttergreen.co.uk) • [www.ruttergreen.co.uk/](http://www.ruttergreen.co.uk/)



### Disclaimer

Although these particulars are thought to be materially correct, their accuracy cannot be guaranteed, and they do not form part of any contract. We ask our clients to check their own sales particulars and verify the information is correct. Fixtures, fittings and appliances have not been tested and therefore we can give no guarantees that they are in full working order. All measurements and land sizes are quoted approximately. Tenure should be established with your Solicitor and Council Tax band with Wigan Council.