

UNIT C1A THURROCK COMMERCIAL CENTRE

KERRY AVENUE, PURFLEET, RM15 4YA

FOREST
REAL ESTATE

TO LET / FOR SALE

17,250 SQ FT

Refurbished Open Plan Industrial Warehouse

Key Features

- Newly Refurbished
- Roller Shutter Door
- On Site Forecourt Parking
- Good Access To A13 / M25
- Minimum Eaves Height 9.2m
- 3 Phase Power
- End Of Terrace
- Short Drive Of Purfleet Railway Station

Unit C1A Thurrock Commercial Centre, Kerry Avenue
Purfleet, RM15 4YA





Description

The property is an end-terrace unit constructed with a robust steel frame and features durable brick and blockwork elevations beneath profile sheet cladding.

It boasts a Steel Truss pitched roof, ensuring structural integrity and durability. Inside, the unit offers a well-designed mezzanine floor, an office space, a kitchen and WC.

The unit is well-equipped with essential amenities, including lighting and gas blower heating, providing a comfortable and functional workspace.

Location

The unit is located in the well-established Thurrock Commercial Centre on Kerry Avenue within the Purfleet Industrial Park, situated on the southern side of Arterial Road (A1306) and adjacent to the A13.

The estate is strategically positioned just 2.6 miles west of junctions 30/31 of the M25 and 15.8 miles east of the City of London.

Purfleet Railway Station, which offers a direct service to London Fenchurch Street, is conveniently located within 1.5 miles.

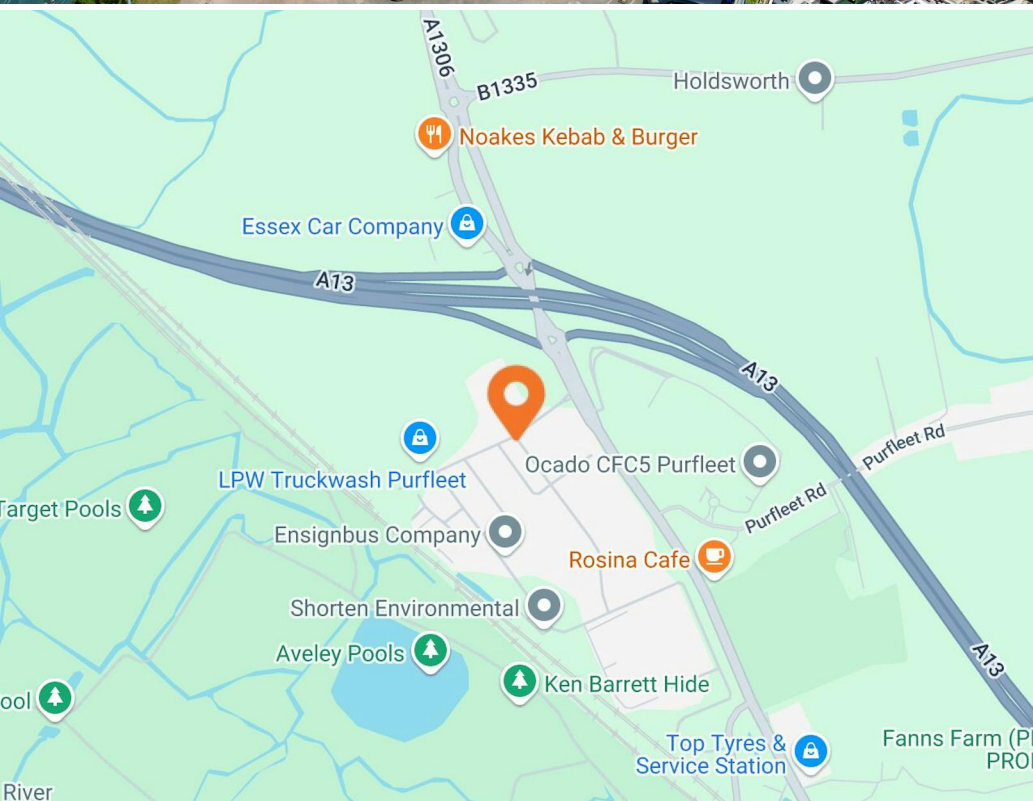



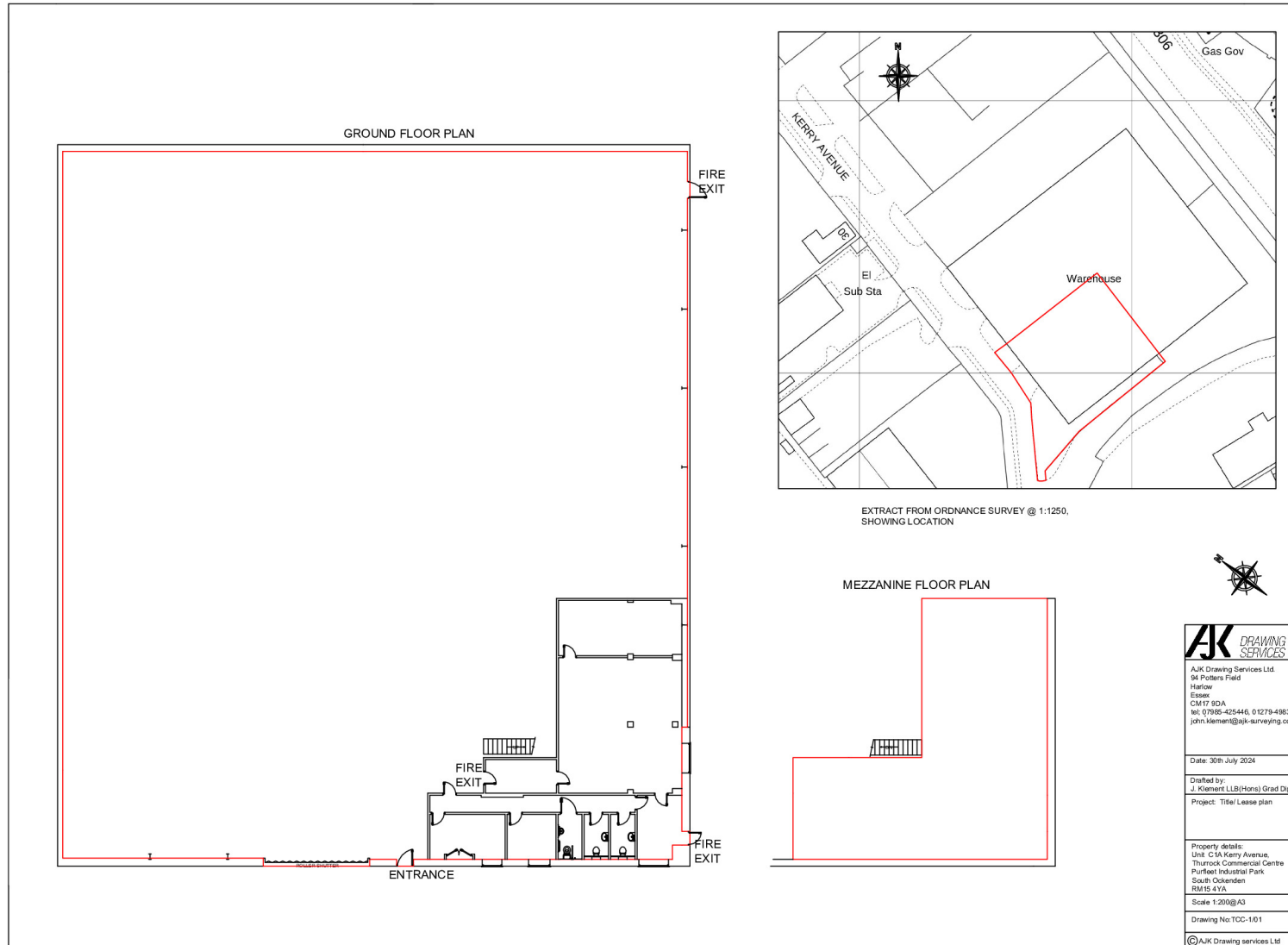

<p>AK DRAWING SERVICES LTD. AJK Drawing Services Ltd. 94 Potters Field Hatlow Essex CM17 5DA tel: 07986-425446, 01279-498371 john.klements@ajk-surveying.com</p>	Date: 30th July 2024
	Drafted by: J. Klement LLB(Hons) Grad Dip Project: Title/ Lease plan
Property details: Unit C1A Kerry Avenue Thurrock Commercial Centre Purfleet Industrial Park South Ockenden RM15 4YA	Scale 1:200@A3
Drawing No: TCC-1/01	©AJK Drawing services Ltd

Availability

Lease	New Lease
Rent	£195,000 per annum
Price	£3,100,000
Rates	£69,342 per annum
Service Charge	£2,376 per annum
VAT	Applicable
EPC	EPC exempt - Currently being constructed or undergoing major refurbishment

Contact

Ethan Shine

020 3355 1555 | 07792 781 096
ethan@forestrealestate.co.uk

Cormac Sears

020 3355 1555 | 07788 235 185
cormac@forestrealestate.co.uk

London Office Team

55 St John Street, London, EC1M 4AN
020 3370 4470

London Industrial Team

1 Bridge Lane, London, NW11 0EA
020 3355 1555

Hertfordshire Team

1a Local Board Road, Watford, WD17 2JP
01923 911 007

www.forestrealestate.co.uk
info@forestrealestate.co.uk

JOINT AGENTS

Daniel Harness (Coke Gearing Consulting)

07887 058676 | 01206 932460
daniel@cokegearing.co.uk

Unit C1A Thurrock Commercial Centre, Kerry Avenue
Purfleet, RM15 4YA

F O R E S T
REAL ESTATE

The above information contained within this brochure is subject to contract. These particulars are for general information only and do not constitute any part of an offer or contract. All statements contained therein are made without responsibility on the part of the vendors or lessors and are not to be relied upon as statement or representation of fact. Intending purchasers or lessees must satisfy themselves, by inspection, or otherwise, as to the correctness of each of the statements of dimensions contained in these particulars. Generated on 03/03/2025