



phillip shaw
estate agents

35 Martlesham Walk, Long

Guide Price £360,000



phillip shaw
estate agents



35 Martlesham Walk

London, London

Stylish 2nd-floor flat in peaceful neighbourhood, recently renovated with high-end finishes. Open plan living, modern kitchen, luxurious bathroom, ample storage, allocated parking. Close to transport links and schools. Contact us for a viewing today.

Council Tax band: C

Tenure: Leasehold

EPC Energy Efficiency Rating: C

EPC Environmental Impact Rating: C



Martlesham Walk, NW9 5BF

Approx Gross Internal Area = 55.6 sq m / 598 sq ft

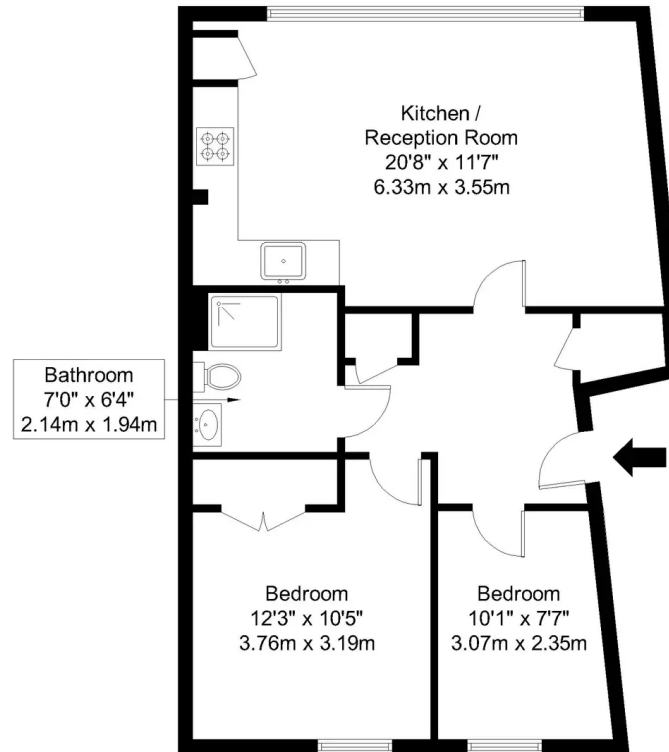

Second Floor

Ref:

Copyright **BLEU
PLAN**

The Floor plan is not to scale and measurements and areas shown are approximate and therefore should be used for illustrative purposes only. The plan has been prepared in accordance with the RICS code of Measuring Practice and whilst we have confidence in the information produced it must not be relied on. Maximum lengths and widths are represented on the floor plan. If there is any aspect of particular importance, you should carry out or commission your own inspection of the property.

Copyright @ BLEUPLAN