



STRETTONS

EST 1931

676-678 High Road, Leytonstone,
London, E11 3AA

MEDAZUR
MEDICAL CLINIC

FOR SALE

Class E Retail / Leisure

5,532 sq ft / 513.9 sq m

Offers in excess of £1,300,000

LONG LEASEHOLD COMMERCIAL PROPERTY AVAILABLE SUITABLE FOR OWNER OCCUPIERS

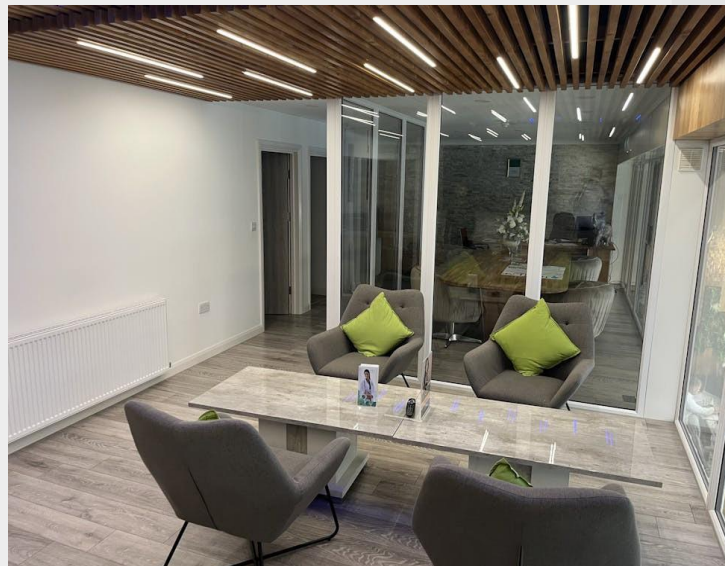
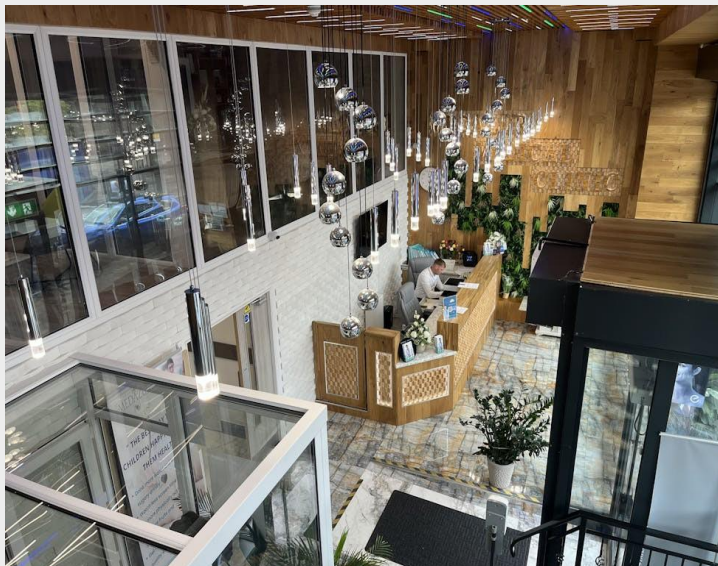

- Prime Leytonstone location
- Close to Leytonstone tube station
- The area hosts a range of retail operators
- A wide variety of Food and Beverage businesses close by
- A term of 999 years from 18/08/2022
- Vacant Possession/Suitable for owner occupiers



Description

The property enjoys a prime Leytonstone location, and comprises a large retail unit on the ground floor, with a mezzanine first floor level. The property has a central corridor off which are a number of treatment rooms, a sauna, service rooms and toilets. There is a yard to the rear of the property, adjacent to number 674 High Road.

Location

The property is located on High Road Leytonstone, opposite St. John's the Baptist's Church, 100m east of Leytonstone tube station (Central Line), between Church Lane and Kirkdale Road. The area hosts a range of retail operators, and supports a wide variety of Food and Beverage businesses. The superstore opposite is currently being refurbished with future occupiers understood to be a M&S and an Aldi.

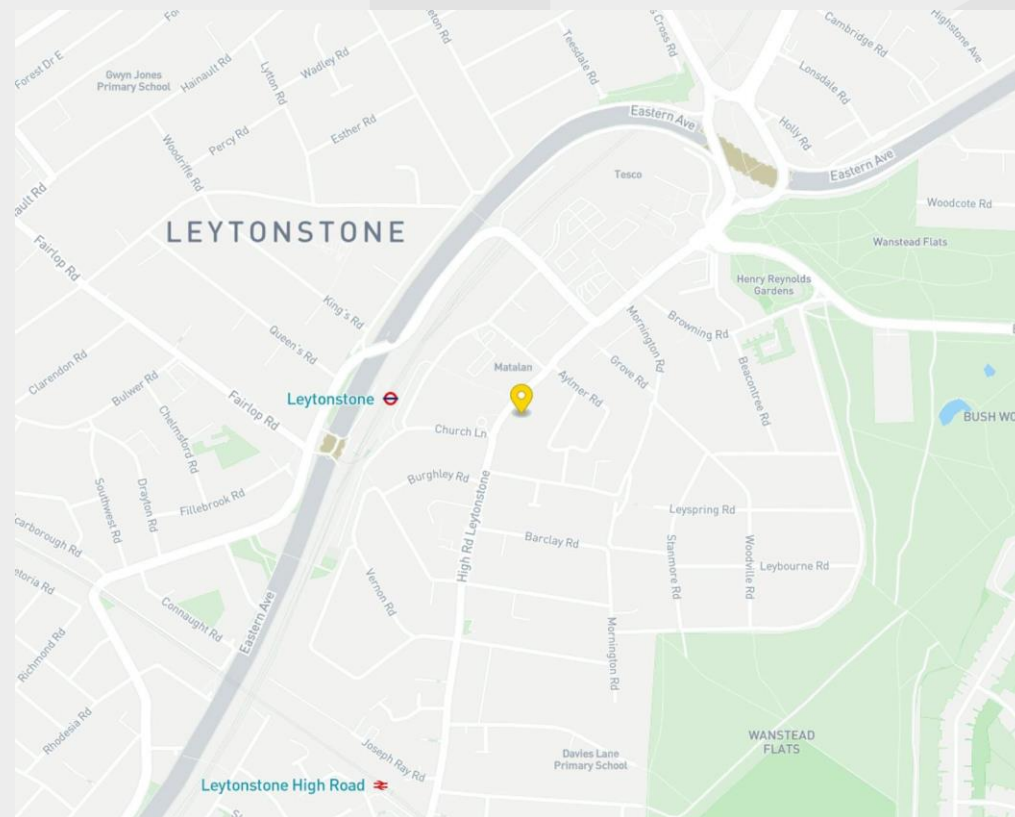

Accommodation / Availability

Unit	Sq ft	Sq m	Availability
Ground	4,304	399.85	Available
Mezzanine	1,228	114.08	Available
Total	5,532	513.93	

Tenure

Long Leasehold

EPC

Has been commissioned

VAT

Upon enquiry

Configuration

Upon enquiry

Contacts

Nowsher Alam
07967 776 358
nowsher.alam@strettons.co.uk

Robert Hills
07977 185300
robert.hills@strettons.co.uk



Further Information

[View on Website](#)

Strettons and their clients give notice that: 1. They are not authorised to make or give any representations or warranties in relation to the property either here or elsewhere, either on their own behalf or on behalf of their client or otherwise. They assume no responsibility for any statement that may be made in these particulars. These particulars do not form part of any offer or contract and must not be relied upon as statements or representations of fact. 2. Any areas, measurements or distances are approximate. The text, photographs and plans are for guidance only and are not necessarily comprehensive. It should not be assumed that the property has all necessary planning, building regulation or other consents and the Agents have not tested any services, equipment or facilities. Purchasers must satisfy themselves by inspection or otherwise. Generated on 23/09/2024