

Complete Property Services Property Brochure

Key information for buyers



Bearmore Road, Cradley Heath

B64 6DU

Starting Bid £160,000

Freehold

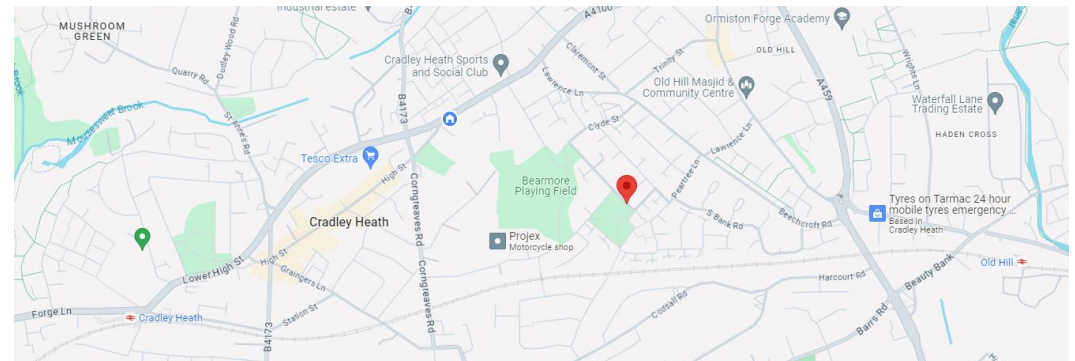

Page 1: Overview

Pages 2-5: Photos

Page 6: Map & Nearby

Page 7: EPC & Floor Plan

Key Facts



Property Type

Semi-Detached



Bedrooms

3



Bathrooms

1









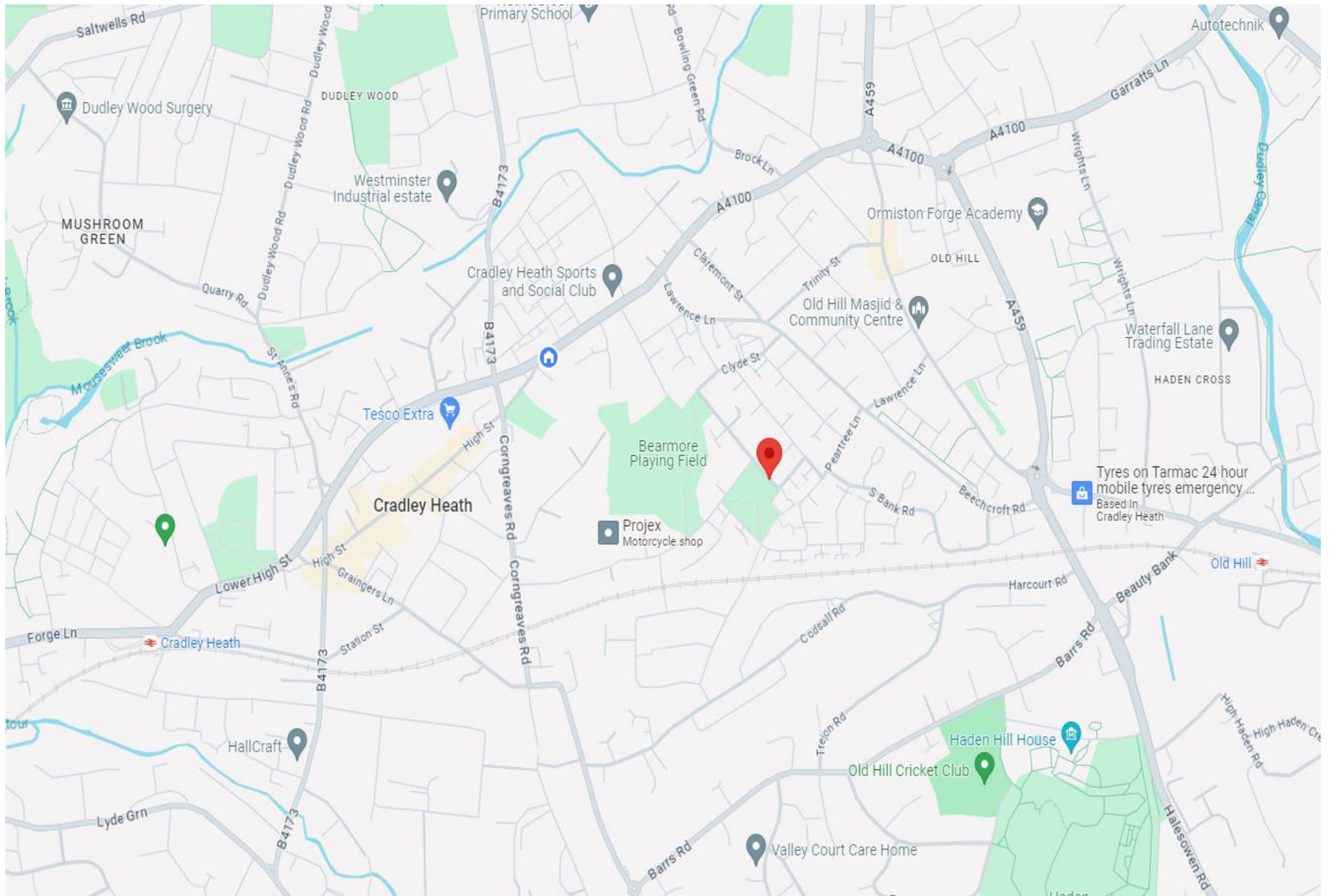



Bearmore Road, Cradley Heath, B64 6DU
(68sq m / 731sq ft)

Energy rating and score

This property's energy rating is G. It has the potential to be B.

[See how to improve this property's energy efficiency.](#)

| Score | Energy rating | Current | Potential |
|-------|---------------|---------|-----------|
| 92+ | A | | |
| 81-91 | B | | 88 B |
| 69-80 | C | | |
| 55-68 | D | | |
| 39-54 | E | | |
| 21-38 | F | | |
| 1-20 | G | 5 G | |

The graph shows this property's current and potential energy rating.

Properties get a rating from A (best) to G (worst) and a score. The better the rating and score, the lower your energy bills are likely to be.

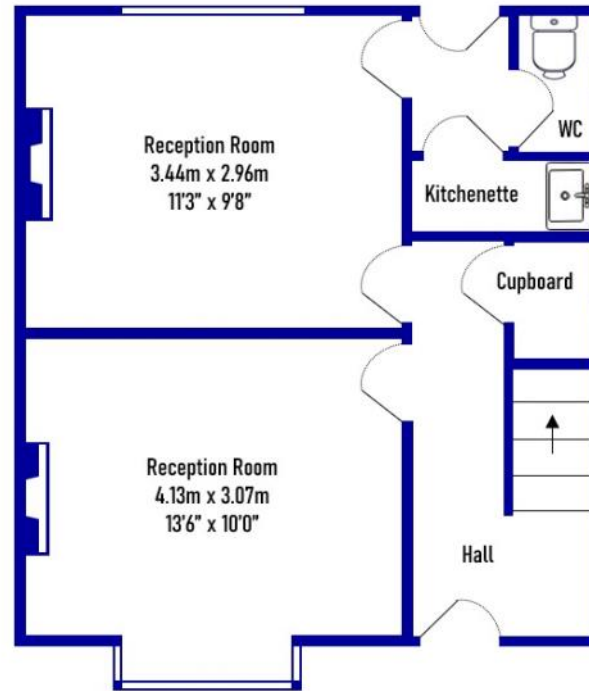

Ground Floor
(35sq m / 376 sqft)

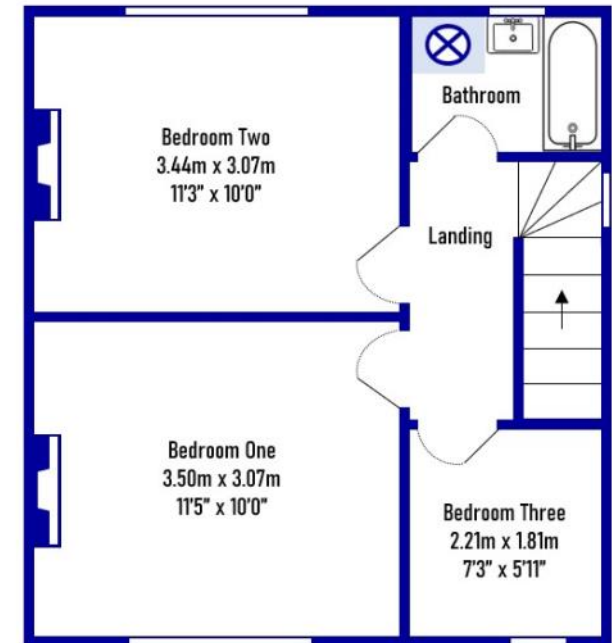

First Floor
(33sq m / 355sq ft)

Whilst every attempt has been made by Complete Property Services to ensure the accuracy of the floorplan contained here, measurements of doors, windows, rooms and any other items are approximate, and no responsibility is taken for any error, omission or mis-statement. The services, systems and appliances shown have not been tested and no guarantee as to their operability or efficiency can be given.