



24 Omdurman Street, Swindon
Swindon

£200,000



24 Omdurman Street

Swindon, Swindon

NO ONWARD CHAIN. This 2 DOUBLE BEDROOM mid-terraced property provides brilliant downstairs space with a 23FT living/dining room. Off this is a generou...

Off this is a generou...

EPC Energy Efficiency Rating: C

EPC Environmental Impact Rating: G

- 23FT LIVING/DINING AREA
- CLOSE TO AMENITIES
- FREEHOLD
- TWO DOUBLE BEDROOMS
- GARAGE
- BOILER JUST 5 YEARS OLD
- NO ONWARD CHAIN
- POPULAR LOCATION





Ground Floor

Approx. 43.0 sq. metres (462.8 sq. feet)



First Floor

Approx. 28.0 sq. metres (301.4 sq. feet)

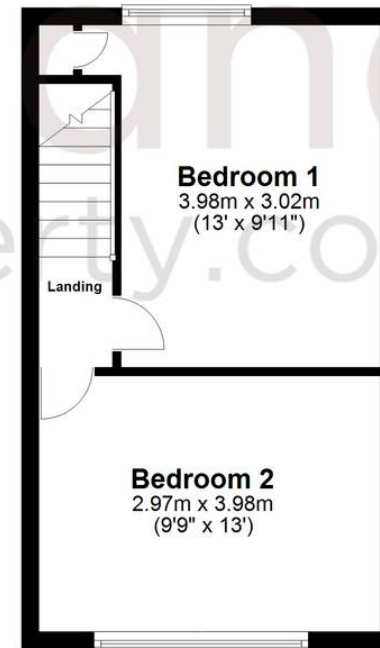

Total area: approx. 71.0 sq. metres (764.2 sq. feet)

North Swindon Sales

North Swindon, Redhouse Village Centre, Swindon – SN25 2FW

01793 296600 • swindon@mcfarlaneproperty.com • www.mcfarlaneproperty.com/