



**Sillars Green, Tetbury Road**

Malmesbury

**£474,995**



## Plot 45 Chedworth, Sillars Green

Tetbury Road, Malmesbury

Stylish 4-bed family home with modern open-plan kitchen, spacious living areas, en-suite bedroom, family-sized bathroom, garage, driveway, sought-after location. Call 01793 751 044 to view.

Tenure: Freehold

- NEW BUILD FAMILY HOME
- SOUGHT AFTER DEVELOPMENT POSITION
- DETACHED
- FOUR BEDROOMS
- TWO RECEPTIONS
- SINGLE GARAGE
- TWO PARKING SPACES
- EN-SUITE TO MASTER



**Entrance Hall**

**Living Room**

13' 3" x 10' 9" (4.03m x 3.28m)

**Dining Room**

10' 10" x 9' 10" (3.29m x 3.00m)

**Kitchen/Family Room**

9' 6" x 20' 3" (2.90m x 6.18m)

**Utility**

**WC**

**Landing**

**Bedroom 1**

11' 6" x 10' 11" (3.50m x 3.33m)

**En-Suite**

**Bedroom 2**

11' 6" x 8' 6" (3.51m x 2.60m)

**Bedroom 3**

9' 10" x 9' 0" (3.00m x 2.74m)

**Bedroom 4/Study**

7' 9" x 8' 3" (2.37m x 2.51m)

**Bathroom**



### Ground Floor

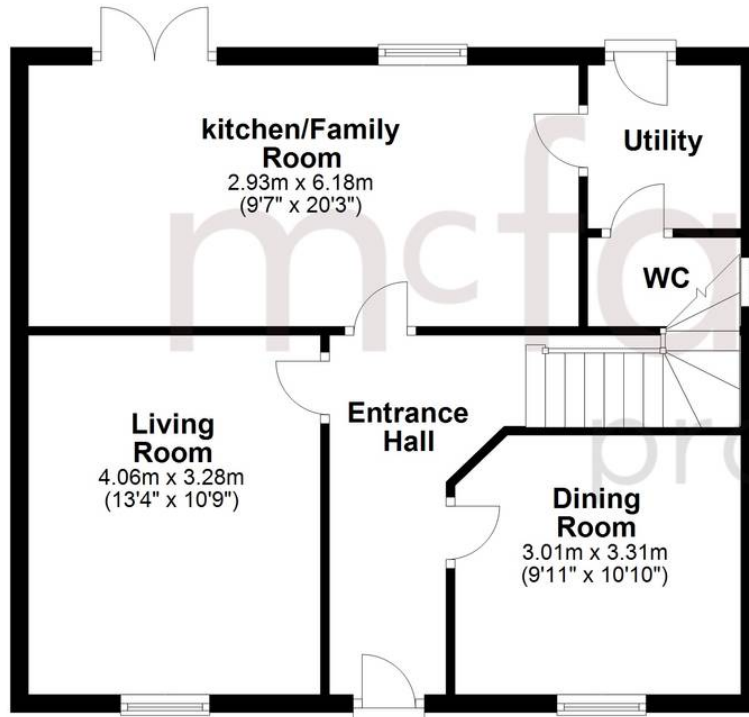

### First Floor

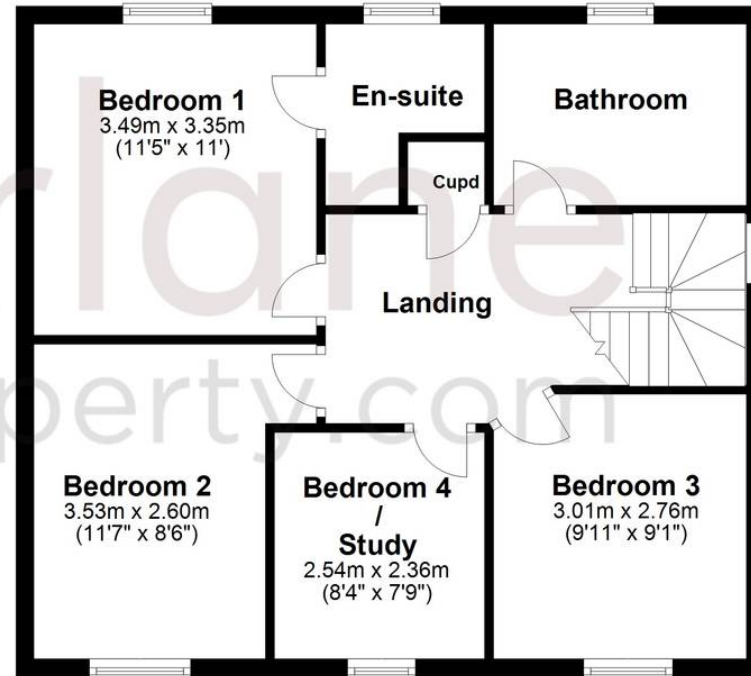

## McFarlane Sales & Lettings

Cricklade Sales, 36 High Street, Cricklade - SN6 6AY

01793 751044 • [cricklade@mcfarlaneproperty.com](mailto:cricklade@mcfarlaneproperty.com) • [www.mcfarlaneproperty.com/](http://www.mcfarlaneproperty.com/)