



26 Ashford Road, Swindon

Swindon

£275,000

mcfarlan
PROPERTY

26 Ashford Road

Old Town, Swindon

This charming end-terraced house on Ashford Road features three double bedrooms, including a master with ensuite. The ground floor boasts an entrance hall, an open-plan living/dining room, a spacious kitchen, and a family bathroom. Ideally located near local amenities, the property also includes an enclosed rear garden.

Council Tax band: C

Tenure: Freehold

EPC Energy Efficiency Rating: D

EPC Environmental Impact Rating: E

- THREE DOUBLE BEDROOMS
- END TERRACED
- OPEN PLAN LIVING/ DINING ROOM
- FAMILY BATHROOM & EN-SUITE
- SNI LOCATION
- ENCLOSED REAR GARDEN







Ground Floor

Approx. 57.5 sq. metres (618.9 sq. feet)

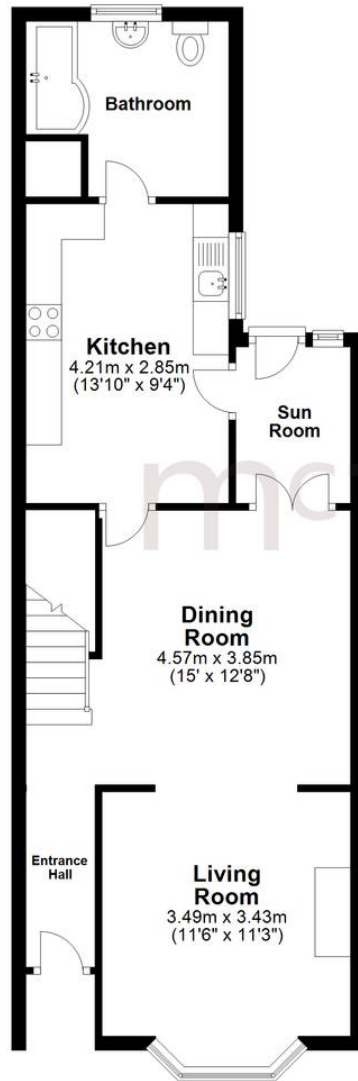

First Floor

Approx. 42.5 sq. metres (457.4 sq. feet)

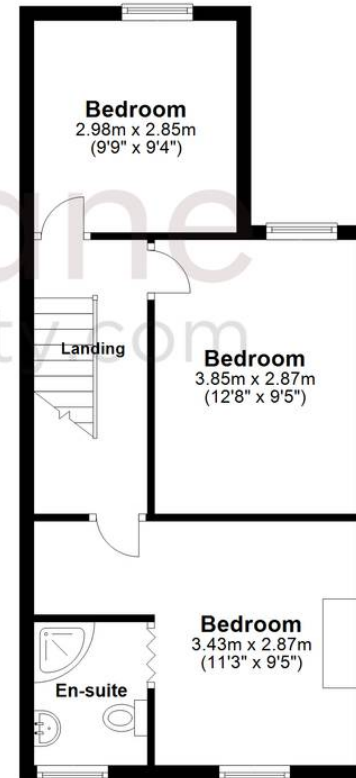

Total area: approx. 100.0 sq. metres (1076.3 sq. feet)

McFarlane Sales & Lettings

McFarlane Sales & Letting Ltd, 28-30 Wood Street - SN1 4AB

01793 296880 • oldtown@mcfarlaneproperty.com • www.mcfarlaneproperty.com/

mcfarlane
property.com