



Charlotte Street, Plymouth, PL2 1RH

£129,950 FREEHOLD EPC: E





Charlotte Street

Plymouth, PL2 1RH

Charming 2-bed house in Morice Town, Plymouth. Spacious lounge, dining room, modern kitchen, and bathroom on ground floor. Upstairs boasts two large double bedrooms. On-street parking, enclosed garden. Ideal for first-time buyers/investors. Gas central heating. Close to amenities. Freehold.

Council Tax band: A

Tenure: Freehold

- 2 Double Bedroom Mid Terrace Cottage
- Ground Floor - Lounge, Dining Room, Kitchen and Bathroom
- First Floor - 2 Double Bedrooms
- On Street Parking to the front of the property
- Good sized enclosed Garden to the rear of the property
- The property is offered For Sale on a Freehold basis
- Conveniently located for ease of access to local amenities
- This property would suit a First Time Buyer or those seeking a property to offer To Let
- Gas Central Heating



Charlotte Street

Plymouth, PL2 1RH

A 2-bedroom mid-terraced house situated in Morice Town, Plymouth.

The ground floor greets you with a spacious lounge, elegant dining room, modern kitchen, and a convenient bathroom, while the first floor reveals two generously sized double bedrooms.

Parking won't be an issue with on-street parking available at the front, and a good-sized enclosed garden at the rear adds a touch of tranquillity. Offered for sale on a freehold basis, this property is ideal for first-time buyers or investors. With gas central heating ensuring warmth and comfort, this home is perfectly positioned for easy access to local amenities. - contact us today for more information.



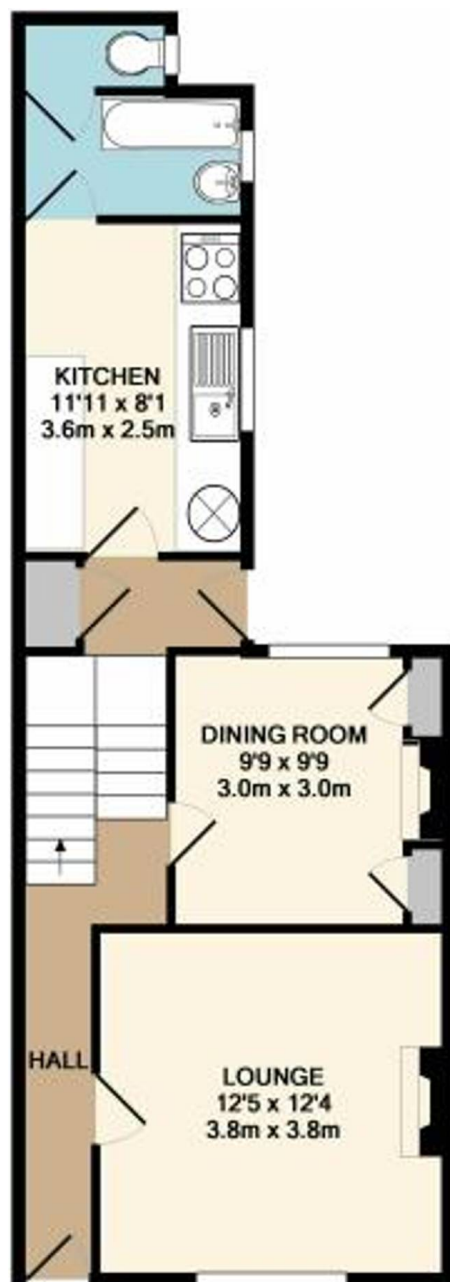

GROUND FLOOR

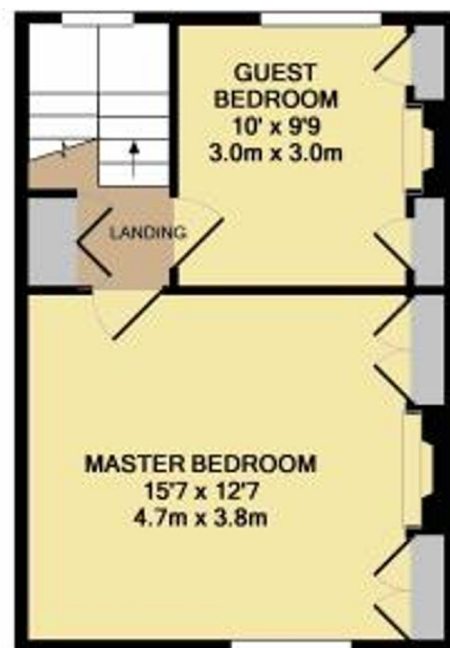

1ST FLOOR



Atwell Martin

Atwell Martin, 65 Southside Street – PL1 2LA

01752 202121

plymouthsales@atwell-martin.co.uk

plymouth.atwellmartin.co.uk/

Atwell Martin Plymouth endeavour to ensure the accuracy of property details produced and displayed. Please note that we have not tested any apparatus, equipment, fixtures, fittings or services and so cannot verify that they are connected, in working order or fit for purpose. It is imperative that the buyer of any property makes such checks, prior to purchase so as to satisfy themselves of the properties suitability for their purchase. .