



Kingsdown Road

Swindon

£349,995



Kingsdown Road

Swindon

The Ashdown, With THREE FLOORS of flexible living space means that the heart of this home can be the KITCHEN/BREAKFAST ROOM on the ground floor or the living room on the first floor. With THREE BEDROOMS and TWO BATHROOMS offer a great mix-and-match opportunity for family life and overnight guests and the separate dining room can easily be re-invented to suit your own lifestyle. With SINGLE GARAGE AND PARKING SPACE .

Tenure: Freehold

- NEW HOME
- SINGLE GARAGE AND PARKING SPACE
- SEMI DETACHED
- ACCOMODATION OVER THREE FLOORS
- TWO RECEPTIONS
- KITCHEN BREAKFAST ROOM



Dining Room

11' 3" x 8' 2" (3.43m x 2.49m)

WC

Kitchen/Breakfast Room

10' 10" x 13' 1" (3.31m x 3.99m)

Living Room

12' 6" x 13' 1" (3.81m x 3.99m)

Bedroom 3

7' 3" x 13' 1" (2.21m x 3.99m)

Bedroom 1

9' 4" x 13' 1" (2.85m x 3.99m)

En-Suite

Bathroom

Bedroom 2

9' 0" x 13' 1" (2.75m x 3.99m)



Ground Floor

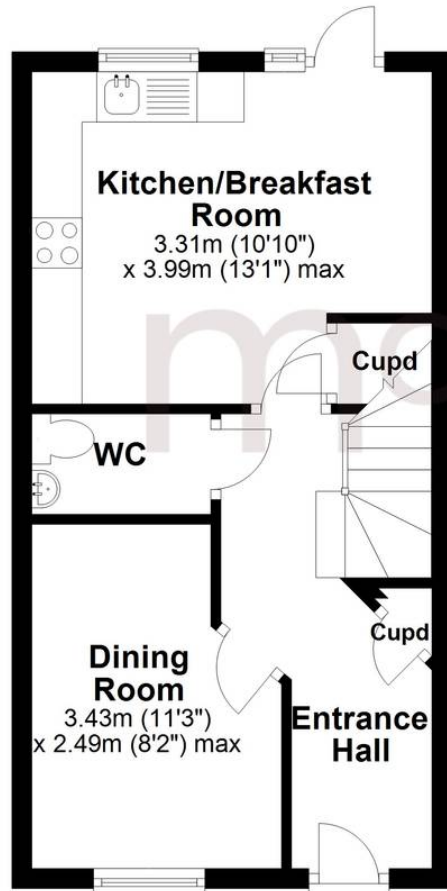

First Floor

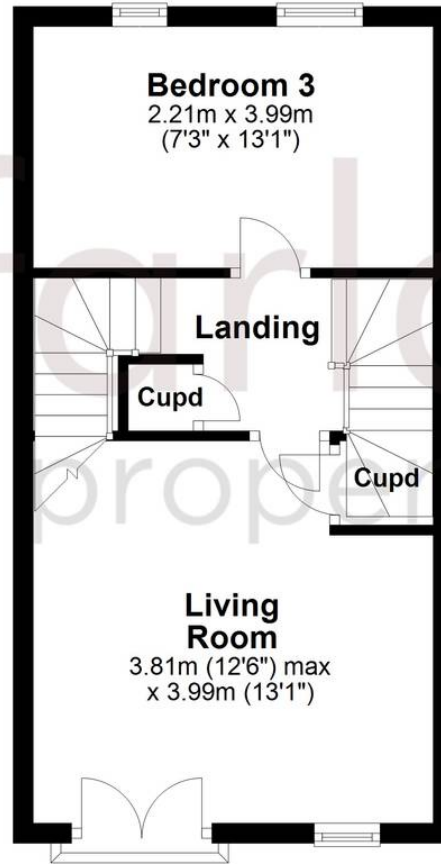

Second Floor

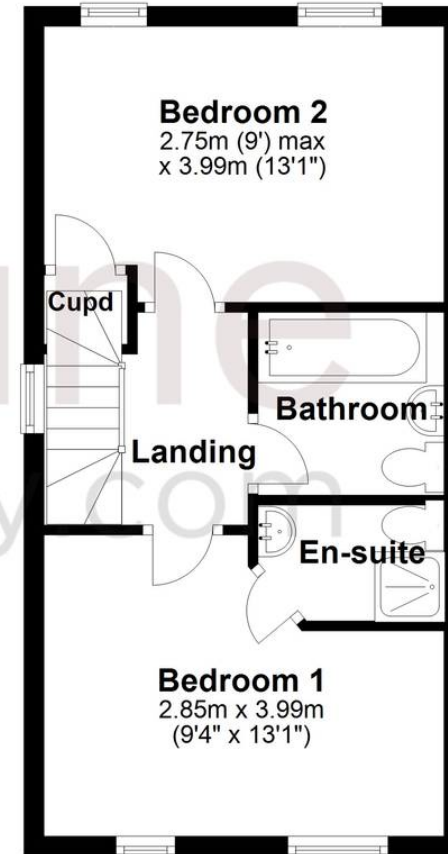

Old Town Sales

McFarlane Sales & Letting Ltd, 28-30 Wood Street - SN1 4AB

01793 296880 • oldtown@mcfarlaneproperty.com • www.mcfarlaneproperty.com/