

Crucible Homes



Brushfield Grove
Sheffield, S12 4XR

Guide Price
£180,000 - £190,000

Overview

NO CHAIN

Three double bedrooms

Downstairs W.C

Beautiful rear garden

Off road parking

Excellent transport links



Description

SUMMARY A fantastic opportunity has arisen to purchase this three bedroom semi-detached property situated on a quiet cul-de-sac with NO UPPER CHAIN.

Offering accommodation which briefly comprises; entrance gained via uPVC door into entrance hallway, spacious living/dining room with ample room for dining table and chairs and plenty of natural light, good sized kitchen, conservatory providing access out to rear garden through twin uPVC doors, downstairs W.C, to the first floor; three double bedrooms and a good sized bathroom, with a beautiful private garden and off road parking.

This home is the perfect opportunity to put your own stamp on it, ideal for first time buyers or those looking for a project to make their own and will make someone's forever home as it boasts so much potential.



GROUND FLOOR

1ST FLOOR

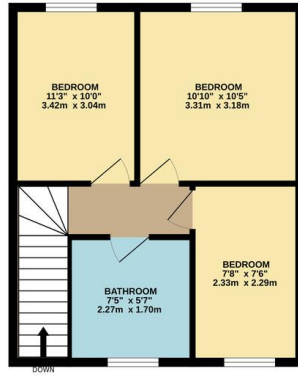
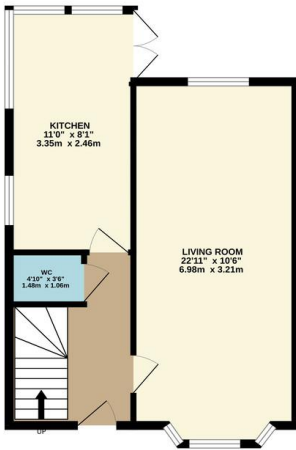

Whilst every attempt has been made to ensure the accuracy of the floorplan contained here, measurements of doors, windows, rooms and any other items are approximate and no responsibility is taken for any error, omission or mis-statement. This plan is for illustrative purposes only and should be used as such by any prospective purchaser. The services, systems and appliances shown have not been tested and no guarantee as to their operability or efficiency can be given.
Made with Metropax ©2024

This property benefits from being a stones throw away from multiple transport links to the Sheffield parkway, City Centre, Meadowhall and the M1 motorway. Please contact the office to arrange a viewing.

EPC- tbc

