





Experience upscale living in this exquisite second-floor flat situated within The Paddock, a highly regarded and modern development in Hamilton, Lanarkshire. Boasting stunning views and high-end finishes, this property promises comfort, style, and convenience.

MQ Assisted Move, Part Exchange and 95% mortgages are available.

Key Features:

Large Lounge and Dining Area: The spacious open-plan lounge and dining area is the centrepiece of this luxurious flat, featuring a charming box bay window that offers breathtaking views over the local countryside, Hamilton Race Course, Strathclyde Country Park, and Loch.

Modern Breakfasting Kitchen: The sleek and contemporary kitchen is designed for both functionality and style, with ample space for casual dining and high-quality appliances for all your culinary needs. From here you have the fantastic views over the local area too.

Three Double Bedrooms: Each of the three double bedrooms offers generous space and comfort. The master bedroom is a true retreat, complete with an en-suite shower room for added privacy and luxury.

Separate Bathroom: In addition to the en-suite, the flat includes a well-appointed separate bathroom, featuring modern fixtures and a sophisticated design.

Plenty of Storage: Abundant storage solutions are thoughtfully integrated throughout the flat, ensuring a clutter-free and organised living space.



Plush Carpets Throughout: High-quality, plush carpets extend throughout the property, adding a touch of elegance and warmth to each room.

Exterior and Amenities:

Well-Maintained Communal Greenspace: Enjoy access to beautifully maintained communal gardens, offering a tranquil outdoor environment for relaxation and recreation.

Allocated Parking: The property includes allocated parking, providing convenience and peace of mind for residents and guests.

MQ Estate Agents are open 7 days a week: Monday to Friday 8am to 9pm & Saturday & Sunday 8.30am - 9pm to arrange your viewing or valuation appointment.

LOUNGE/DINING AREA

22' 7" x 16' 4" (6.9m x 5m)

KITCHEN

13' 5" x 9' 8" (4.1m x 2.95m)

MASTER BEDROOM

14' 4" x 10' 2" (4.37m x 3.1m)

BEDROOM TWO

15' 1" x 9' 1" (4.6m x 2.77m)

BEDROOM THREE

10' 9" x 8' 2" (3.28m x 2.5m)

BATHROOM

7' 4" x 6' 9" (2.26m x 2.08m)

EN-SUITE

8' 3" x 4' 7" (2.54m x 1.42m)







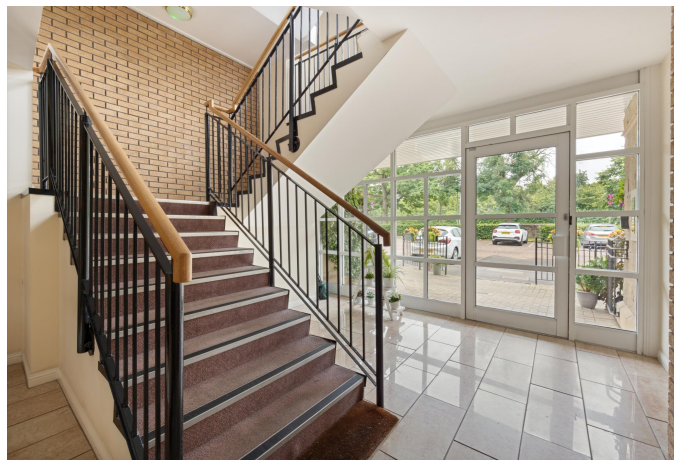

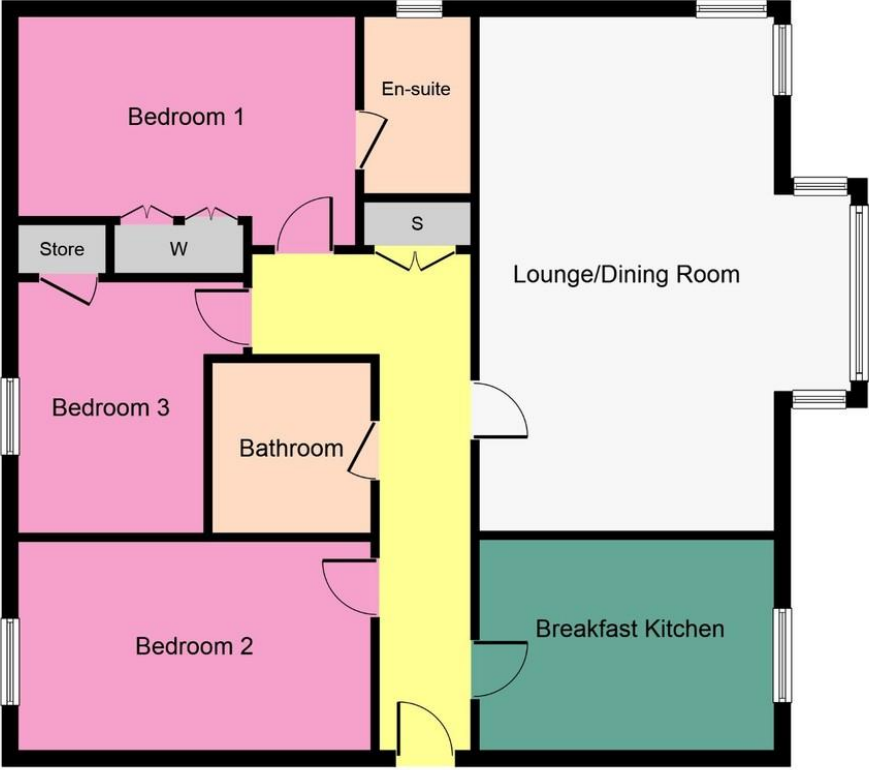

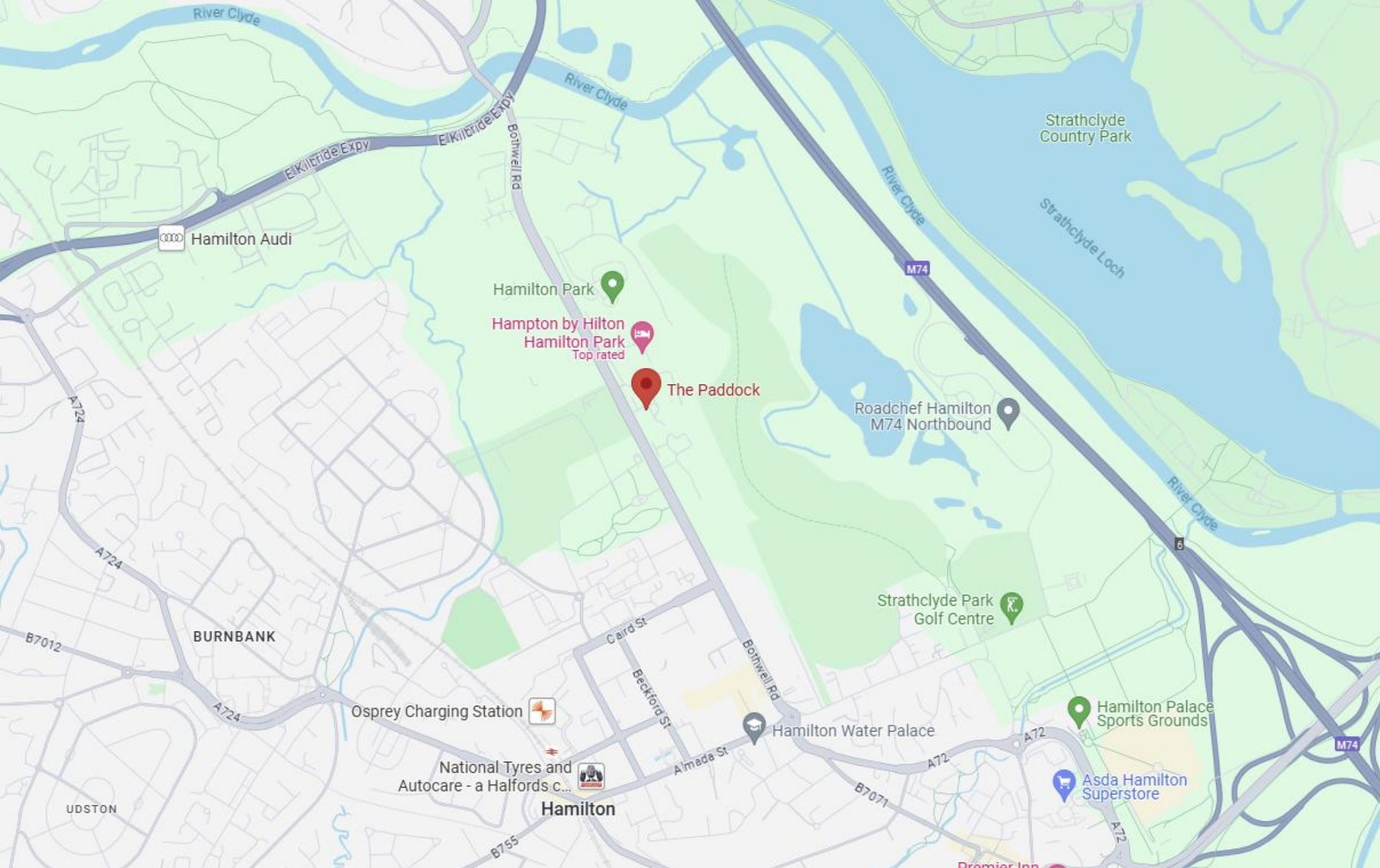

Call free on 0800 074 8585

www.mqestateagents.co.uk

We are registered with the Office of Fair Trading and the Property Ombudsman. You can be confident that the service is not only regulated but also fully transparent.

Whilst every precaution to ensure accuracy has been taken during the preparation of these particulars, if there is any aspect which is critical to your interest or which you find misleading, please contact us for further information. In accordance with the terms of the Property Misdescriptions Act, we wish to clarify all kitchen appliances or indeed other mechanical items, apparatus or appliances relating to this property, including the central heating system, has not been inspected or tested and therefore MQ Estate Agents Limited do not warrant either now or at a later date their correct functions. Please note photographs taken with a wide angled lens and all measurements are approximate and are taken with a laser tape measure, therefore MQ Estate Agents Limited cannot guarantee true room sizes and will not be held responsible.