



Ravens Lane
Berkhamsted

Ravens Lane

Berkhamsted

Offers In Excess Of £600,000

living room | dining room | kitchen | first floor landing | three double bedrooms | family bathroom | rear courtyard garden

A characterful three double bedroom period property, situated in an ever popular location within easy reach of the town centre and mainline station.

The ground floor comprises a generous open-plan reception and separate kitchen. The living room to the front includes a beautiful feature fireplace, wood flooring, and alcove storage. Reception space continues through to the dining area which also benefits from useful built-in storage. From here, stairs rise to the first floor. At the rear, the modern kitchen comes with integrated oven and hob, while a door to the side gives access to the garden.

Generous first floor accommodation is made up of three double bedrooms and a family bathroom with traditional white suite.

Outside, an attractive walled garden to the rear features low maintenance paving. There is the benefit of a storage cupboard, and gated access from Holliday Street.

This lovely family home enjoys a superb location within the Conservation area, moments away from High Street amenities and just a short walk to the station.

Services

Gas fired boiler serving domestic hot water and heating. Mains water, electricity and drainage. Council tax band D (Dacorum).

Situation

Berkhamsted, surrounded by attractive Chilterns countryside, is an historic market town offering excellent shopping, sporting and education facilities. For commuters, the A41 bypass offers good connections to both the M1 and M25, while the mainline station provides a fast and frequent service to London (Euston).

These particulars are produced in good faith, are set out as a general guide only and do not constitute any part of a contract. None of the statements are to be relied on as a statement of fact. Areas, measurements or distances are given as a guide only. We have not tested any of the equipment, appliances or services to this property nor do we have knowledge of any defects.

Ground Floor
Approx. 37.4 sq. metres (402.1 sq. feet)

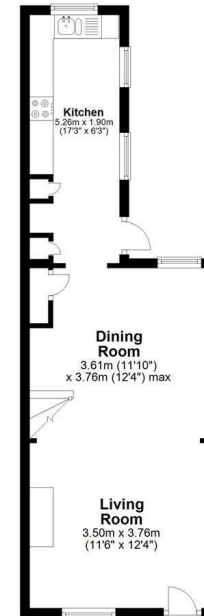

First Floor
Approx. 48.0 sq. metres (516.3 sq. feet)



Total area: approx. 85.3 sq. metres (918.4 sq. feet)

Disclaimer - Floor plan is for marketing purposes only and is to be used as a guide - SKM Studio
Plan produced using PlanUp.

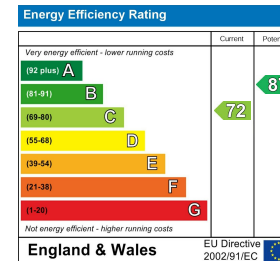

Relax... you're with Oakleys

151 High Street Berkhamsted Hertfordshire HP4 3HH 01442 386555 www.oakleysestate.co.uk



Oakleys