



27 Whitefields Drive, Richmond

Offers in the Region of £230,000

Forming part of this very popular development, the property is a two bedroomed semi detached bungalow sitting on a generous corner plot. Having scope for general updating, and with the benefit of driveway parking and a garage. Offered to the market CHAIN FREE, an early inspection is strongly recommended!

Two Bedrooms – Living Room – Kitchen – Bathroom – Generous Corner Plot – Driveway Parking – Garage – Chain Free

21 Market Place, Richmond, North Yorkshire, DL10 4QG

27 Whitefields Drive, Richmond

Forming part of this very popular development, the property is a two bed roomed semi detached bungalow sitting on a generous corner plot. Having scope for general updating, and with the benefit of driveway parking and a garage. Offered to the market CHAIN FREE, an early inspection is strongly recommended!

Hallway:

Accessed via a part glazed timber door, the hallway provides space for shoes and coats and has an airing cupboard housing the water cylinder and doors leading to the kitchen, living room, bedrooms and bathroom.

Living Room:

A perfect space for relaxing, with a large window overlooking the front of the property, a hearth housing a gas fire and a radiator.



Kitchen:

Comprising a range of wood style wall and base units with complimenting countertops, integrated is a stainless steel sink, gas hob with extractor over, a double oven and plumbing for a washing machine. The Worcester Bosch boiler is located in the kitchen. Including a radiator and windows to the front and side of the property.



Bedroom 1:

A double bedrooms with a window to the rear of the property, built in wardrobes and a radiator.



Bedroom 2:

A double bedroom with a window to the rear of the property and a radiator.



Additional Information

The postcode is DL10 7DL, the Council Tax Band is B.

Bathroom:

Comprising a panelled bath, a toilet, a sink, a radiator and a frosted window to the side of the property.



External

The property is located on a generous corner plot with a wrap around lawned garden with mature shrubbery.

The property has the benefit of driveway parking, a garage and a shed.



Whitefields Drive, Richmond, DL10 7DL

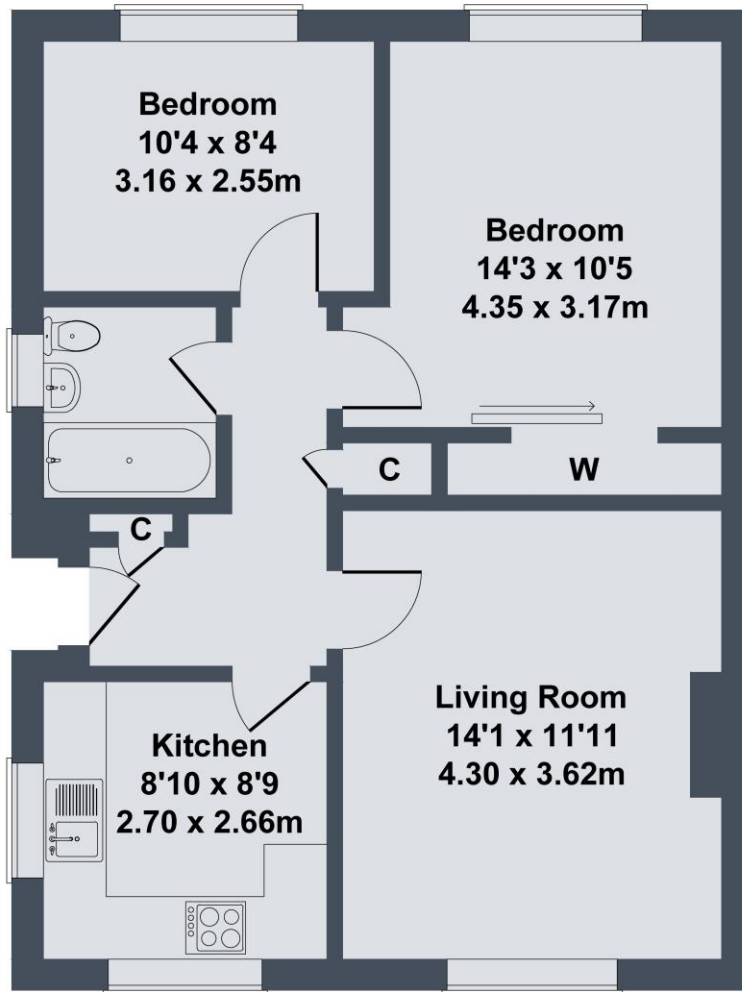

SKETCH PLAN FOR ILLUSTRATIVE PURPOSES ONLY

All measurements walls, doors, windows, fittings and appliances, their sizes and locations, are approximate only. They cannot be regarded as being a representation by the seller, nor their agent.

Produced by Potterplans Ltd. 2024