



10 Downs Wood, Epsom
Epsom

Prices From **£1,175,000**



10 Downs Wood

Epsom, Epsom

Luxury living in a 5-bed detached chalet bungalow in Epsom Downs. Close to Tattenham Corner Station and local amenities. Modern interior, open-plan kitchen/living area, garage, and spacious garden. Perfect for entertaining and enjoying outdoor living.

Council Tax band: F

Tenure: Freehold

EPC Energy Efficiency Rating: C

EPC Environmental Impact Rating:

- 5 Bedrooms
- Garage & Driveway Parking
- Close to Tattenham Corner Station, Shops, Tennis Club
- Sought-After Location on Epsom Downs
- Detached Chalet Bungalow
- Wonderful Open-Plan Kitchen / Living
- Large Private Landscaped Garden



Downs Wood, Epsom, KT18

Approximate Area = 2523 sq ft / 234.3 sq m

Garage = 105 sq ft / 9.7 sq m

Outbuilding = 41 sq ft / 3.8 sq m

Total = 2669 sq ft / 247.8 sq m

For identification only - Not to scale

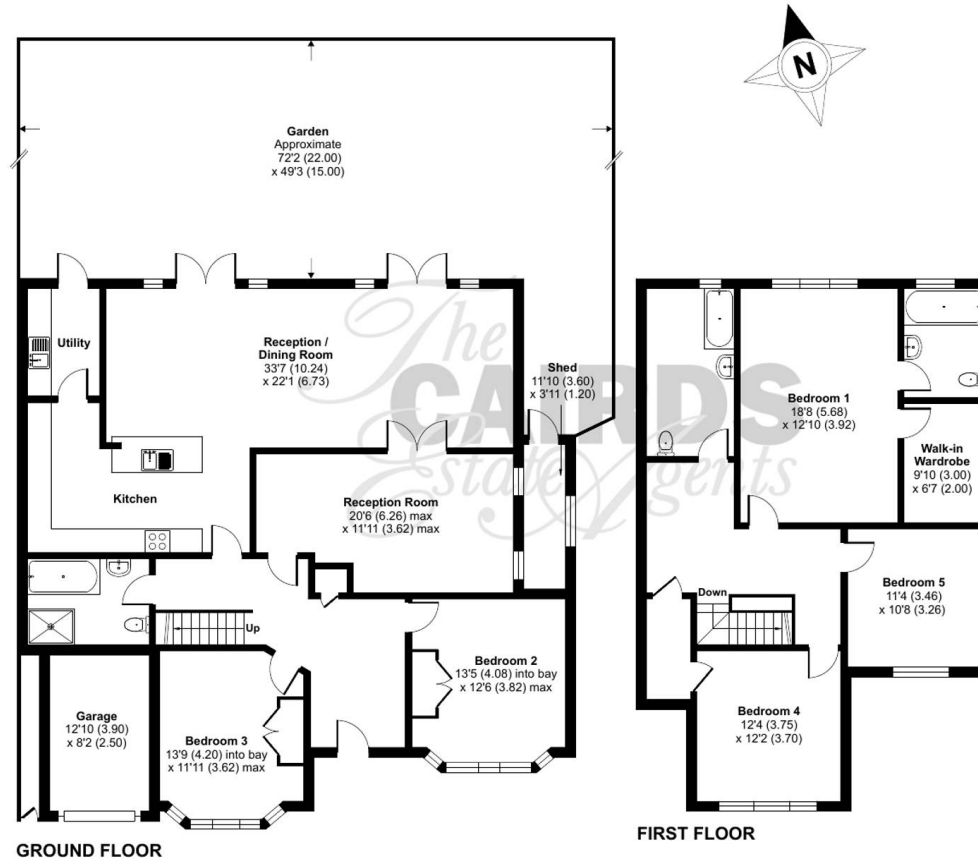





Cairds The Estate Agents

Cairds The Estate Agents, 128-130 High Street - KT19 8BT

01372 743033 • homes@cairds.co.uk • www.cairds.co.uk