

1 CAMERON PLACE
CRIEFF, PH7 3LD



1 CAMERON PLACE, CRIEFF, PH7 3LD

Irving Geddes are delighted to offer for sale this very well presented 2 bedroom end-terrace villa enjoying a private cul-de-sac location in a popular, established residential area of Crieff.

The upgraded accommodation is set over two floors, comprising on the ground floor; HALL with stairs to upper floor and walk-in storage cupboard, spacious LOUNGE/DINING ROOM, KITCHEN with door to rear, and CONTEMPORARY SHOWER ROOM. There are TWO DOUBLE BEDROOMS with built-in wardrobes on the upper floor.

Externally the property has private low maintenance gardens to the front and rear, the front laid to gravel with paved path, & the rear with an area of lawn, a paved patio, timber shed & pedestrian access. There is unrestricted on-street parking within the cul-de-sac.

A charming villa presented in true move-in condition and one likely to have broad appeal.

Energy Performance Rated 'C' **Council Tax** Band 'B'

Video Tour <https://my.matterport.com/show/?m=PDGw4cJwHVc>

Viewing Strictly by appointment through Irving Geddes - 01764 653771.









GROUND FLOOR

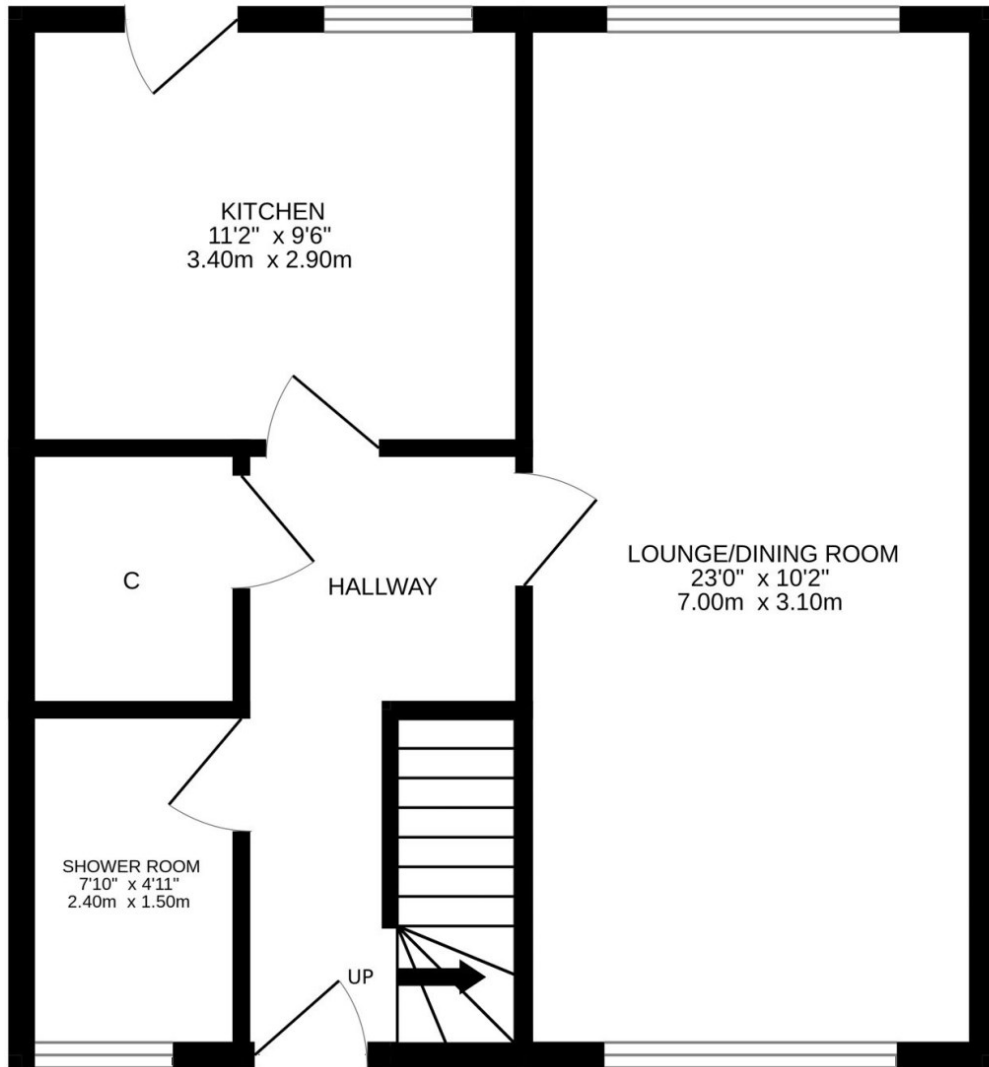

1ST FLOOR

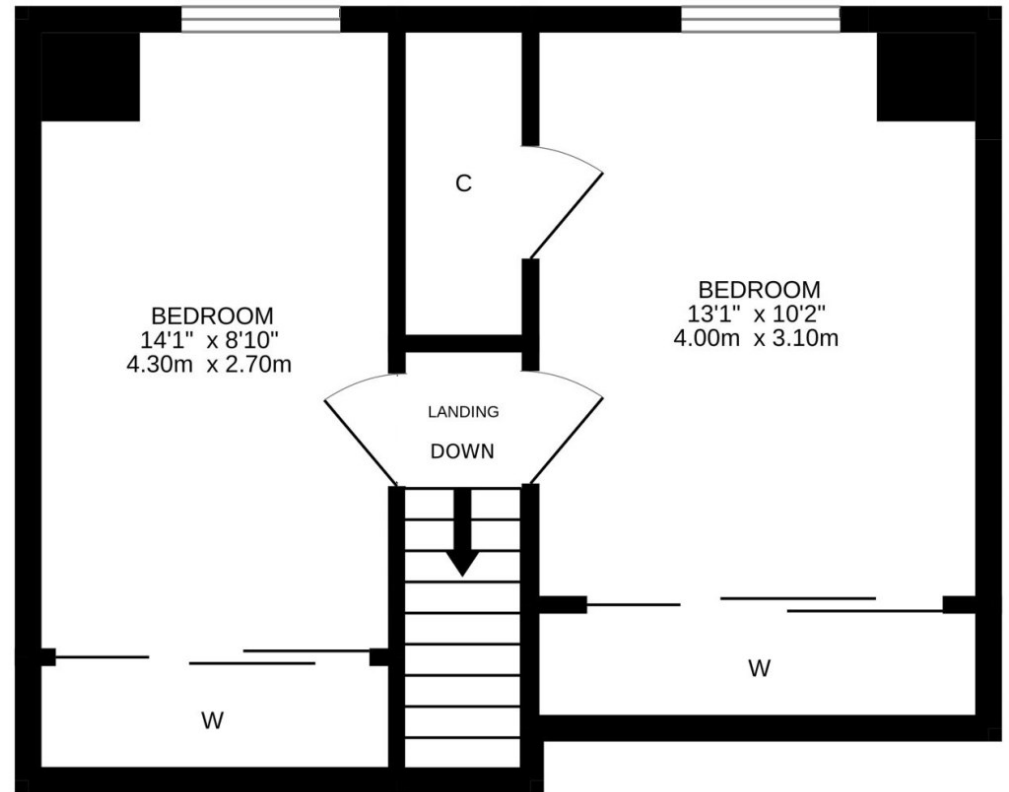

IrvingGeddes
W.S. • Solicitors • Estate Agents

These particulars are believed to be correct, but their accuracy is not guaranteed and they do not form part of any contract. All measurements are approximate only.





Crieff
25 West High Street, PH7 4AU
Tel: 01764 653771

Comrie
1 Drummond Street, PH6 2DW
Tel: 01764 670325

Aberfeldy
6 The Square, PH15 2DD
Tel: 01887 822722