

SAMUEL  
**MAKEPEACE**  
BESPOKE ESTATE AGENTS



SAMUEL  
**MAKEPEACE**  
BESPOKE ESTATE AGENTS



SAMUEL  
**MAKEPEACE**  
BESPOKE ESTATE AGENTS



SAMUEL  
**MAKEPEACE**  
BESPOKE ESTATE AGENTS



SAMUEL  
**MAKEPEACE**  
BESPOKE ESTATE AGENTS

**Millfield Crescent, Milton, Stoke on Trent**  
**£210,000 Offers In Excess Of**  
**2 Bedrooms 1 Reception Rooms 1 Bathrooms**



WE NEVER MADE PROMISES LIGHTLY, AND THERE MAY HAVE BEEN SOME THAT WE'VE BROKEN, BUT WE SWEAR IN THE DAYS STILL LEFT...YOU WILL MOST CERTAINLY BE WALKING IN FIELDS OF GOLD WHEN YOU DISCOVER THIS GORGEOUS TWO BEDROOM SEMI DETACHED BUNGALOW, situated on the highly desirable Millfield Crescent, Milton. This immaculately presented bungalow is the perfect blend of comfort and convenience, with local amenities just a five minute walk you have everything you could possibly need on your door step. The beautiful property boasts of a GENEROUS-SIZED MODERN KITCHEN with an array of room for all your cooking necessities. The LARGE LOUNGE is spacious and bright. Then it is onto the TWO DOUBLE BEDROOMS, where you could easily choose one for your second reception room. Supporting is the GORGEOUS SHOWER ROOM with it's large walk in shower. What more could you ask for in a bungalow?...A place to park your car plus more we here you cry. Well, you will certainly not be let down with the large driveway and gated car port to the side. If that wasn't enough let us tell you about the LANDSCAPED flat garden with an artificial lawn and lovely decorative beds, which comes complete with its very own SUMMERHOUSE! THIS IS CERTAINLY THE ONE FOR YOU....WE PROMISE. Contact Samuel Makepeace Bespoke Estate Agents today.



## ROOM DETAILS

### INTERIOR

#### GROUND FLOOR

##### Lounge

Double glazed bow window, radiator, and electric fire.

##### Kitchen

Double glazed door and window, tiled flooring and radiator. A range of fitted wall and base cupboards, work surfaces and tiled splash back. Sink, drainer and half bowl, integrated built under cooker, integrated gas hob and cooker hood. Space for washing machine, fridge and freezer.

##### Hall

Storage cupboard, loft access

##### Bedroom One

Double glazed window, a range of fitted wardrobes and radiator.

##### Bedroom Two

Double glazed window and radiator.

##### Shower Room

Double glazed window, tiled walls. Double shower, LLWC, hand wash basin with vanity, towel warming radiator and extractor fan.

### EXTERIOR

#### Front Garden

Decorative beds, car port and driveway for multiple vehicles

#### Rear Garden

Low maintenance garden with artificial lawn, decorative beds, summer house with power and shed



EPC Rating:  
NotSet

Council Tax:  
Band C

Local Authority:  
Stoke on Trent Council

Tenure:  
Freehold







Call us now 01782 914 444 to enquire!



## Ground Floor

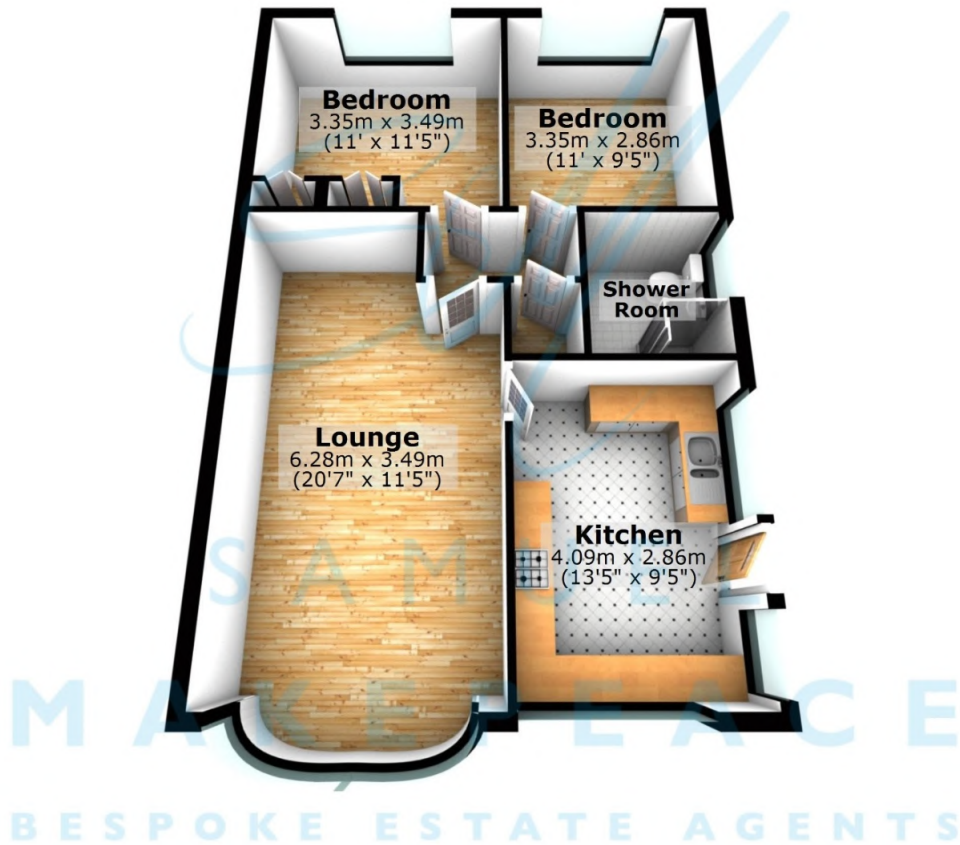

We accept no responsibility for any mistake or inaccuracy contained within the floorplan. It is provided as a guide only, and should be deemed an illustration only. The plan is not to scale, and does not suggest the correct positioning of any item within its contents. Samuel Makepeace Bespoke Estate Agents 01782 914 444.  
Plan produced using PlanUp.

**SAMUEL  
MAKEPEACE**  
BESPOKE ESTATE AGENTS



## Ground Floor



We accept no responsibility for any mistake or inaccuracy contained within the floorplan. It is provided as a guide only, and should be deemed an illustration only. The plan is not to scale, and does not suggest the correct positioning of any item within its contents. Samuel Makepeace Bespoke Estate Agents 01782 914 444.  
Plan produced using PlanUp.

### Disclaimer

The Agent has not tested any apparatus, equipment, fixtures and fittings or services and so cannot verify that they are in working order or fit for purpose. The mention of any appliances and services within these details does not imply that they are in full efficient working order. A buyer is advised to obtain verification from their Solicitor or Surveyor. References to the Tenure of a Property are based on information supplied by the Seller. The Agent has not had sight of the title documents. A Buyer is advised to obtain verification from their Solicitor. We have taken every precaution to ensure that these details are accurate and not misleading. If there is any point which is of particular importance to you, please contact us and we will endeavour to ascertain the information you require. This is advisable, particularly if you intend to travel some distance to view the property. You are advised to check the availability of this property before travelling any distance to view.

**SAMUEL  
MAKEPEACE**  
BESPOKE ESTATE AGENTS



