







## Apartment 11

St. Winefrides Romilly Crescent,  
Pontcanna

Stunning 2-bed first floor apartment in sought-after city location with en-suite bathroom, separate shower room, open plan living area, integral appliances, communal gardens, gated parking. Perfect city living near shops and cafes. Council Tax band: F

Tenure: Leasehold

EPC Energy Efficiency Rating: D

EPC Environmental Impact Rating:

- TWO DOUBLE BEDROOM FIRST FLOOR APARTMENT
- EN-SUITE AND SEPARATE SHOWER ROOM
- OPEN PLAN LOUNGE, DINING AREA & KITCHEN
- WELL KEPT COMMUNAL GARDENS
- GATED SECURE PARKING FOR ONE VEHICLE
- HIGHLY SOUGHT AFTER LOCATION
- CLOSE TO SHOPS/CAFES OF PONTCANNA AND LLANDAFF FIELDS
- NO ONWARD CHAIN
- EPC D58







### **Communal Entrance Area**

With a lift and stairs leading to all floors.

### **Private Hallway**

With a large storage cupboard housing a washing machine to remain. Door to living dining kitchen area, the two bedrooms and the shower room/WC.

### **Lounge Dining Room Kitchen - Open Plan Room**

23' 9" x 13' 0" (7.24m x 3.97m)

Large floor to ceiling windows, high quality laminate flooring, chrome light switches and ceiling spots. Open plan galley style kitchen with a range of base and wall units in grey. Integrated appliances plus single sink and drainer

### **Shower Room**

Close coupled WC, separate fully tiled shower enclosure plus basin in vanity unit.

### **Bedroom One**

13' 1" x 9' 10" (3.99m x 3.00m)

A double bedroom with French doors opening to private balcony. Large mirrored door leading to the en-suite.

### **En-Suite**

Fully tiled shower enclosure, close coupled wc, basin set into vanity unit and window.

### **Bedroom Two**

11' 2" x 9' 9" (3.41m x 2.96m)

A great size bedroom with two windows and electric radiator.

### **Allocated parking**

In a private gated parking area, one space is allocated for this property.



# 11 St Winefrides, Pontcanna

Approximate Gross Internal Area  
743 sq ft - 69 sq m

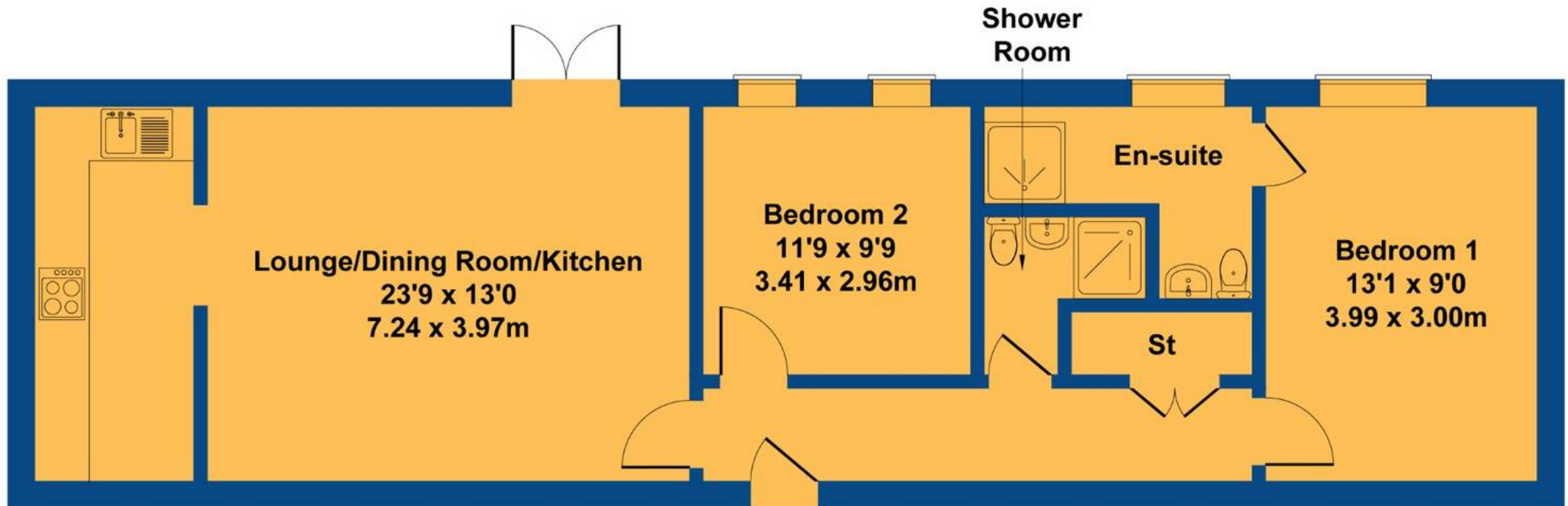

Not to Scale. Produced by The Plan Portal 2024  
**For Illustrative Purposes Only.**





## Chris Davies Estate Agents

Chris Davies Estate Agents, 29 Fontygary Road - CF62 3DS

01446 711900

[rhoose@chris-davies.co.uk](mailto:rhoose@chris-davies.co.uk)

[www.chris-davies.co.uk/](http://www.chris-davies.co.uk/)

HELPFUL INFORMATION - whilst we try to ensure our sales particulars are complete, accurate and reliable, if there is any point which is particularly important, please ask and we will be happy to check it, including specific information in respect of commuting links, surroundings, noise, views, or condition. For security purposes, applicants who wish to view will need to provide their name, address and telephone number. All measurements are approximate to the widest and longest points. Buyers are advised to instruct a solicitor to obtain verification of tenure and a surveyor to check that appliances, installations and services are in satisfactory condition.