



Flat 27 Heathdene, Chase Side, London, N14 5PR

£1750.00pcm

- **Refurbished Apartment**
- **Spacious Lounge**
- **Walking Distance To Southgate Underground Station**
- **Close to many amenities including Asda Supermarket**

A well sized, 2 bedroom first floor apartment within a moments' walk from Southgate tube station (piccadilly line). The property boasts benefits such as a large reception room, fitted wardrobes, new laminate wooden flooring and white appliances including washing machine and gas cooker and brand new oven.

The property has undergone refurbishment which will include two brand new windows in the lounge area and bathroom.

Location the property is located in the heart of Southgate, N14 offering amazing transport links highlighting the benefit of Southgate Station (Piccadilly Line) being just a 5 minute walk away allowing quick and direct access to the city.



Approximate Gross Internal Area 658 sq ft – 61 sq m

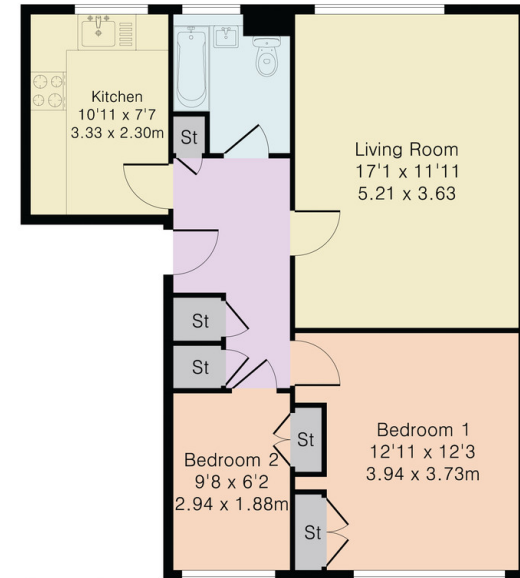

First Floor

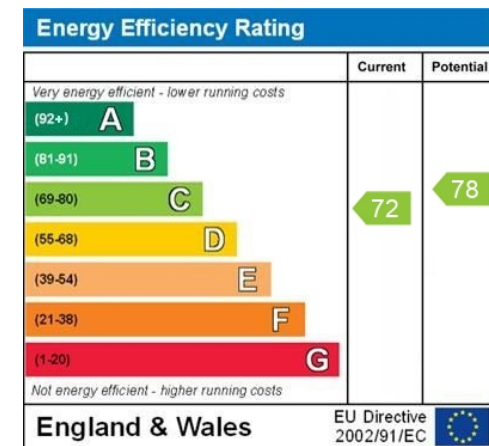
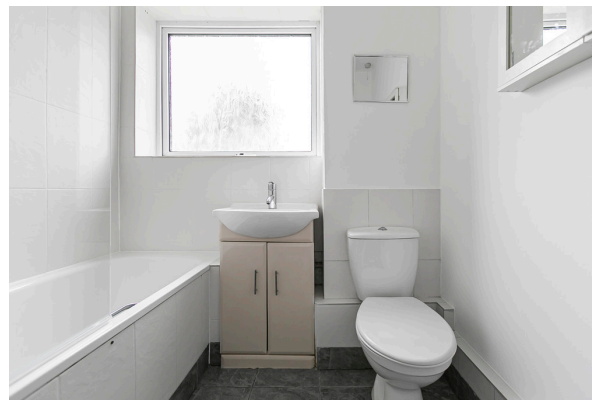

WWW.EPC4U.COM

C&N Estate Agents
 Suite 101,
 204 Baker Street,
 Enfield,
 EN1 3JY

www.cnestates.uk.com

info@cnestates.uk.com

Tel: 020 3667 1330

Agents Note: Whilst every care has been taken to prepare these sales particulars, they are for guidance purposes only. All measurements are approximate are for general guidance purposes only and whilst every care has been taken to ensure their accuracy, they should not be relied upon and potential buyers are advised to recheck the measurements