



# Fitzmaurice House Rennie Estate, South Bermondsey

London

£350,000

OLIVER *OJ* JAQUES  
EST. 1986

# Flat 20

Fitzmaurice House Rennie Estate, London

Purpose built two bedroom first floor flat located close to South Bermondsey Station and available with no onward chain. The property includes two DOUBLE bedrooms, private balcony and entry phone system. We highly recommend an internal viewing. The Underground system can accessed via Bermondsey Underground station (Zone 2/Jubilee Line) 0.8 miles or Overground via Surrey Quays (Zone 2) just 0.6 miles.

Council Tax band: B

EPC Energy Efficiency Rating: C

EPC Environmental Impact Rating: C

- Purpose Built First Floor Flat
- Two Double Bedrooms
- Balcony Overlooking Communal Gardens
- Close To South Bermondsey Station (Southern Rail)
- Spacious Reception Room
- Vacant Possession and No Onward Chain

## TENURE

Leasehold – Lease expires 28th March 2129

Ground Rent £10 per year

Service Charge £2020 per year



# Fitzmaurice House, Rennie Estate, London, SE16

Approximate Area = 714 sq ft / 66.3 sq m

For identification only - Not to scale

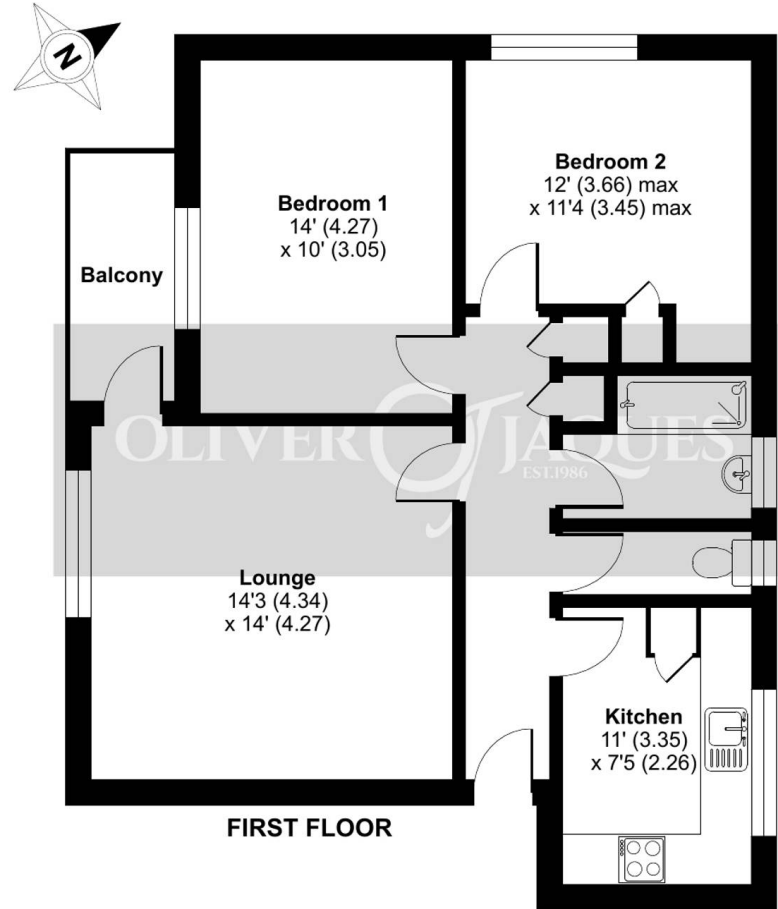

Floor plan produced in accordance with RICS Property Measurement Standards incorporating International Property Measurement Standards (IPMS2 Residential). ©nlchecon 2024. Produced for Oliver Jaques. REF: 1175774



## Oliver Jaques

Oliver Jaques, 229-231 Lower Road - SE16 2LW

02072315050 • southeast@o-j.co.uk • o-j.co.uk/

Every care has been taken with the preparation of this brochure but it is for general guidance and complete accuracy can't be guaranteed. Prospective purchasers should seek clarification from their solicitor. The mention of any appliances fixtures or fittings does not imply they are in working order.