

## Plots of land at Tong Farm, Isle of Lewis



Situated at Tong Farm there are two building plots still available for sale. The plots are situated approximately 3 miles from Stornoway town centre and overlook a stunning view across to Stornoway town. The plots measure approximately **25m x 30m**. The purchaser will be responsible for gaining outline planning permission and the erection of a stock proof fence.

### *Directions*

Travelling out of Stornoway town centre passing the Western Isles Hospital take the first turning to your right and travel along this road for approximately 1 mile until you reach the village of Tong. The Tong farm plots are located at the roadside to your right hand side.

**Offers Over  
£20,000**

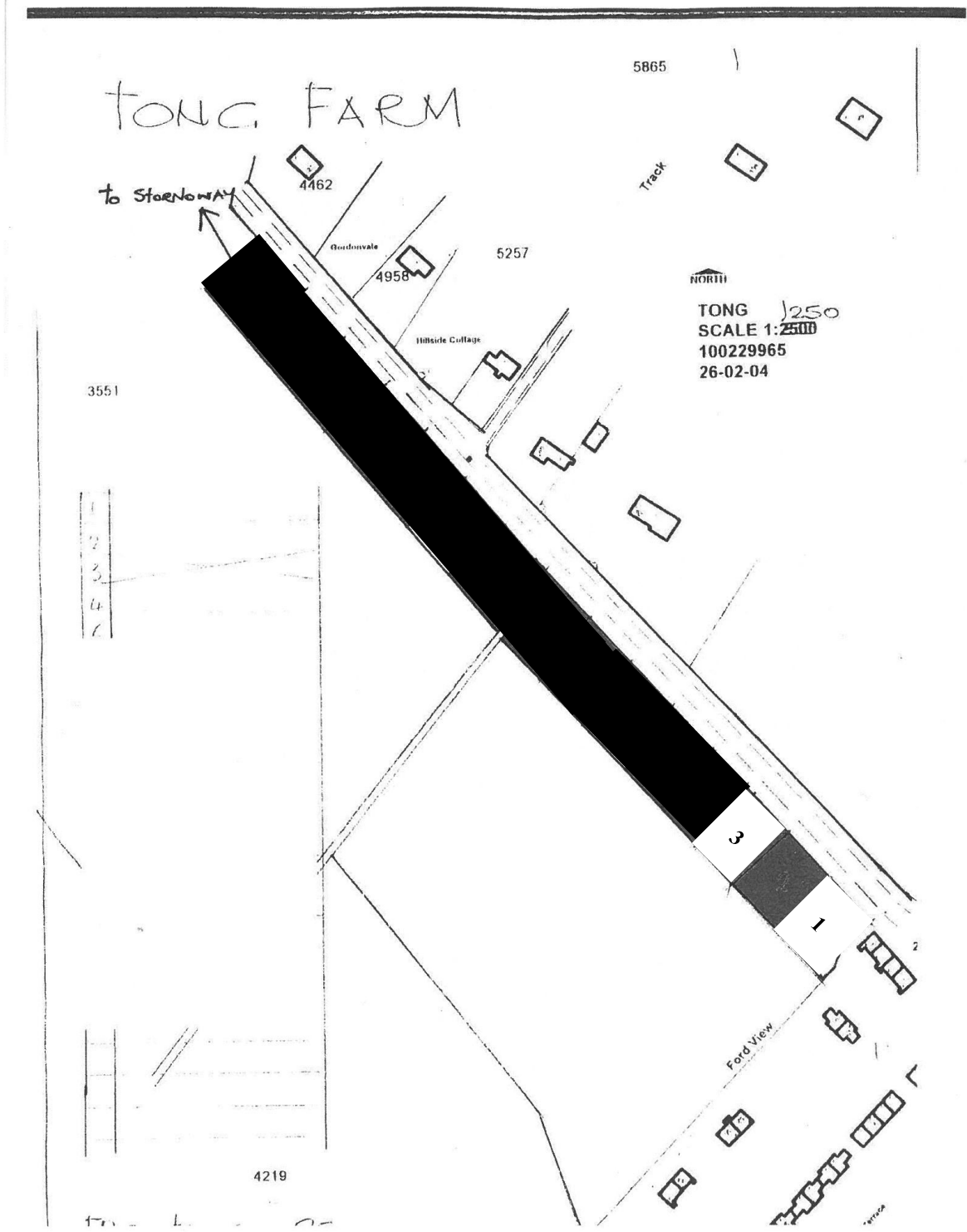

General: Whilst we endeavour to make these particulars as accurate as possible they are set out as a guide only and are not guaranteed. All measurements are approximate and are intended for general guidance only. Room sizes are taken with a digital/sonic-measuring device and are taken to the widest point. We have not tested the services or any of the equipment or appliances in the property we strongly advise prospective buyers to commission their own survey or service reports before finalising their offer to purchase. THESE PARTICULARS ARE ISSUED IN GOOD FAITH BUT DO NOT CONSTITUTE REPRESENTATIONS OF FACT OR FORM PART OF ANY OFFER OR CONTRACT. THE PARTICULARS SHOULD BE INDEPENDENTLY VERIFIED BY PROSPECTIVE BUYERS OR TENANTS. NO PERSON IN THIS FIRMS EMPLOYMENT HAS THE AUTHORITY TO MAKE OR GIVE ANY REPRESENTATION OR WARRANTY IN RESPECT OF THE PROPERTY.