

# S&B



## **2 Double Bedroom Garden Apartment located in Kingston, Canbury Park Road OIEO £600,000 Freehold**

A stunning, light bright & airy two double bedroom ground floor garden apartment offering a spacious open plan kitchen /living /dining area with a modern high end fitted kitchen & built in "Neff" appliances,

Two double bedrooms with fitted wardrobes, Modern fitted white bathroom suite, private enclosed landscaped garden, Within a short walk of Kingston B.R & Town Centre Vendor suited with no onward chain

[WWW.STACKANDBONNER.COM](http://WWW.STACKANDBONNER.COM)

020 8974 8844

[sales@stackandbonner.com](mailto:sales@stackandbonner.com)



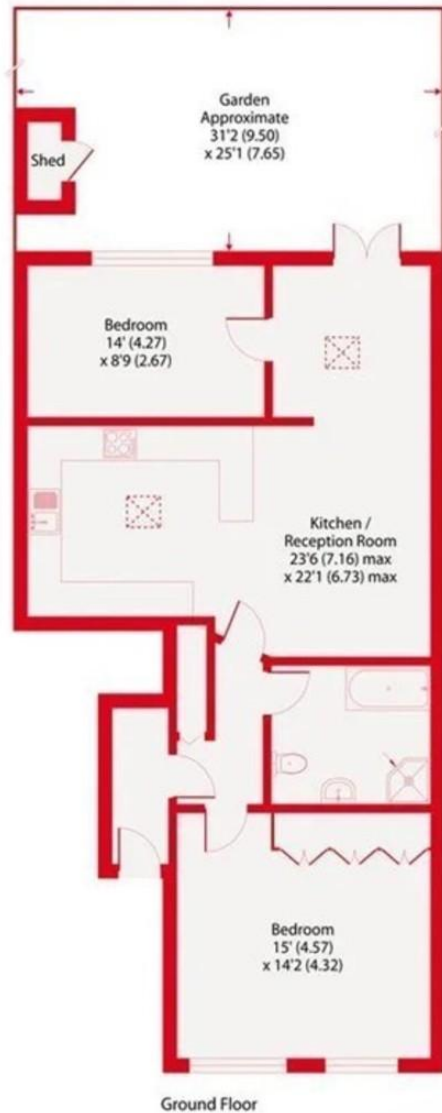

Canbury Park Road, KT2  
 Approximate Area = 900 sq ft / 84 sq m  
 Outbuilding = 9 sq ft / 1 sq m  
 Total = 909 sq ft / 85 sq m  
 For identification only - Not to scale

- Spacious Open Plan Living Area
- Modern High End Fitted Kitchen with Build In "Neff" Appliances
- Modern Fitted White Bathroom Suite
- Two Double Bedrooms with Fitted wardrobes
- Gas Central Heating via Combination Boiler
- Double Glazed Windows - Fitted Plantation Shutters
- Private Landscaped Rear Garden
- With Easy Walking Distance of Kingston B.R & Town Centre
- Vendor Suited with No Onward Chain
- Share of Freehold (167 Years)
- Council Tax: Band D - £2,374.32 Per annum