



FOR SALE

2 Bed Detached Bungalow in The Plantation, Countesthorpe, LE8 5ST
£325,000

*** No Chain *** Fully refurbished detached bungalow in Countesthorpe close to a selection of amenities, local schools and bus routes. The refurbishment includes new kitchen and shower room. Re-decorated through, new carpets and windows and internal front door have been replaced. The property also offers lots of scope for alteration and extension, subject to the necessary consents. The current configuration comprises porch, entrance hall, lounge, kitchen/breakfast room, two double bedrooms, shower room, lobby, garage, more than ample off road parking



GROUND FLOOR
994 sq.ft. (92.4 sq.m.) approx.

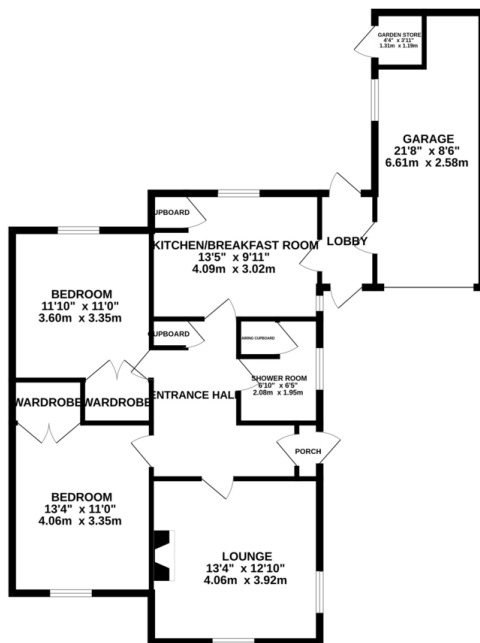

TOTAL FLOOR AREA: 994 sq.ft. (92.4 sq.m.) approx.
While every attempt has been made to ensure the accuracy of the floorplan (including room, measurements of doors, windows, rooms and any other items are approximate and no responsibility is taken for any error, omission or mis-statement. This plan is for illustrative purposes only and should be used as such by any prospective purchaser. The services, systems and appliances shown have not been tested and no guarantee as to their operability or efficiency can be given.
Made with Metragen 12/2017

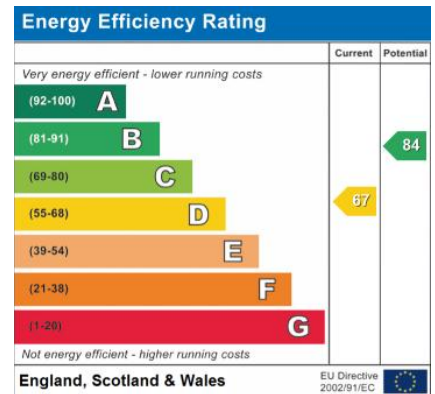

- No Chain
- Detached Bungalow
- Fully Refurbished
- Potential To Extend
- Two Double Bedrooms
- Shower Room
- Garage
- Cul-De-Sac Location

Agents Note: Whilst every care has been taken to prepare these sales particulars, they are for guidance purposes only. All measurements are approximate are for general guidance purposes only and whilst every care has been taken to ensure their accuracy, they should not be relied upon and potential buyers are advised to recheck the measurements.

