

Complete Property Services Property Brochure

Key information for buyers



Mallen Drive, Oldbury

B69 1LX

Offers Over £345,000

Freehold

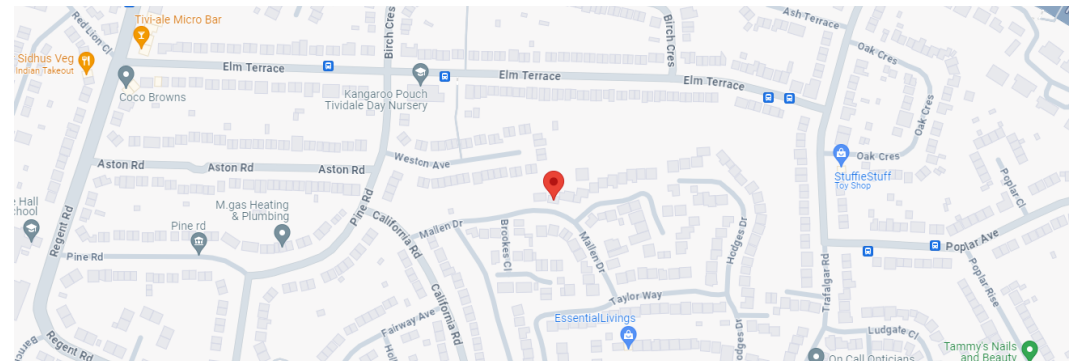

[Page 1: Overview](#)

[Pages 2-5: Photos](#)

[Page 6: Map & Nearby](#)

[Page 7: EPC & Floor Plan](#)

Key Facts



Property Type

Detached Bungalow



Bedrooms

3



Bathrooms

1









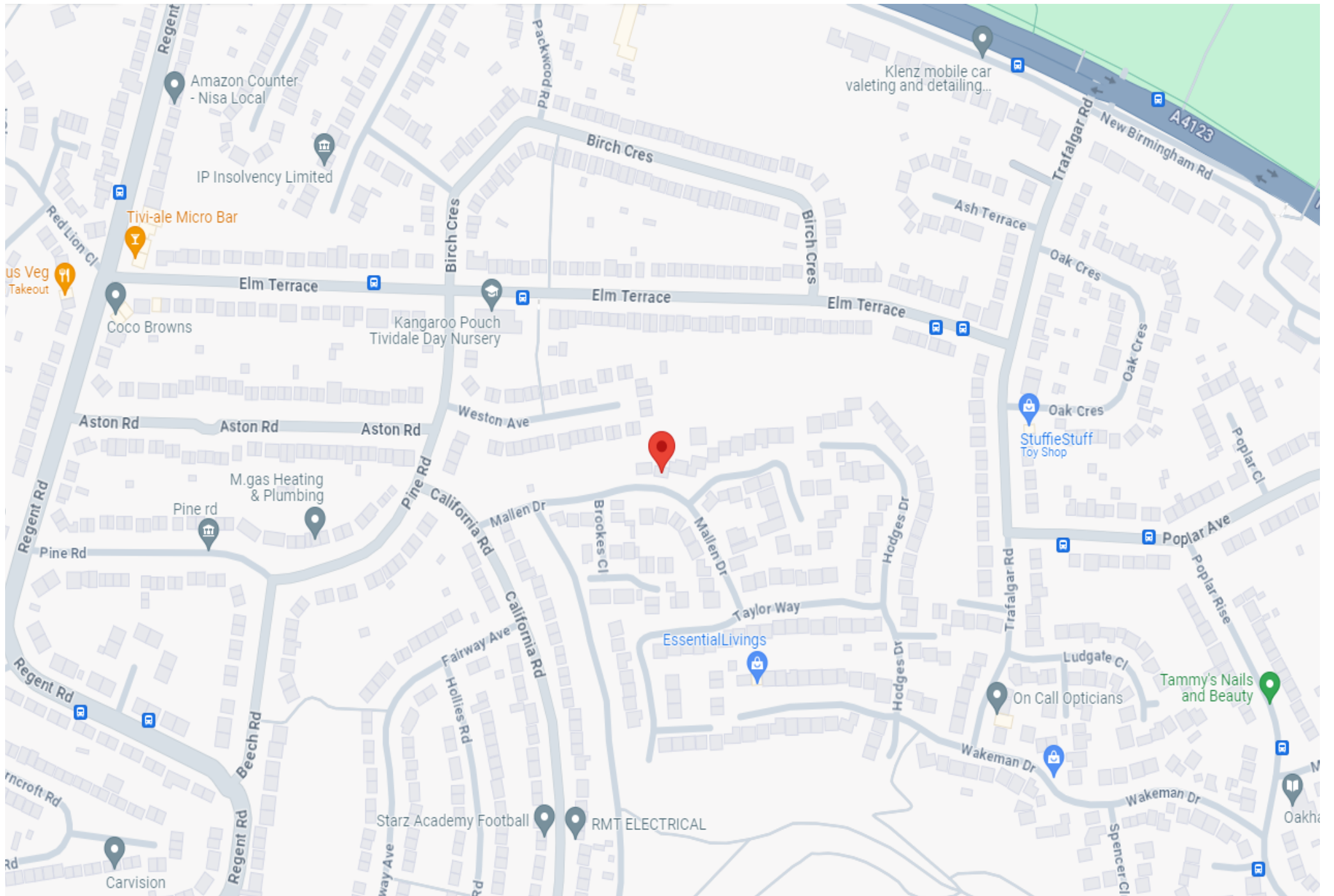



Mallen Drive, Oldbury, B69 1LX
(60sq m / 645sq ft)

Energy rating and score

This property's energy rating is B. It has the potential to be A.

[See how to improve this property's energy efficiency.](#)

Score	Energy rating	Current	Potential
92+	A		123 A
81-91	B	82 B	
69-80	C		
55-68	D		
39-54	E		
21-38	F		
1-20	G		

The graph shows this property's current and potential energy rating.

Properties get a rating from A (best) to G (worst) and a score. The better the rating and score, the lower your energy bills are likely to be.

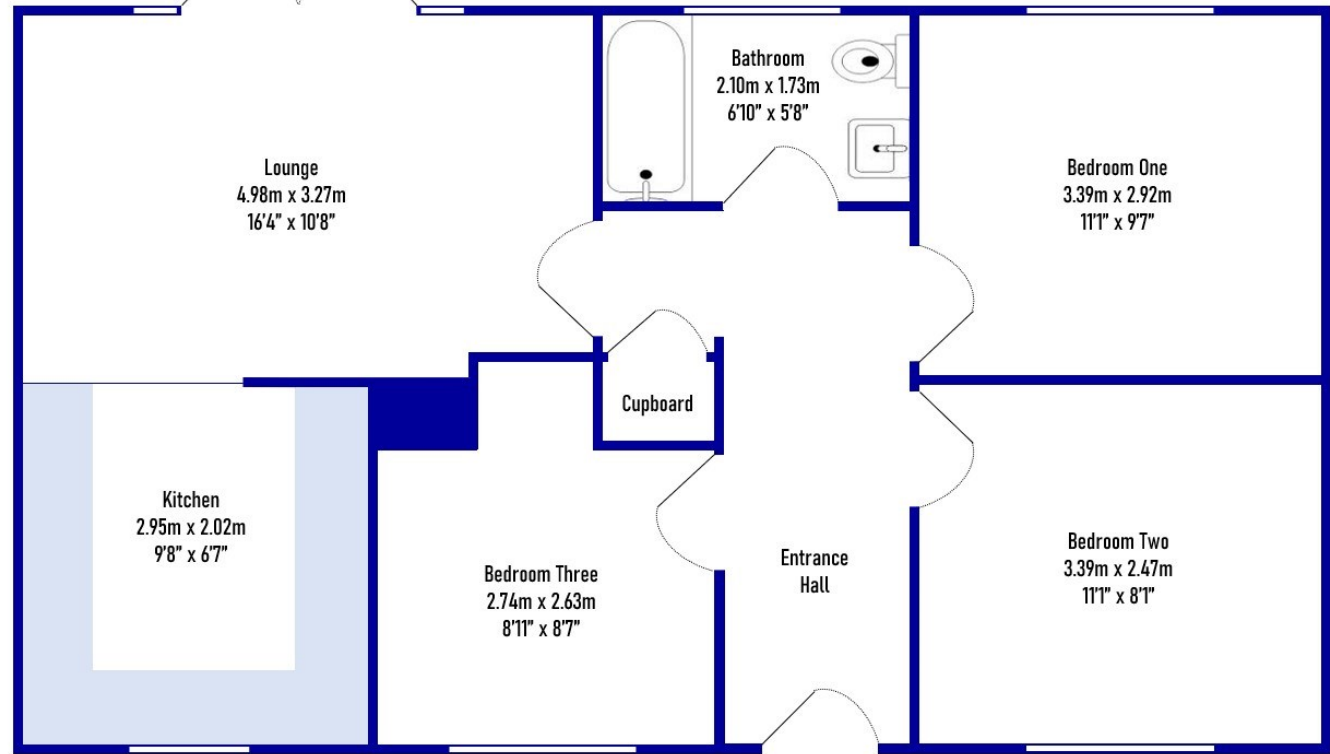

Ground Floor
(60sq m / 645 sq ft)

Whilst every attempt has been made by Complete Property Services to ensure the accuracy of the floorplan contained here, measurements of doors, windows, rooms and any other items are approximate, and no responsibility is taken for any error, omission or mis-statement. The services, systems and appliances shown have not been tested and no guarantee as to their operability or efficiency can be given.