



7 Kingfisher Drive, Maidenhead, Berkshire, SL6 8EL

7 KINGFISHER DRIVE, Maidenhead, Berkshire SL6 8EL

Price £579,950 FREEHOLD

An opportunity to acquire this delightful three-bedroom family home, located within this sought after development and conveniently situated for the River Thames, Maidenhead Town Centre and within approx. 0.8 Miles of the Mainline Railway Station (Paddington/Elizabeth Line). The property has recently been re-decorated and provides modern contemporary living featuring a generous living/dining room with direct access leading onto the rear garden and two allocated parking spaces. NO CHAIN.

*ENTRANCE HALL *CLOAKROOM
*LIVING/DINING ROOM *KITCHEN WITH
INTERGRATED APPLIANCES *MAIN BEDROOM
WITH EN-SUITE SHOWER ROOM *TWO FURTHER
BEDROOMS *FAMILY BATHROOM *DOUBLE
GLAZING *GAS HEATING *ENCLOSED REAR
GARDEN *TWO ALLOCATED PARKING SPACES
*RESIDENT COMMUNAL PARK *CONVENIENT
FOR TOWN CENTRE & MAINLINE RAILWAY
STATION (ELIZABETH LINE) *NO CHAIN* EPC
RATING C* COUNCIL TAX BAND E

Annual Service Charge £400



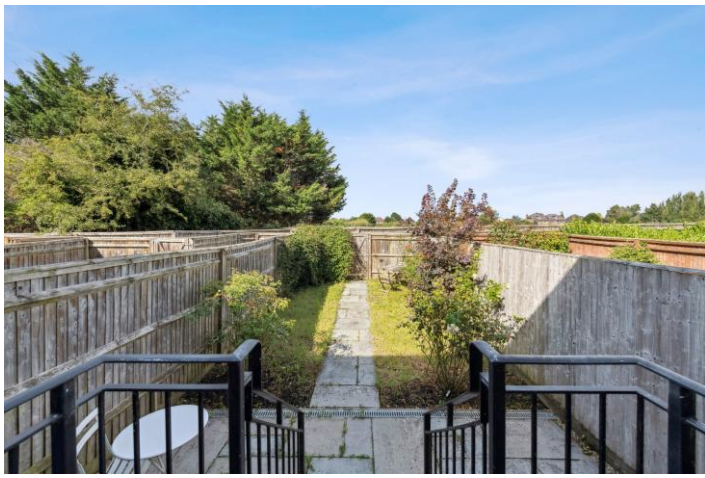
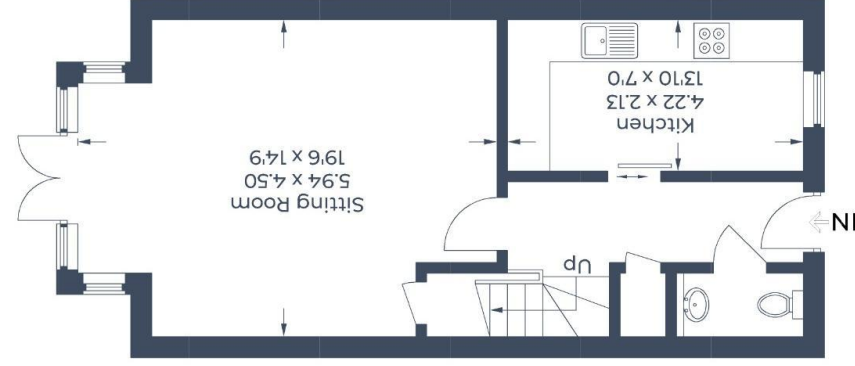
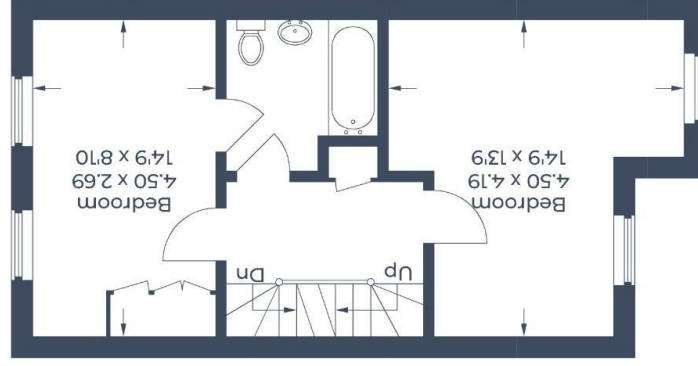

Illustration for identification purposes only,
measurements are approximate, not to scale.
© CJ Property Marketing Produced for Braxton

Ground Floor



First Floor



Second Floor



Approximate Gross Internal Area
Ground Floor = 44.8 sq m / 482 sq ft
First Floor = 39.1 sq m / 421 sq ft
Second Floor = 34.3 sq m / 369 sq ft
Total = 118.2 sq m / 1,272 sq ft