



41 Ely Court, Wroughton

Swindon

Offers Over **£154,000**

mcFarlan
property.co.uk

41 Ely Court

Wroughton, Swindon

Ideally located in the heart of Wroughton in this desirable complex is this two bedroom first floor apartment. Accommodation comprises sitting room, kitchen, two double bedrooms (en-suite to master), and family bathroom together with two allocated parking spaces.

Council Tax band: C

Tenure: Leasehold - 103 years remaining

EPC Energy Efficiency Rating: C

EPC Environmental Impact Rating:





41 Ely Court Wroughton, Swindon

- TWO ALLOCATED PARKING SPACES
- EN-SUITE SHOWER ROOM
- TWO DOUBLE BEDROOMS
- NO ONWARD CHAIN
- GAS CENTRAL HEATING
- FIRST FLOOR APARTMENT



First Floor

Approx. 61.9 sq. metres (666.7 sq. feet)

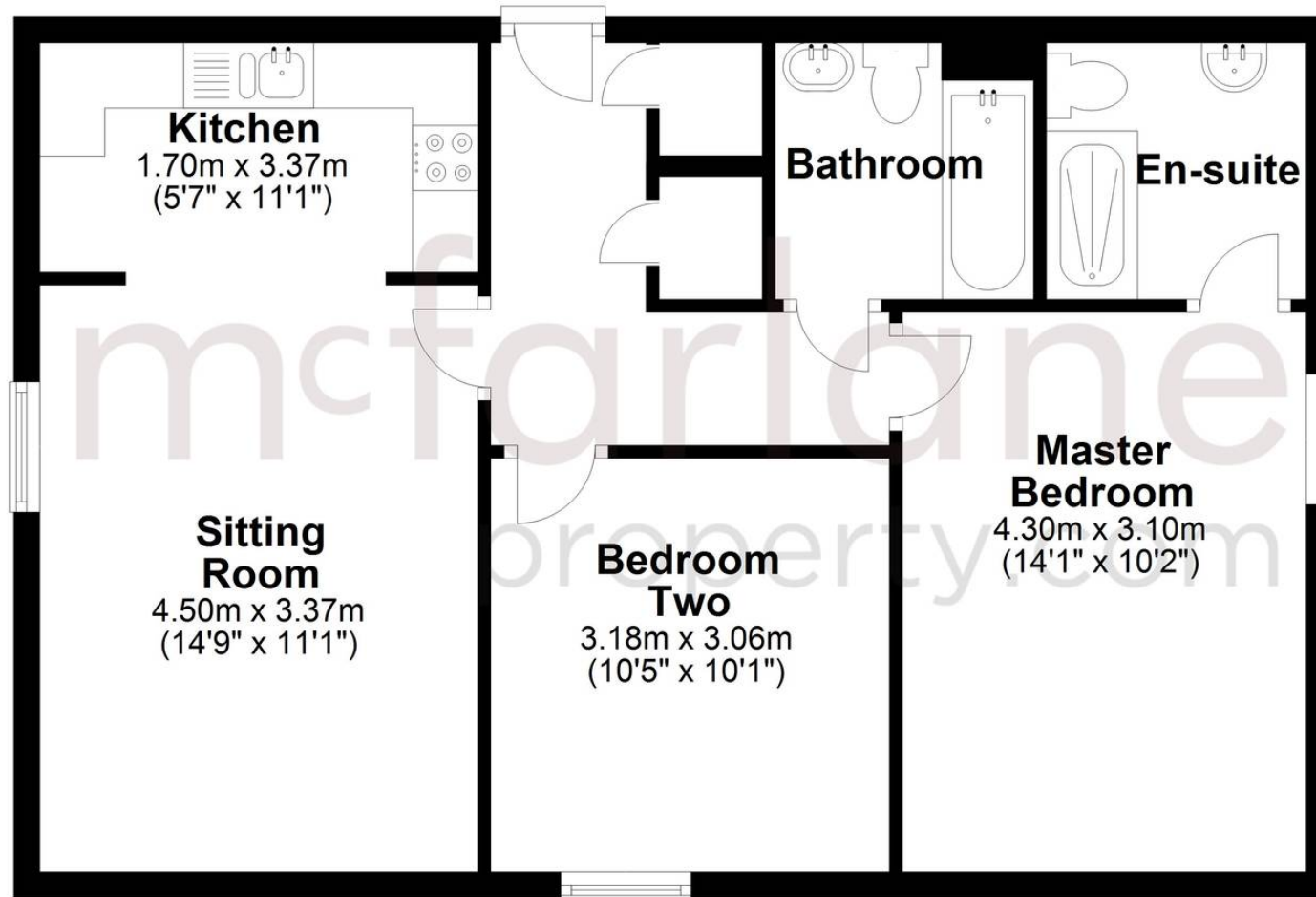

Total area: approx. 61.9 sq. metres (666.7 sq. feet)

McFarlane Sales & Lettings

McFarlane Sales & Letting Ltd, 28-30 Wood Street - SN1 4AB

01793 296880 • oldtown@mcfarlaneproperty.com • www.mcfarlaneproperty.com/

mcfarlane
property.com