

116-120 GOSWELL ROAD

CLERKENWELL, EC1V 7DP

FOREST
REAL ESTATE

TO LET

6,866 SQ FT

Self Contained Office/Showroom Building With Parking & Private Roof Terrace

Key Features

- Fully Self Contained Building
- Large Private Roof Terrace
- Newly Installed Passenger Lift
- Secure Private Car Park
- Cycle Storage
- Air Conditioning
- Shower Facilities
- Excellent Natural Light
- Triple Aspect Double Glazed Windows

116-120 Goswell Road
Clerkenwell, EC1V 7DP





Description

An opportunity to lease a self-contained office/showroom building with extensive frontage, primarily spread across the ground and first floors.

The property features a spacious parking and loading bay area, along with a generously sized roof terrace.

Location

Goswell Road is a prominent business hub in London's bustling Clerkenwell area, offering a dynamic blend of commercial and creative spaces.

Strategically positioned between Farringdon and Angel, this sought-after location boasts excellent transport connections, making it easily accessible from all parts of the city. The area is rich in amenities, with a variety of restaurants, cafes, and shops nearby, catering to the needs of both professionals and visitors. Goswell Road is an ideal choice for businesses seeking a vibrant, well-connected, and thriving environment.

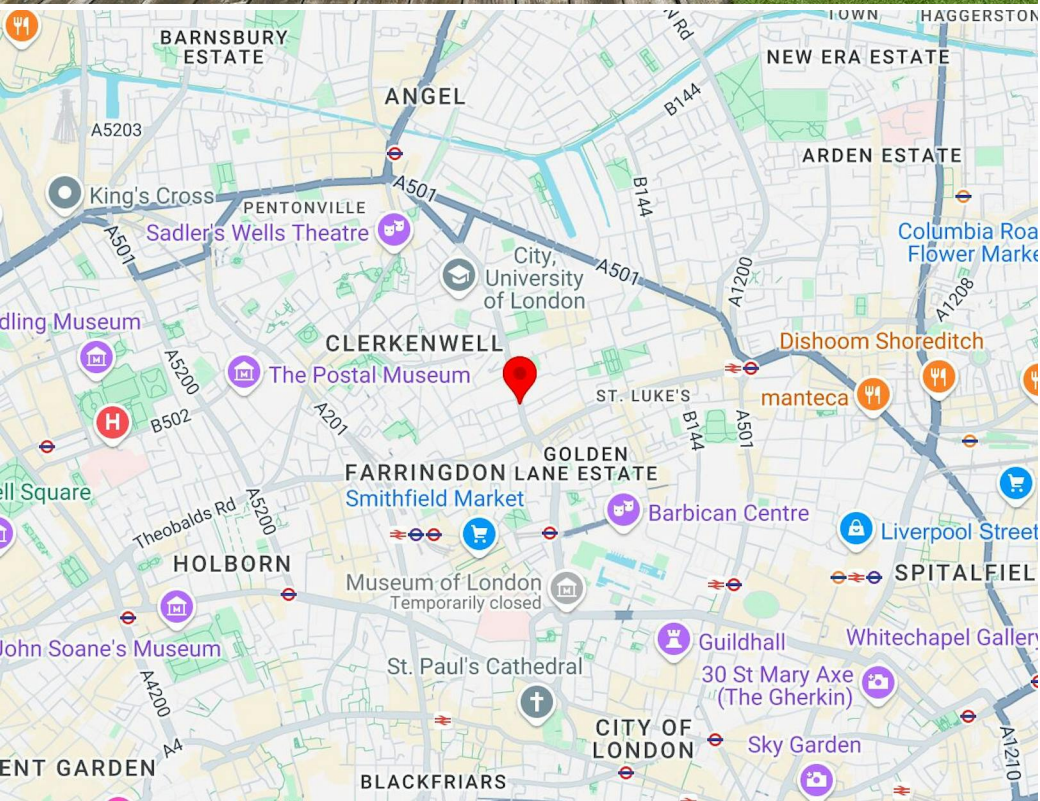

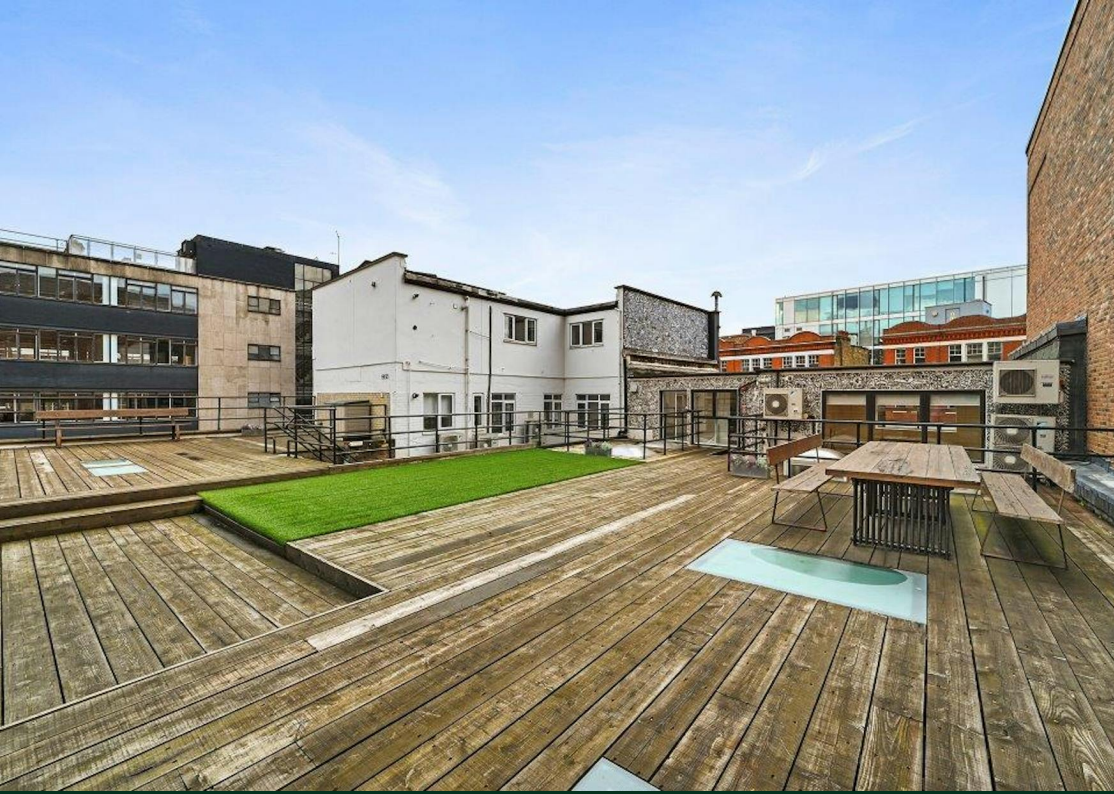

Availability

The accommodation comprises the following areas:

Name	sq ft	sq m
Ground	2,634	244.71
1st	3,371	313.18
2nd	861	79.99
Total	6,866	637.88
Lease	New Lease	
Rent	£57.50 per sq ft	
Rates	Applicants are to make their own enquiries to The London Borough of Islington.	
Service Charge	£6 per sq ft	
VAT	Applicable	
EPC	B (44)	

Contact

Ashley Goodman

020 3370 4470 | 07973 184 329
ashley@forestrealestate.co.uk

Casey Okin

020 3370 4470 | 07391 453 076
casey@forestrealestate.co.uk

London Office Team

55 St John Street, London, EC1M 4AN
020 3370 4470

London Industrial Team

1 Bridge Lane, London, NW11 0EA
020 3355 1555

Hertfordshire Team

1a Local Board Road, Watford, WD17 2JP
01923 911 007

www.forestrealestate.co.uk
info@forestrealestate.co.uk

JOINT AGENTS

Adam Noble (Susskind.)

Ollie Lazarus (Susskind.)

116-120 Goswell Road
Clerkenwell, EC1V 7DP

F O R E S T
REAL ESTATE