



Penn Road, Mill End, Rickmansworth, WD3 8QN

Guide price £500,000 Freehold

sewell &  
gardner



# About the property

This three bedroom semi-detached home is offered to the market providing a perfect opportunity for someone to really make it their own.

Upon entering, the entrance hall leads to the kitchen and living room which leads you to the dining room with doors out to the garden. The bathroom is also located on the ground floor. The property has three bedrooms on the first floor, where the principle bedroom benefits from an ensuite bathroom.

The property features a driveway to the front and also benefits from a garage and private, rear garden.

This property is an excellent opportunity to create your dream home in a prime location. Don't miss the chance to transform this house into a stylish residence tailored to your tastes.



- Three bedroom
- Close to local amenities
- Semi-detached home
- Driveway parking
- Garage
- Close to excellent schools

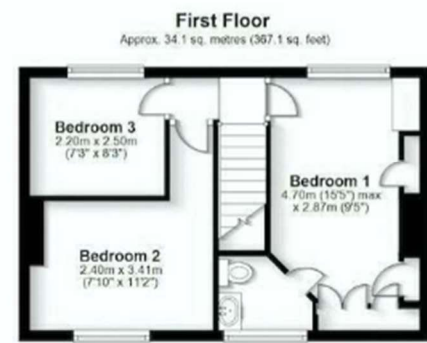

Total area: approx. 99.9 sq. metres (1075.7 sq. feet)

FOR ILLUSTRATIVE PURPOSES ONLY - NOT TO SCALE.  
The position and size of doors, windows, appliances and other features are approximate only. Total area includes garages and outbuildings. - Unauthorised reproduction prohibited.  
Plan produced using PlanUp.

To view this property, contact us on-  
T: 01923 776400 E: ricky@sewellgardner.com  
165-167 High Street, Rickmansworth, WD3 1AY



## Area Information

Rickmansworth has plenty of countryside nearby for walks and cycling but is also close enough to London to offer residents the chance of the hustle and bustle of the big city. One of Rickmansworth's most popular destinations is the 41 hectares of Local Nature Reserve the Aquadrome, with Lakes, woodland, children's play area and the popular Café in the Park. There are plenty of leisure facilities within the area including an array of golf courses, health clubs and swimming pools.

There are multitude of local shops in Rickmansworth including smaller boutiques and larger High Street chains such as Marks & Spencer, WHSmiths, Boots and a large Waitrose. Restaurants such as Zaza's are available as well as gastro pub dining including the Feathers which will offer a more traditional menu. For further retail therapy, the Watford Intu shopping centre is 15 minutes by car.

There are many Good and Outstanding primary, secondary and independent schools in the area such as Arnett Hills JMI, Chorleywood Primary School, Royal Masonic School and Rickmansworth School, making it a desirable area for families.

Local Authority: Three Rivers District Council

Council Tax: C

Approximate floor area: 1,075 sq ft

Tenure: Freehold

Nearest Station: 1.4 miles to Rickmansworth

Distance to Town Centre: 1.3 mile to Rickmansworth

Nearest Motorway: 1.4 miles to M25



Score	Energy rating	Current	Potential
92+	A		
81-91	B		84 B
69-80	C		
55-68	D	61 D	
39-54	E		
21-38	F		
1-20	G		

Every care has been taken to ensure that the details in this brochure represent an accurate description of the property. However, we wish to inform prospective purchasers that these sales particulars are a general guide and none of the statements or dimensions should be relied upon as statements of representation or fact. Transparency of referral fees: We're legally required to inform you that we receive referral income from the following solicitors and surveyors up to the value of £150.00 per transaction; Archer Rusby Solicitors LLP, Taylor Walton Solicitors, Hanney Dawkins & Jones Solicitors, The Partnership, & Woodward Surveyors. For financial services we recommend Severn Financial and one of our directors does have a vested interest in the business. We take an average referral fee of £90. We recommend these companies because we believe they offer an excellent service, however, you are not under any obligation to use them.

sewell &  
gardner