



**The Mews, Lydiard Millicent – SN5 3NQ**

Wiltshire

Offers in Excess of **£600,000**

**mcfarlane**  
property.com

# The Mews Lydiard Millicent

Lydiard Millicent, Swindon

Expansive Detached Four Bedroom Bungalow in a sought after Lydiard Millicent location. Accommodation comprises: Entrance Hallway, Living Room, Dining Area, Kitchen Breakfast Room, Utility, Cloakroom. Four Double Bedrooms and a Family Bathroom, Off Road Parking for Multiple Vehicles.

- Detached Bungalow in Sought After Village Position
- Expansive Detached Bungalow
- Generous Plot With Mature Gardens
- Bright and Airy Accommodation
- Living Room PLUS Conservatory
- Kitchen Breakfast Room PLUS Utility
- FOUR Double Bedrooms



# The Mews - Lydiard Millicent

Lydiard Millicent, Swindon

Lydiard Millicent is a village and civil parish in Wiltshire and lies about 3.5 miles (6 km) West of the larger neighboring Town of Swindon with its plethora of amenities, mainline rail and transport networks.

Council Tax band: E

Tenure: Freehold



**m<sup>c</sup>farlane**  
property.com



## Ground Floor

Approx. 166.9 sq. metres (1797.0 sq. feet)

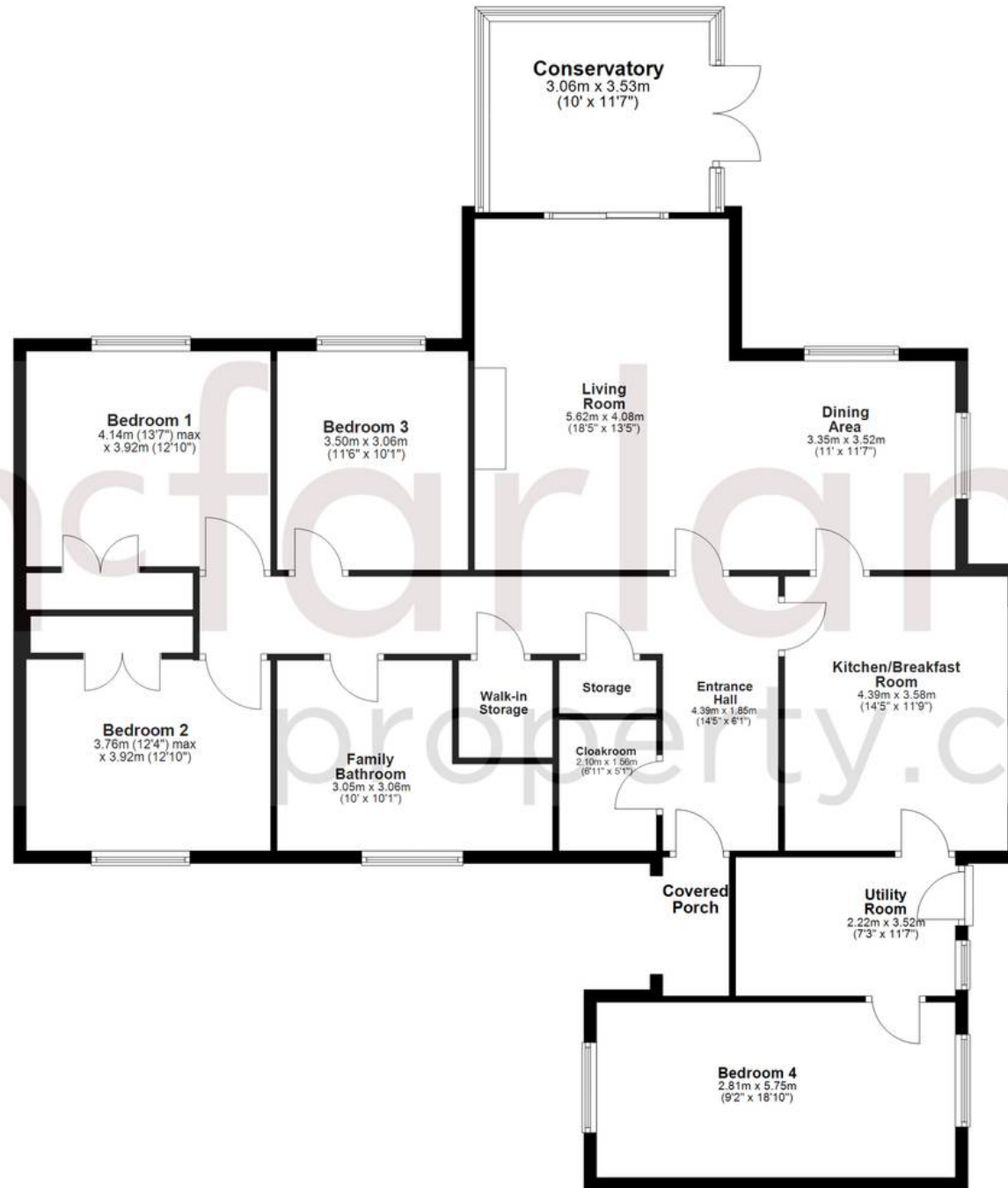

Total area: approx. 166.9 sq. metres (1797.0 sq. feet)

Agents Note: Whilst every care has been taken to prepare these sales particulars, they are for guidance purposes only. All measurements are approximate and for general guidance purposes only and whilst every care has been taken to ensure their accuracy, they should not be relied upon and potential buyers are advised to recheck the measurements.