

White Building - Gym Space, 11 Evesham Street, Notting Hill, W11 4AJ

A self-contained ground-floor gym space is available to let in Notting Dale.



- Self Contained Entrance
- Existing Shower and Changing Facilities
- Excellent Ceiling Heights
- BREEAM rating 'Very Good'
- CCTV
- Secure Cycle Parking

Leisure

TO LET

6,084 sq ft

(565.22 sq m)

White Building - Gym Space, 11 Evesham Street, Notting Hill, W11 4AJ

Summary

Available Size	6,084 sq ft
Rent	£25 per sq ft
Business Rates	Upon Enquiry
EPC Rating	Upon enquiry

Description

The White Building, part of the Notting Dale Estate, has a ground self-contained ground-floor gym unit available to let, already fitted with changing and shower facilities. Totalling 6,250 sq ft this provides a rare opportunity to lease a gym in the heart of the Notting Dale creative campus.

Location

Office to let in Notting Dale, W11 just to the west of Notting Hill. The building is located a few minutes from Latimer Road Underground Station (Circle, Hammersmith & City Line) and about 10 minutes walk from Shepherds Bush transport interchange (Central and Hammersmith & City Lines, and overground rail services). Westfield shopping centre is also just 10 minutes walk.

Accommodation

The accommodation comprises the following areas:

Name	sq ft	sq m	Availability
Ground - Part Ground	6,250	580.64	Available
Total	6,250	580.64	

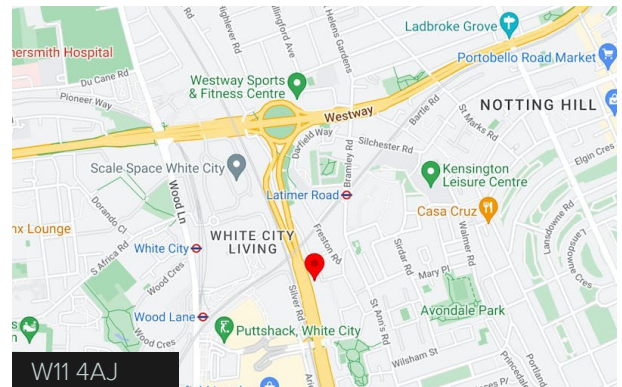
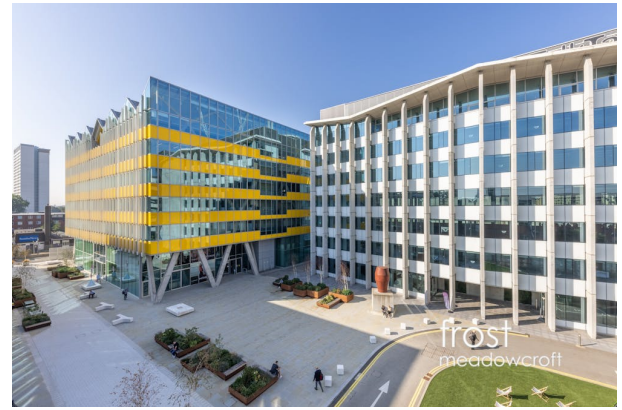

Viewing & Further Information

Simon Kibble

020 8748 1200 | 07774 646 393
skibble@frostmeadowcroft.com

Giles Harker

02087481200 | 07786 001 534
gharker@frostmeadowcroft.com



See more at [frostmeadowcroft.com](https://www.frostmeadowcroft.com)

Misrepresentation Act 1967. These particulars are believed to be correct but their accuracy is not guaranteed and they do not form part of any contract. Unless otherwise stated, all prices and rents are quoted exclusive of VAT. Generated on 10/10/2024