



SALES

LETTINGS

MANAGEMENT

chiswick@tatepartnership.co.uk

020 8996 0000

TATEPARTNERSHIP.CO.UK



The Avenue, Chiswick

£560,000

A well balanced Purpose Built Two Bedroom Apartment, located in the very popular Bedford Park area of Chiswick. Situated on the Third Floor of this Art Deco building (Lift), the accommodation comprises entrance hall, living/dining room, fitted kitchen, two double bedrooms with built-in wardrobes, bathroom with walk in shower. The building has a communal heating and hot water system, the cost of which is included in the annual service charges. Resident Lift. Ormsby Lodge is located on The Avenue, a few minutes walk to Turnham Green Terrace and the wealth of local shopping, dining and transport facilities. For Sale with Full Vacant Possession, Leasehold.

Ormsby Lodge

Approximate Gross Internal Area = 58.4 sq m / 629 sq ft

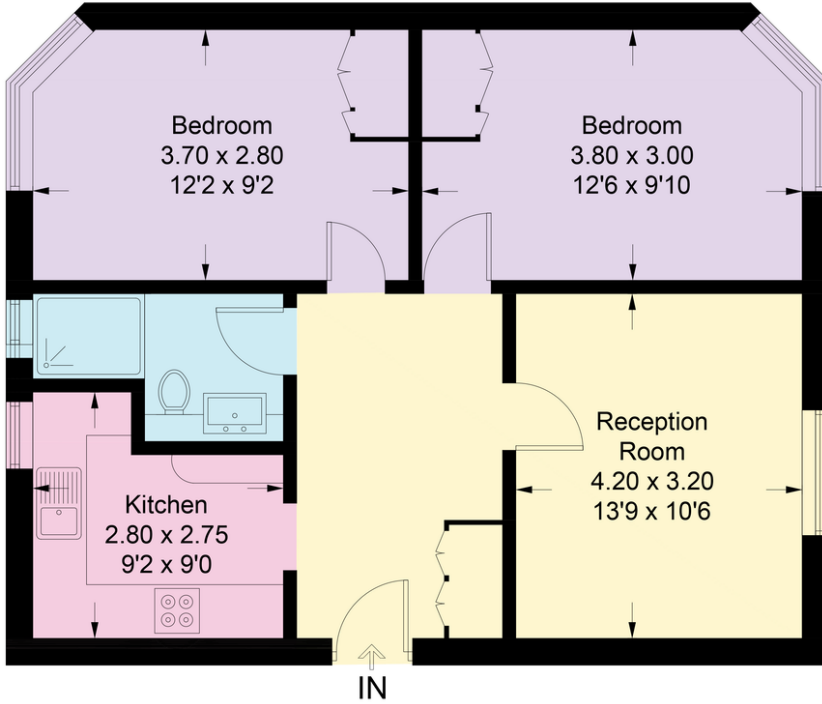

Illustration for identification purposes only, measurements are approximate, not to scale. floorplansUsketch.com © (ID1116246)

EPC

Energy Efficiency Rating		Current	Potential
Very energy efficient - lower running costs			
(92-100) A			
(81-91) B			
(69-80) C			
(55-68) D		65	
(39-54) E			
(21-38) F			
(1-20) G			
Not energy efficient - higher running costs			
England & Wales	EU Directive 2002/91/EC		79

Environmental Impact (CO ₂) Rating		Current	Potential
Very environmentally friendly - lower CO ₂ emissions			
(92-100) A			
(81-91) B			
(69-80) C			
(55-68) D		63	
(39-54) E			
(21-38) F			
(1-20) G			
Not environmentally friendly - higher CO ₂ emissions			
England & Wales	EU Directive 2002/91/EC		82