



Chomlea Manor Claremont Road

Salford



£110,000

Chomlea Manor Claremont Road

Salford

This charming one bed apartment, which has been recently redecorated, features a light-filled living room, fitted kitchen and ample storage. Ideal urban living near amenities and transport links in Salford. Stylish, convenient, and affordable option. Must-see! Council Tax band: A

Tenure: Leasehold

- One Bedroom First Floor Apartment
- Recently Redecorated to a Good Standard
- Light and Spacious Living Room
- Plenty of Storage
- Fitted Kitchen and a Three-Piece Bathroom
- Spacious Double Bedroom
- Shared Parking Available for Residents
- Close to Excellent Transport Links Throughout Manchester, Including into Salford Quays, Media City and Manchester City Centre
- Within Walking Distance of Salford Royal Hospital and Several Well-Kept Parks, Including Buile Hill Park, Light Oaks Park and Oakwood Park
- Viewing is Highly Recommended



Entrance Hallway

A welcoming entrance hallway complete with a ceiling light point, double glazed window and wall mounted radiator. Fitted with laminate flooring.

Vestibule

Featuring fitted furniture. Complete with a ceiling light point and laminate flooring.

Lounge/Diner

18' 0" x 9' 9" (5.48m x 2.98m)

Complete with a ceiling light point, two double glazed windows and wall mounted radiator. Fitted with laminate flooring.

Kitchen

9' 3" x 6' 8" (2.83m x 2.04m)

Featuring complementary fitted units with space for a freestanding oven, fridge freezer and washer. Complete with two ceiling light points and double glazed window.

Bedroom One

10' 11" x 9' 4" (3.32m x 2.85m)

Complete with a ceiling light point, double glazed window and wall mounted radiator. Fitted with carpet flooring.



HILLS



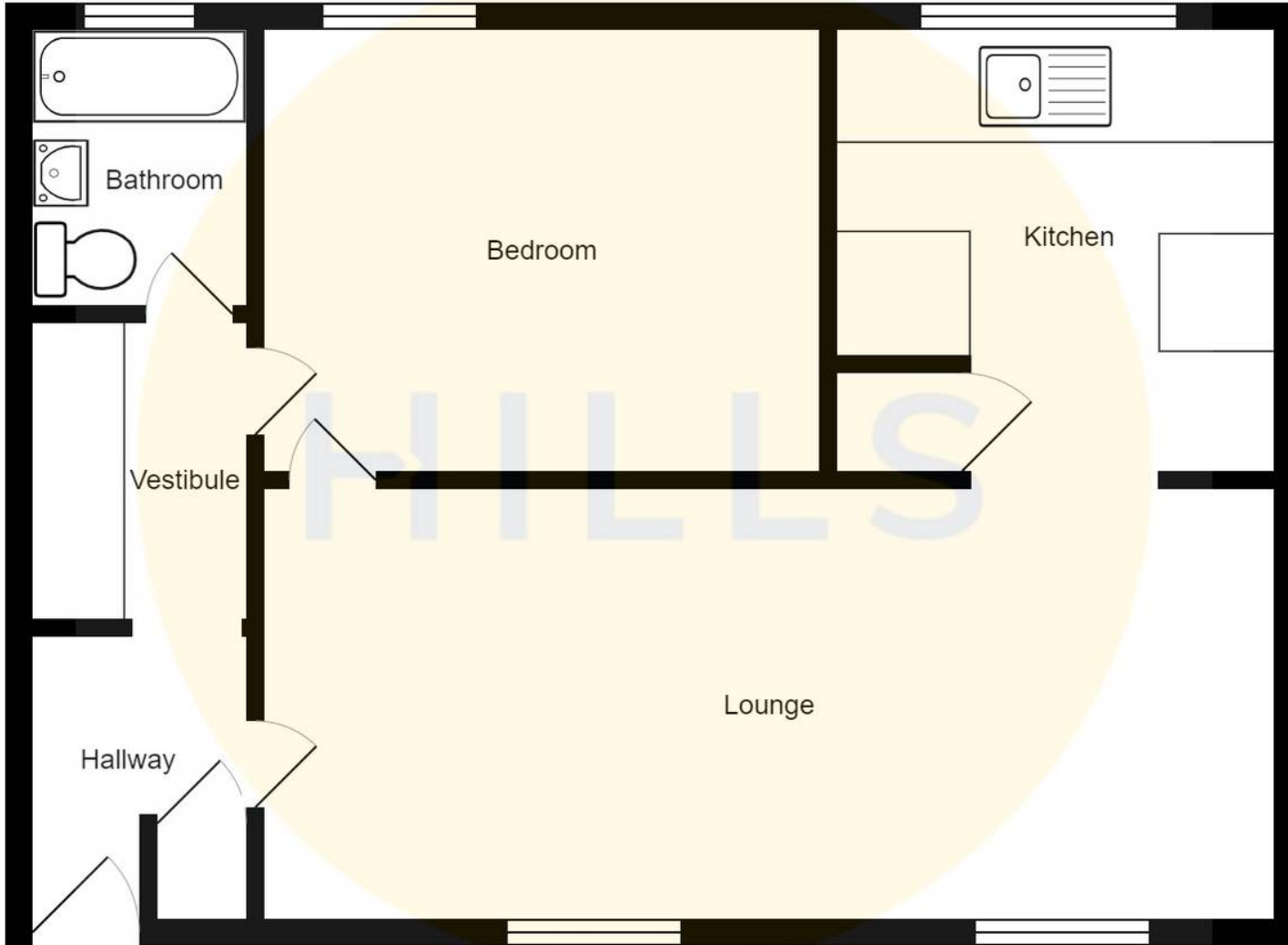



Hills | Salfords Estate Agent

Hills Residential, Sentinel House Albert Street - M30 0SS

0161 707 4900

sales@hills.agency

www.hills.agency/



THE PROPERTY MISDESCRIPTIONS ACT 1991 The Agent has not tested any apparatus, equipment, fixtures and fittings or services and so cannot verify that they are in working order or fit for the purpose. A Buyer is advised to obtain verification from their Solicitor or Surveyor. References to the Tenure of a Property are based on information supplied by the Seller. The Agent has not had sight of the title documents. A Buyer is advised to obtain verification from their Solicitor. You are advised to check the availability of this property before travelling any distance to view. Every effort and precaution has been made to ensure these particulars are correct and not misleading but their accuracy is not guaranteed nor do they form part of any contract. If there is any point which is of particular importance to you, please contact us and we will provide any information you require. This is advisable, particularly if you intend to travel some distance to view the property. The mention of any appliances and services within these details does not imply that they are in full and efficient working order. These particulars are in draft form awaiting Vendors confirmation of their accuracy. These details must therefore be taken as a guide only.