

Marble Square

The Blackthorne 3 bedroom home



Marble Square

The Blackthorne 3 bedroom home

Plot as drawn: 52

79.6 sq.m / 857 sq.ft

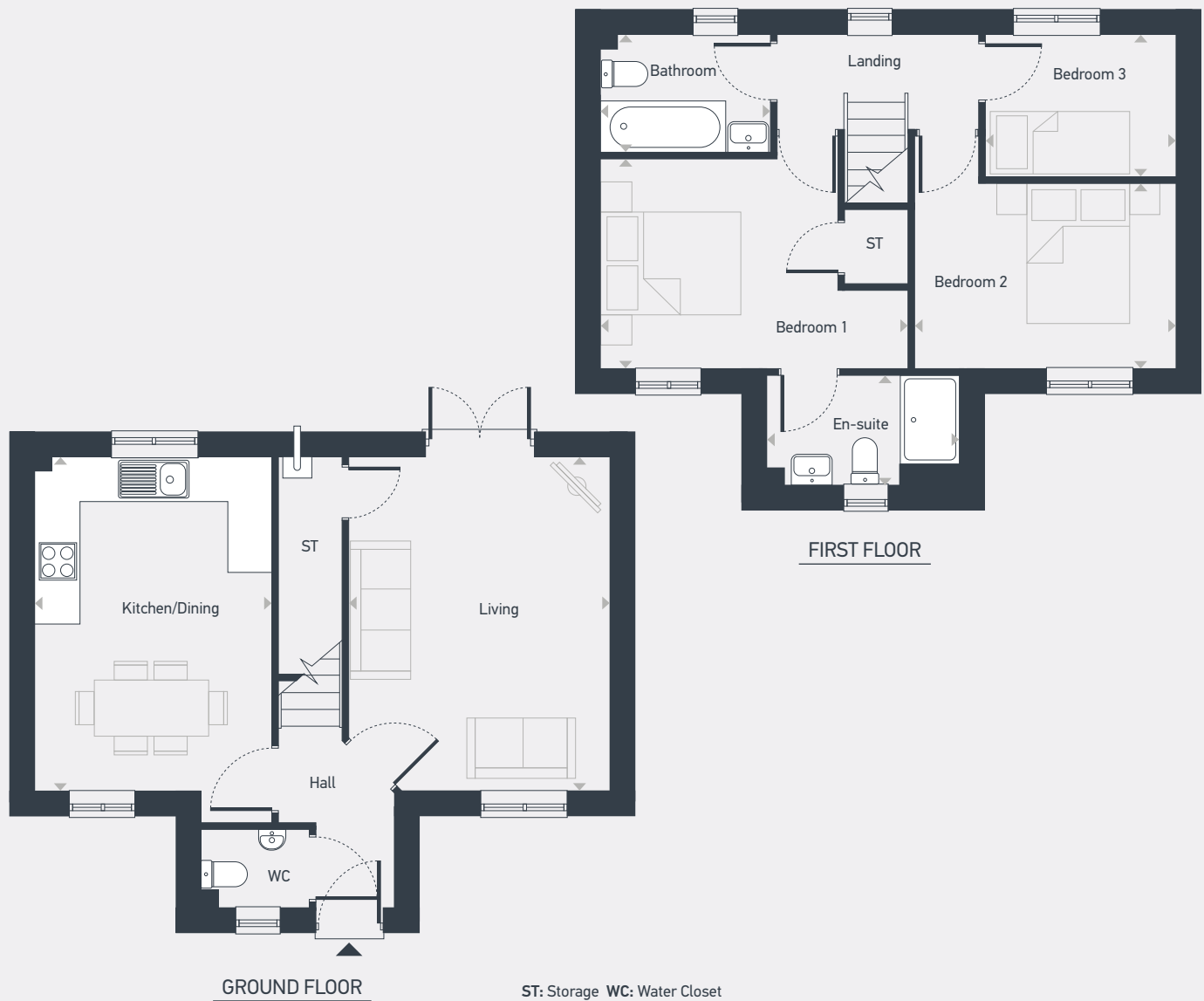

DIMENSIONS	m	ft
Kitchen/Dining	4.51m x 3.20m	14'10" x 10'6"
Living	4.51m x 3.53m	14'10" x 11'7"

DIMENSIONS	m	ft
Bedroom 1	3.20m x 2.83m	10'6" x 9'3"
En-suite	2.61m x 1.48m	8'7" x 4'10"
Bedroom 2	3.53m x 2.50m	11'7" x 8'2"
Bedroom 3	2.57m x 1.92m	8'5" x 6'3"
Bathroom	2.29m x 1.59m	7'6" x 5'2"



07973 813 331 | southyorkshire@slsnewhomes.co.uk | placesforpeople.co.uk/marblesquare
Marble Square, Nightingale Road, Osmaston, Derby DE24 8BF

Please note: All CGIs, layouts and floor plans, configurations, maps and information are intended for guidance only and accuracy of this information cannot be relied upon by prospective purchasers who must make their own enquiries to satisfy themselves by inspection or otherwise as to the correct detail. Sizes and dimensions approximate and subject to change.