



Seymours



Cambridge Road
Sandhurst, GU47 0SX
£240,000

Arrange a viewing: 01276 534100

Property Details

-  2 bedrooms
-  1 baths
-  EPC Rating D
-  571 sqft
-  Sandhurst (1.8 miles)

- NO CHAIN
- Two Double Bedrooms
- New Kitchen
- New Flooring
- Convenient for Local Shops
- Modern Bathroom
- Attractive countryside close by
- Excellent road links close by
- Lots of Storage Space

NO ONWARD CHAIN A beautifully presented and recently modernized ground floor apartment which has had a new kitchen and bathroom fitted as well as modern flooring. The property also benefits from two double bedrooms. There is easy access through to the communal gardens to the front as well as the parking area. It is particularly convenient for day to day living with local shops and amenities in Yeovil Road nearby and a more comprehensive range of a shops at The Meadows and at Camberley as well as beautiful open countryside nearby at Sandhurst memorial park and Snaprails park.

[01276 534100](tel:01276534100) / james@seymours-blackwater.co.uk



Springmead Court

Approximate Gross Internal Area = 53 sq m / 571 sq ft

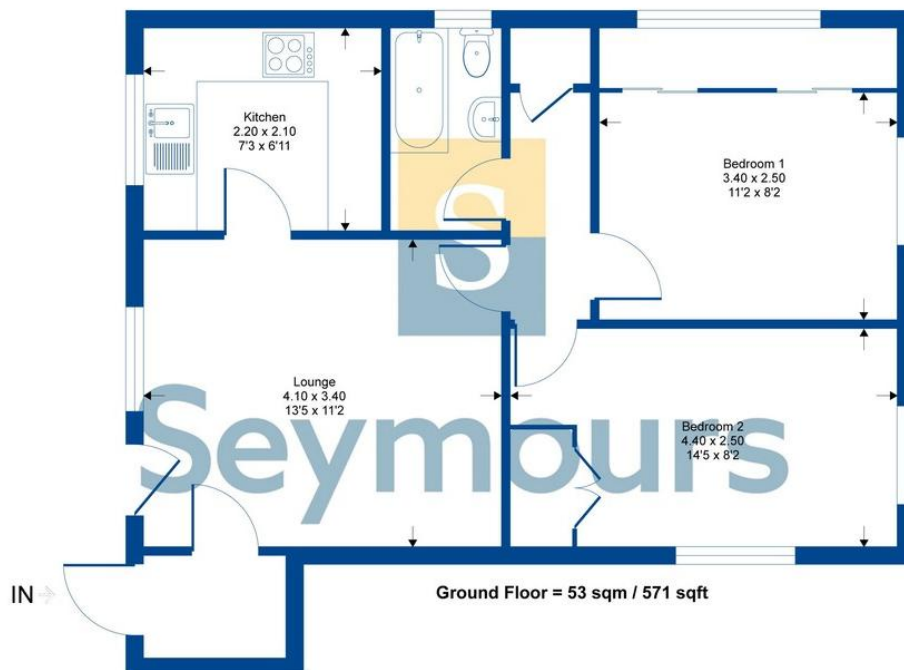

Whilst every attempt has been made to ensure the accuracy of the floor plan contained here, measurements of doors, windows, rooms and any other items are approximate and no responsibility is taken for any error, omission or mis-statement. This plan is for illustrative purposes only and should be used as such by any prospective purchaser.