



25 VINE LANE, ACOCKS GREEN, BIRMINGHAM, B27 6SY

ASKING PRICE OF £155,000





APPROACH The property is approached via, communal door leading to communal hallways and main entrance door, there is a security intercom to access the building.

VESTIBULE HALLWAY Door onto:

HALLWAY Doors to storage, airing cupboard and main accommodation.

MAIN BEDROOM 10' 5" x 13' 1" (3.20m x 4.01m)
Double glazed window, radiator and door onto:

ENSUITE Shower tray with cubicle and shower over, radiator, WC and handwash basin, tiling to splash prone areas.

BEDROOM TWO 8' 2" x 12' 7" (2.49m x 3.85m)
Double glazed window and radiator.

BATHROOM Obscure double glazed window, radiator, panelled bath, low level flush WC, sink encased in vanity unit.

KITCHEN 8' 10" x 9' 3" (2.71m x 2.84m) Double glazed window, a range of wall & base units with work surface over, built in, hob, extractor and oven, tiling to splash back.

LOUNGE 14' 7" x 12' 6" (4.47m x 3.82m) Double glazed window, radiator & wall mounted electric fire.







GROUND FLOOR

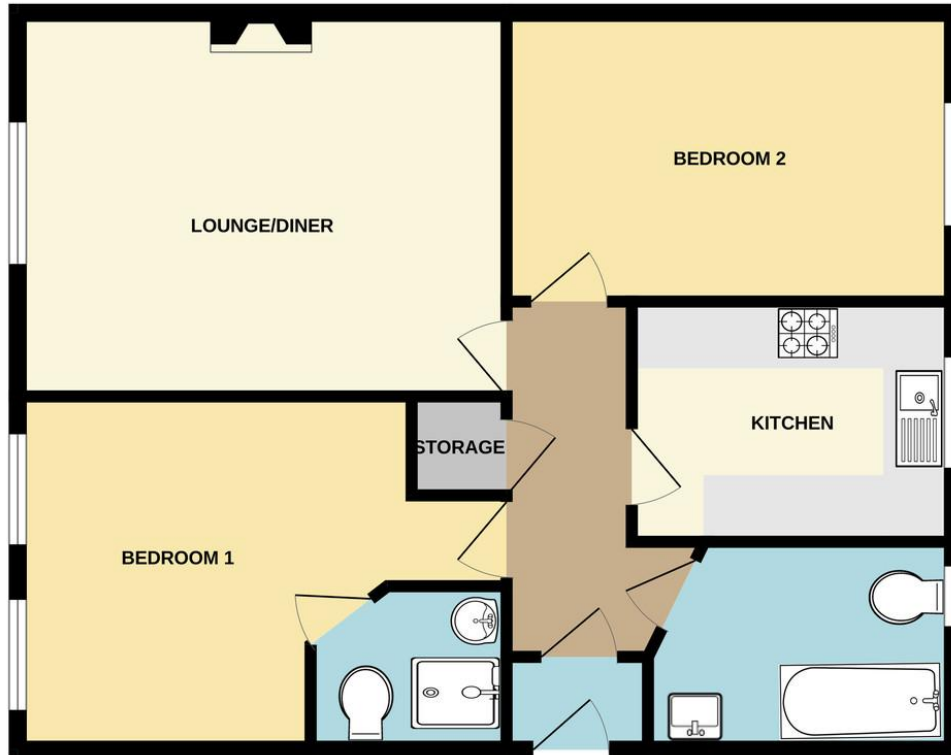

%epcGraph_c_1_381%

57 Warwick Road, Solihull, West
Midlands, B92 7HS

www.encsasagroup.co.uk
info@encsasagroup.co.uk
0121 272 4848

Agents Note: Whilst every care has been taken to prepare these sales particulars, they are for guidance purposes only. All measurements are approximate and for general guidance purposes only and whilst every care has been taken to ensure their accuracy, they should not be relied upon and potential buyers are advised to recheck the measurements.