

1 Bedroom Flat for Sale - £135,000

Vinery Court, Grove Road, Stratford upon Avon, Cv37 6WG



KEY FEATURES

- IDEAL BUY TO LET INVESTMENT • No Chain • 1 Bedroom First Floor Apartment • Allocated Parking • IDEAL FOR FIRST TIME BUYERS • Additional Visitor Parking

Description

****IDEAL BUY TO LET INVESTMENT OR FIRST TIME BUYER PROPERTY****

A one bedroomed first floor flat with parking space situated in Stratford upon Avon town centre.

****NO ONWARD CHAIN****

The property is situated in an ideal town centre location within easy access of the train station, hospital, theatres, shops and restaurants.

The property is accessed via a communal front door with secure entry phone system. Stairs lead to the first floor where the private front door leads to the apartment.

Entrance hall with doors leading to the lounge, bedroom and bathroom.

Lounge

With window to rear and archway to kitchen.

Kitchen

With a range of wall and base units, oven and hob.

Bedroom

A double bedroom with window to rear.

Bathroom

With white suite comprising bath with shower over, WC and basin.

Parking

Allocated parking for one vehicle plus additional visitor parking.

Additional Information

We are informed by the vendor that the property is leasehold with 120 year lease from 1991. We are advised that there is an annual service charge of £875 and an annual ground rent of £150. We have not seen evidence of this and all information should be checked by your solicitor prior to exchange of contracts.

Council Tax Band B with Stratford on Avon District Council



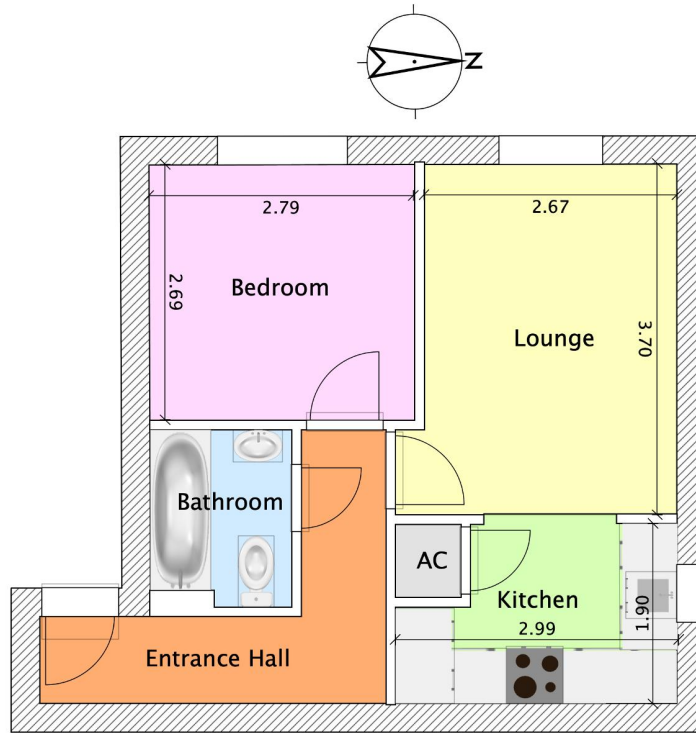

Indicative floor plans for illustration purposes only
 Approximate Gross Internal Floor Area 352ft² / 32.7m²

Energy Efficiency Rating			
Score	Energy rating	Current	Potential
92+	A		
81-91	B	82 B	84 B
69-80	C		
55-68	D		
39-54	E		
21-38	F		
1-20	G		