



Greenwood Close

Sidcup
DA15 9AD

Leasehold

2 bedroom first floor flat
Chain Free
Allocated parking space
Communal grounds
Ideal FTB or investment opportunity

Short walk to Sidcup station and bus routes
Convenient for local shops and M & S Food Hall



Local Authority Bexley London Borough
Council
Council Tax Band C
EPC Rating C

Lease 84 years remaining
Service Charge £1,300 per annum
Ground Rent £800 per annum

Greenwood Close, Sidcup, DA15

Approximate Area = 818 sq ft / 76 sq m
For identification only - Not to scale

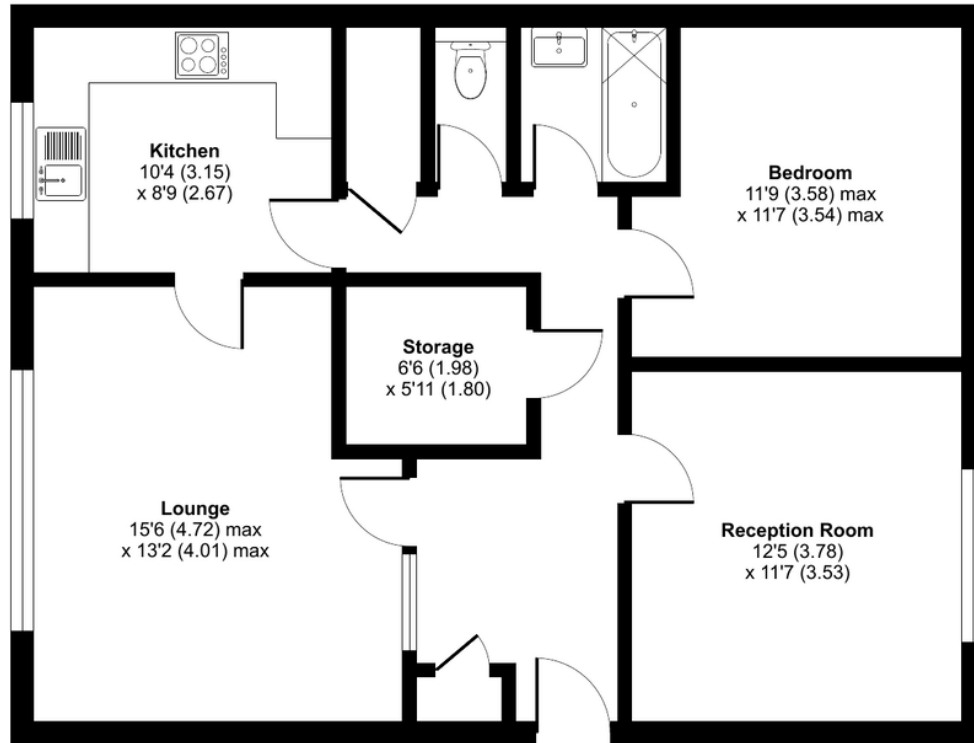

FIRST FLOOR



Drewery Property Consultants
128 Station Road
Sidcup
Kent
DA15 7AF

Contact
020 8269 6605
info@drewery.co.uk
www.drewery.co.uk

Agents Note: Whilst every care has been taken to prepare these particulars, they are for guidance purposes only. All measurements are approximate and are for general guidance purposes only and whilst every care has been taken to ensure their accuracy, they should not be relied upon and potential buyers/tenants are advised to recheck the measurements.