



Fir Tree Avenue, Coventry

Guide Price £280,000

bayzos.



Fir Tree Avenue

Coventry, Coventry

**Sought After Location of Tile Hill 'The Trees' | Close to Local Amenities & Outstanding Schools | EPC Current: 45 Potential: 72 | Approx. Total Floor Area Sq. M. 80 | Driveway Offering Ample Parking | Outside Bar & Office Space | Open Plan Kitchen Diner | Landscaped, Low Maintenance Rear Garden
Council Tax band: C**

Tenure: Freehold

EPC Energy Efficiency Rating: E

EPC Environmental Impact Rating: E



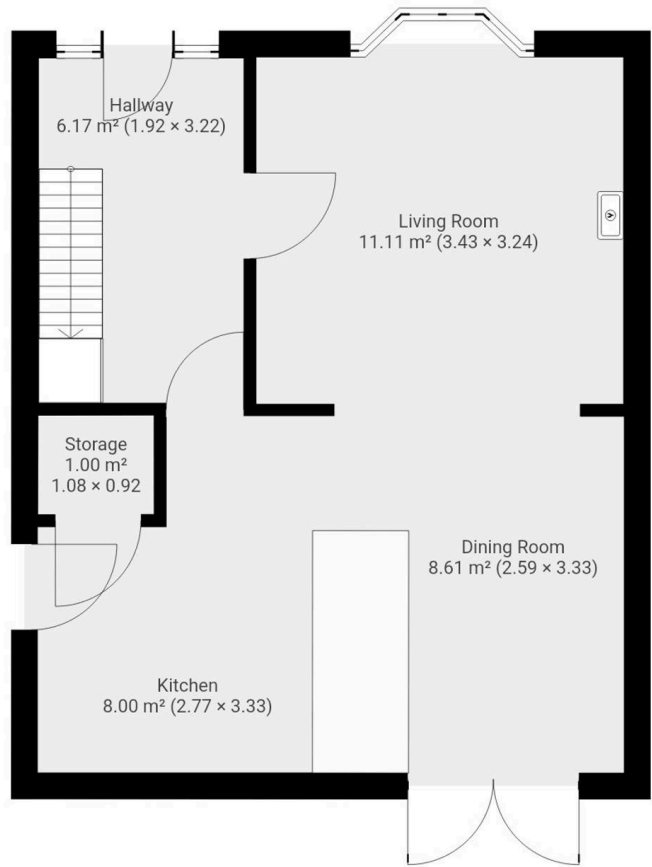

THIS FLOOR PLAN IS PROVIDED WITHOUT WARRANTY OF ANY KIND. SENSOPIA DISCLAIMS ANY WARRANTY INCLUDING, WITHOUT LIMITATION, SATISFACTORY QUALITY OR ACCURACY OF DIMENSIONS.

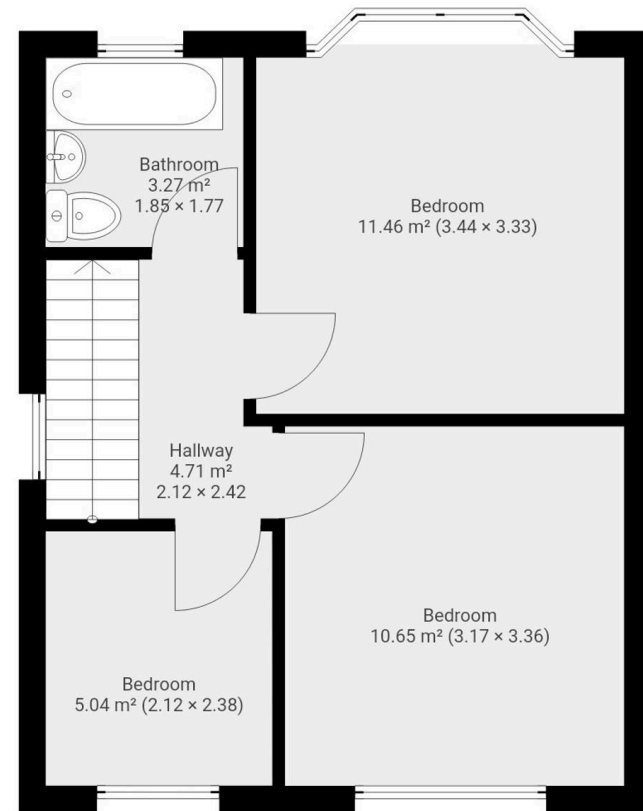

THIS FLOOR PLAN IS PROVIDED WITHOUT WARRANTY OF ANY KIND. SENSOPIA DISCLAIMS ANY WARRANTY INCLUDING, WITHOUT LIMITATION, SATISFACTORY QUALITY OR ACCURACY OF DIMENSIONS.



Bayzos Estate Agents

9 The Square, Kenilworth - CV8 1EF

0330 124 6533 • info@bayzos.co.uk • bayzos.co.uk/

bayzos.